

FLOORPLAN

Borrower: Bruce A & Vivian H Toellner
 Property Address: 66 Stone Springs Cir
 City: The Woodlands

File No.: 28311145

Case No.:

State: TX

Zip: 77381

Sketch

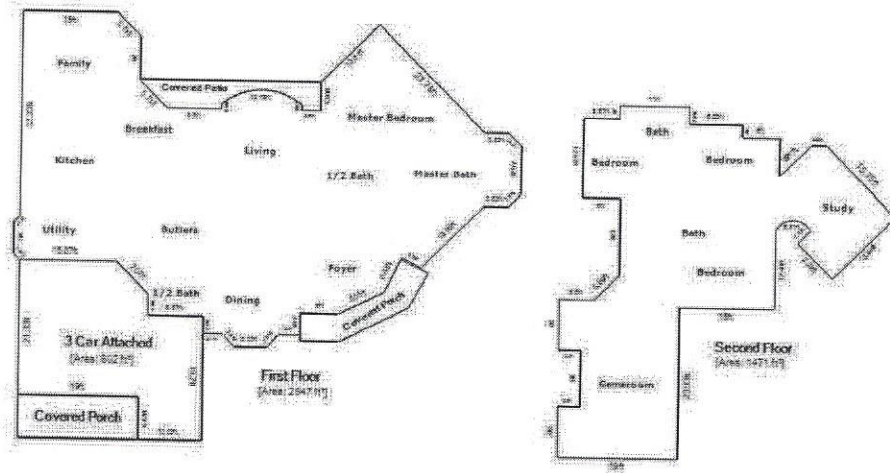

Living Area		Nonliving Area	
First Floor	2846.75 sq ft	Covered Patio	89.93 sq ft
Second Floor	1470.76 sq ft	Covered Porch	83.38 sq ft
		3 Car Attached	501.83 sq ft
		Covered Porch	126.87 sq ft
Total Living Area (rounded):	4317.51 sq ft	Total Non-Living Area (rounded):	802.01 sq ft