

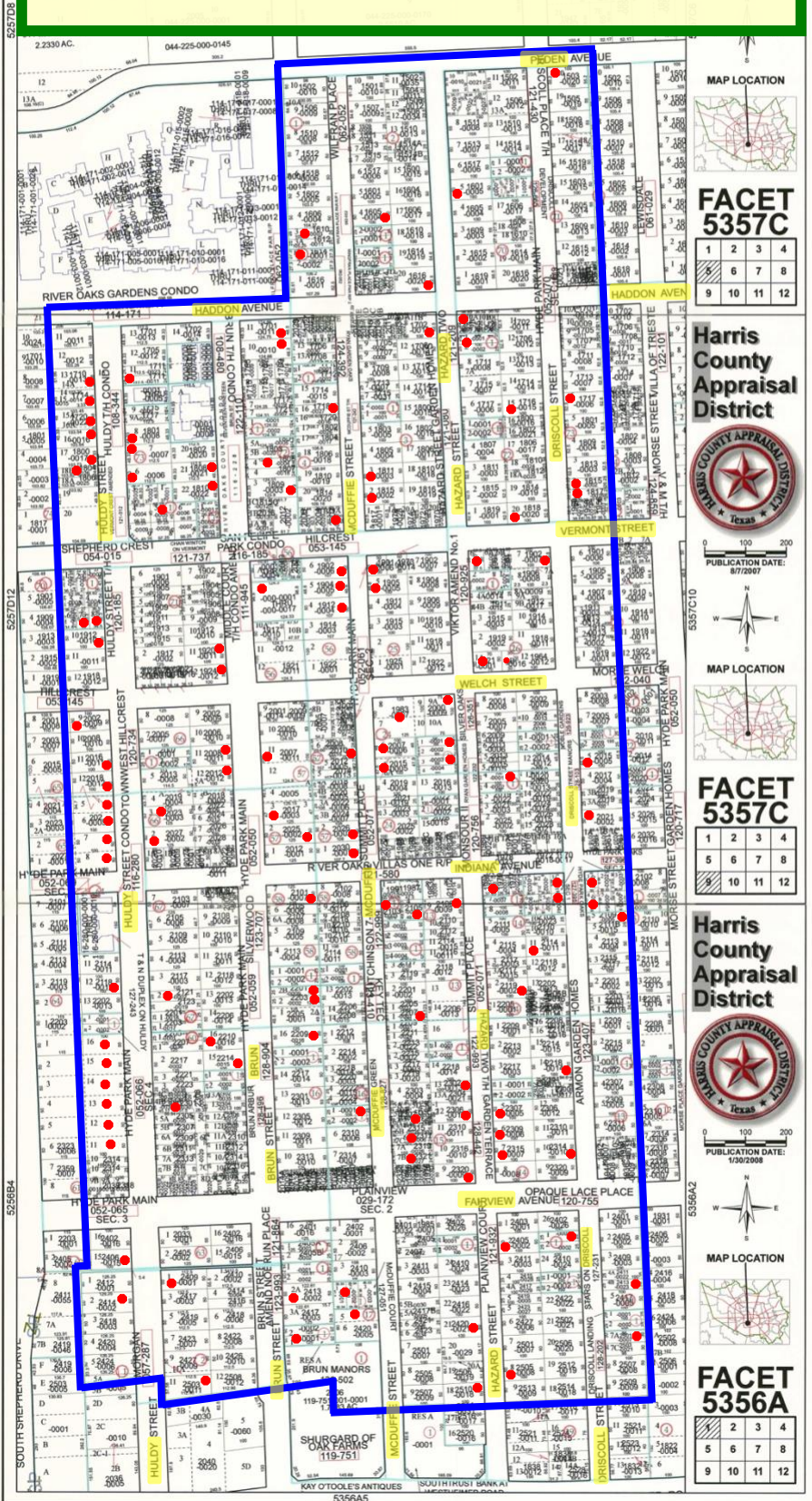

All properties within the blue line are restricted, except for those marked ●

Election out of the restrictions was only possible prior to January 1, 1997 when the restrictions came into force.



MAP LOCATION

**FACET 5357C**

1	2	3	4
5	6	7	8
9	10	11	12

**Harris County Appraisal District**

PUBLICATION DATE: 8/7/2007

MAP LOCATION

**FACET 5357C**

1	2	3	4
5	6	7	8
9	10	11	12

**Harris County Appraisal District**

PUBLICATION DATE: 1/30/2008

MAP LOCATION

**FACET 5356A**

2	3	4
5	6	7
9	10	11

Red circles enclose the Block Number. In this example, the block is #1.

Red rectangles enclose the volume/page from the subdivision maps. In the example above, "Stone Gate" is the subdivision name, "120-472" is the volume/page, and "Sec 8" is the section of the subdivision.

Note: In both examples, the symbol has nothing to do with the individual properties on which they may lie. They are placed for best fit on the map.