

- NOTES:  
 1. BEARINGS AND STREET PER RECORDED PLAT.  
 2. EASEMENT FOR INGRESS AND EGRESS PER HCCF T383342.  
 3. PARTY WALL AGREEMENT PER HCCF T383342.  
 4. HOUSE IS INTO 5'X20' A.E.

LOT 15

THE WEST 37.60' OF LOT 16  
 BLOCK 4

TWO STORY STUCCO

ADJOINING UNITS

PRIVATE DRIVEWAY FOR INGRESS AND EGRESS AND PUBLIC UTILITY ESMT.

LOT 17  
 BLOCK

4

FMD. 5/8" I.R.

FND. 3/4" I.R.

POTOMAC DRIVE  
 (60' R.O.W.)

SURVEY OF  
 BEING THE WEST 37.60' OF LOT 16, BLOCK 4  
 OF WESTHAVEN ESTATES, SECTION 1, RECORDED IN  
 VOLUME 29, PG. 47 OF THE MAP RECORDS OF  
 HARRIS COUNTY, TEXAS.

*John Bernard*

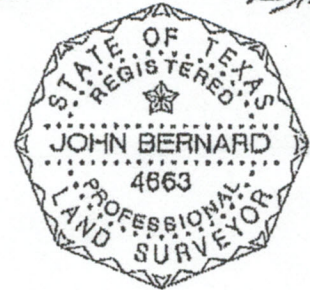

PROPERTY NOT IN THE 100 YEAR FLOOD ZONE, IN ZONE X  
 ACCORDING TO F.I.R.M. MAP NO. 480296 0855 DATE 11-06-96  
 OF GRAPHING PLOTTING ONLY. WE DO NOT ASSUME RESPONSIBILITY FOR EXACT DETERMINATION.

PROPERTY SUBJECT TO SUBDIVISION COVENANTS, CONDITIONS AND RESTRICTIONS.  
 I hereby certify that this survey was made on the ground and that this plat correctly represents  
 the facts found at the time of survey showing any improvements, from legal descriptions supplied  
 by client. There are no encroachments apparent on the ground, except as shown. This survey is  
 certified for boundary and this transaction only. Surveyor did not obstruct property. Easements,  
 building lines, etc. shown are as identified by:

SP 9827265 of COMMONWEALTH LAND TITLE COMPANY

John Bernard, Registered Professional Land Surveyor No. 4603

ADDRESS: 2434 POTOMAC DRIVE  
 CITY: HOUSTON, TEXAS ZIP: 77057  
 PURCHASER: MARGARET E. CARRIERE

LENDER: HOME TRUST