

NOTE: PLAT RECORDED IN VOLUME 32, PAGE 32, FORT BEND COUNTY MAP RECORDS.

LOT DOES NOT LIE WITHIN 100 YEAR FLOOD PLAIN ACCORDING TO THE FEDERAL INSURANCE ADMINISTRATION FLOOD MAP. (ZONE C, PANEL # 480228, DEC. 20, 1977)

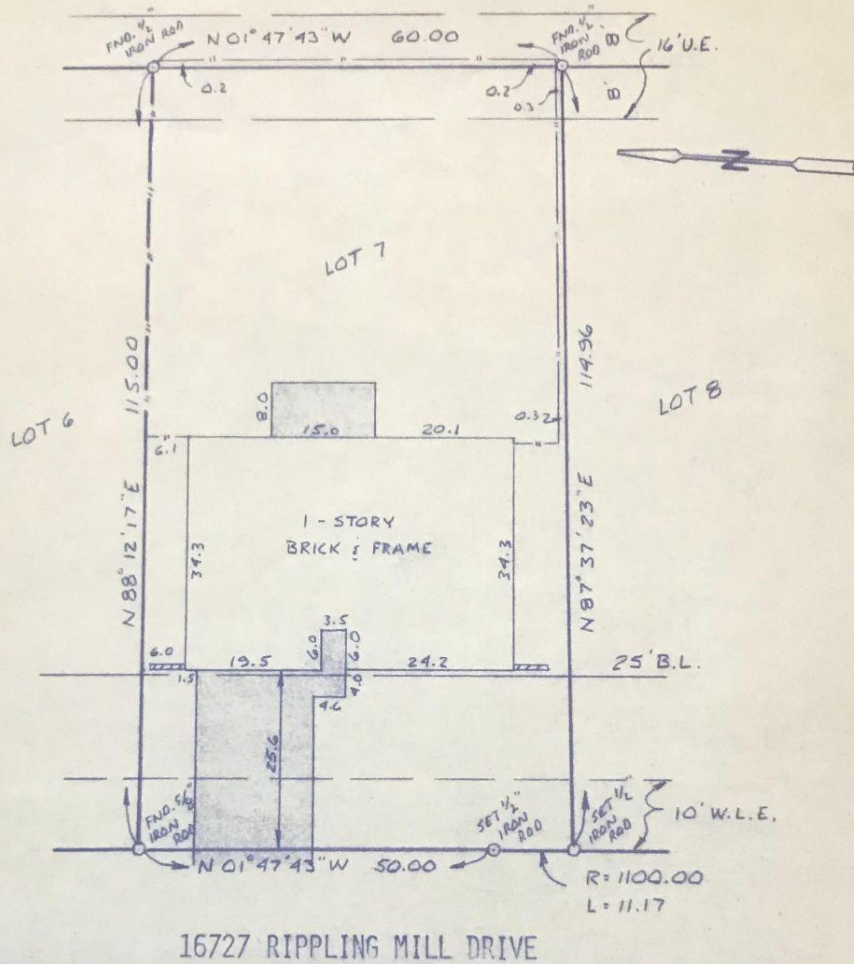

16727 RIPPLING MILL DRIVE

SURVEY

OF LOT 7, BLOCK 8, PHEASANT CREEK, SECTION 1,

FORT BEND COUNTY, TEXAS

SCALE: 1"=20'

DATE: 3-19-86

SURVEY BY: T.S.

DRAWN BY: J.E.B.

FOR: TEXAS AMERICAN TITLE
SW. FWY. GPF 175861135

PURCHASER: ROBERT HARRISON
& MARY JANE HARRISON
JOB NO. 86-12939

I HEREBY CERTIFY THAT THIS SURVEY
CONFORMS TO THE CURRENT TEXAS
SURVEYORS ASSOCIATION STANDARDS
AND SPECIFICATIONS FOR A CATEGORY
1B, CONDITION 3 SURVEY.

Billy L. Shanks

BILLY L. SHANKS
REGISTRATION NO. 1821



SHANKS SURVEYORS

940 GEMINI

488-8305