

FLOORPLAN

Borrower: Mehtab Amin File No.: 08060046
 Property Address: 19922 Juniper Berry Drive Case No.: 493-8748480
 City: Richmond State: TX Zip: 77469
 Lender: Pulte Mortgage, LLC

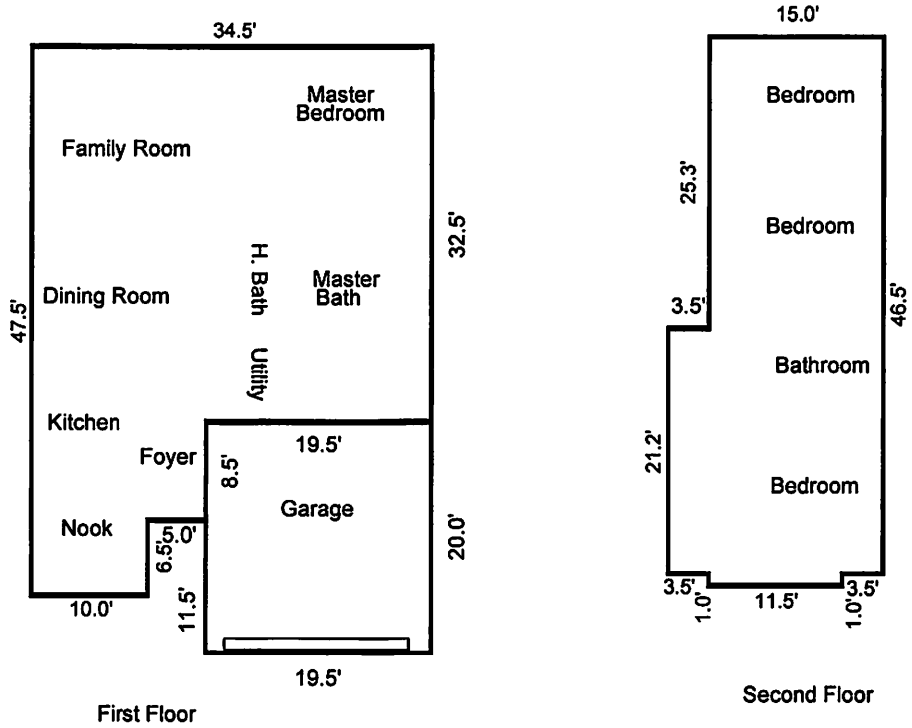

Sketch by Apex IV™
 Comments:

AREA CALCULATIONS SUMMARY			
Code	Description	Size	Net Totals
GLA1	First Floor	1313.75	1313.75
GLA2	Second Floor	783.20	783.20
GAR	Garage	390.00	390.00
TOTAL LIVABLE (rounded)			2097

LIVING AREA BREAKDOWN		
	Breakdown	Subtotals
First Floor		
	15.0 x 41.0	615.00
	6.5 x 10.0	65.00
	19.5 x 32.5	633.75
Second Floor		
	15.0 x 46.5	697.50
	1.0 x 11.5	11.50
	3.5 x 21.2	74.20
6 Calculations Total (rounded)		2097