

SCALE 1" = 20'

WOODVALE STREET
(55' R.O.W.)

LEGEND

| | |
|----------------------|-------------|
| B.L. = BUILDING LINE | |
| CONCRETE | METAL STEPS |
| COVERED AREA | WOOD DECK |
| FENCE | |
| CHAIN LINK | |
| WIRE | |
| WOOD | |

NOTES:

- ALL BEARINGS SHOWN HEREON ARE REFERENCED TO THE SUBDIVISION PLAT NAMED BELOW, POINTS (A) AND (B) WERE HELD FOR HORIZONTAL CONTROL.
- ABSTRACT INFORMATION FOR THE SUBJECT TRACT WAS PROVIDED BY THE TITLE INSURANCE COMPANY LISTED ABOVE.
- THIS SURVEY IS CERTIFIED TO THE TITLE INSURANCE COMPANY LISTED ABOVE FOR THIS TRANSACTION ONLY, IT IS NOT TRANSFERABLE TO ADDITIONAL INSTITUTIONS OR SUBSEQUENT OWNERS.
- ALL EASEMENTS AND BUILDING LINES SHOWN ARE PER THE RECORDED PLAT UNLESS OTHERWISE NOTED.
- THERE ARE NO NATURAL DRAINAGE COURSES ON SUBJECT PROPERTY.
- SUBJECT TO THE RESTRICTIVE COVENANTS AS LISTED IN SCHEDULE B OF THE TITLE COMMITMENT ISSUED ON OCTOBER 12, 2018, UNDER G.F. NO. ATCH18083089.

LEGAL DESCRIPTION: LOT 6, IN BLOCK 6, OF PINEVIEW PLACE, AN ADDITION IN HARRIS COUNTY, TEXAS, ACCORDING TO THE MAP OR PLAT THEREOF RECORDED IN VOLUME 6, PAGE 27, OF THE MAP RECORDS OF HARRIS COUNTY, TEXAS.

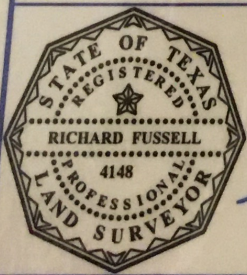

SURVEYOR'S CERTIFICATE:
 IN MY PROFESSIONAL OPINION, THIS PLAT REPRESENTS THE FACTS FOUND ON THE GROUND DURING THE COURSE OF A BOUNDARY SURVEY CONDUCTED UNDER MY SUPERVISION ON OCTOBER 17, 2018 AND THAT THIS PLAT SUBSTANTIALLY COMPLIES WITH THE CURRENT STANDARDS AS ADOPTED BY THE TEXAS BOARD OF PROFESSIONAL LAND SURVEYING, AND THAT THERE ARE NO ENCROACHMENTS OR PROTRUSIONS EXCEPT AS SHOWN.

Richard Fussell
 RICHARD FUSSELL
 RPLSA/4148

CLIENT: MARGARET BELMONTES

ADDRESS: 123 BEDFORD STREET

www.survey1inc.com
 survey1@survey1inc.com

Survey 1, Inc.
 Your Land Survey Company

Firm Registration No. 100758-00
 P.O. Box 2543 | Alvin, TX 77512 | (281)393-1382

| | |
|--------------------------|---------------------------|
| FIELD CREW: BM | TECH: SF |
| DRAFTER: LT | FINAL CHECK: BC |
| DATE: 10-18-18 | |
| JOB#: 10-67621-18 | |