

- NOTES:
- 1) # DENOTES WOOD FENCE.
 - 2) SUBJECT TO RESTRICTIVE COVENANTS BY VOL. 18, PG. 19, H.C.M.R. & VOL. 1219, PG. 587, VOL. 1196, PG. 332, VOL. 1232, PG. 10, & VOL. 1240, PG. 407, H.C.D.R. & H.C.C.F. Nos. J 848906, K 039820 & K 898549.
 - 3) S' UTILITY ESMT BY VOL. 1219, PG. 587, H.C.D.R.
 - 4) BLDG LINE RESTRICTIONS, BY VOL. 1219, PG. 587, H.C.D.R.

Marta L. Fuentes 1/2/14
Paul 1/2/14

ALL BEARINGS BASED ON RECORDED PLAT. FLOOD ZONE DETERMINED BY GRAPHIC PLOTTING ONLY. WE DO NOT ASSUME RESPONSIBILITY FOR EXACT DETERMINATION. THIS SURVEY HAS BEEN COMPILED IN ACCORDANCE WITH INFORMATION CONTAINED IN THE TITLE COMMITMENT REFERENCED IN GF NO. 98020147.

T	1	BLOCK	8	SECTION	2	SUBDIVISION	HOUSTON COUNTRY CLUB PLACE	This lot DOES NOT lie in the 100 year flood plan and is in ZONE "X" as located by the Federal Insurance Administration Designated Flood Hazard Area by Community Panel No. 480296 0880J dated 11-06-96
RECORDATION	VOL. 18, PG. 19, H.C.M.R.		COUNTY	HARRIS	STATE	TEXAS	SURVEY	
LENDER	WORLD SAVINGS & LOAN ASSOCIATION		TITLE CO.		HOUSTON TITLE COMPANY			JOB NO. 23743 K
PURCHASER	MARTHA L. FUENTES							
ADDRESS	6402 BROOKSIDE DRIVE, HOUSTON, TEXAS							

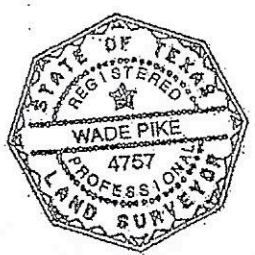
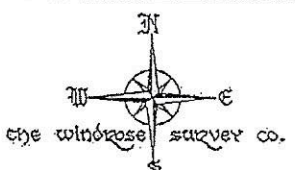

I do hereby certify that this survey was this day made on the ground and that this plat correctly represents the property legally described hereon (or on attached sheet). That the facts found at the time of this survey show the improvements and that there are no encroachments apparent on the ground, except as shown.

Wade Pike

FIELD WORK	05-06-98	DT
DRAFTED BY	05-06-98	UN
CHECKED BY	05-06-98	WP
KEY MAP NO.	4947	

THE WINDROSE SURVEY COMPANY
 11301 Richmond, Suite K105
 Houston, Texas 77082
 (281) 558-8006