

NOTE:
 1. HL&P AGREEMENT FILED PER HCCP #'S C803189, C925078 & D015334.

PLAT OF LOT 22 BLOCK 7 OF BROOKGLEN, SECTION 1
 ACCORDING TO THE PLAT RECORDED IN VOLUME 153, PAGE 99 OF
 THE MAP RECORDS OF HARRIS COUNTY, TEXAS

PROPERTY IS IN THE 100 YEAR FLOOD ZONE, IN ZONE AE
 ACCORDING TO F.I.R.M. MAP NO. 48201C 0940J, DATE 11-6-96
 BY GRAPHING PLOTTING ONLY, WE DO NOT ASSUME RESPONSIBILITY FOR EXACT DETERMINATION.

PROPERTY SUBJECT TO SUBDIVISION COVENANTS, CONDITIONS AND RESTRICTIONS.
 I hereby certify that this survey was made on the ground and that this plat correctly represents
 the facts found at the time of survey showing any improvements, from legal descriptions supplied
 by client. There are no encroachments apparent on the ground, except as shown. This survey is
 only certified for boundary and this transaction only. Surveyor did not abstract property. Easements,
 building lines, etc. shown are as identified by:

GF 326198 of FIRST AMERICAN TITLE COMPANY

This survey is being provided solely
 for the use of the current parties
 and that no license has been created,
 express or implied, to copy the survey
 except as is necessary in conjunction
 with the original transaction.

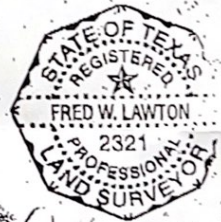

ADDRESS: 8518 AVINGTON CITY: LAPORTE ZIP: 77571 LENDER:
 PURCHASER: ALBERTO B. CASTILLO
 JOB NO: 0198-00 DATE: 01-29-04 SCALE: 1:20 REVISION: Key Map



SOUTH TEXAS SURVEYING ASSOCIATES, INC.
 11281 Richmond Ave. Suite J-101 Houston, Texas 77082
 TEL. (281) 556-6918 FAX (281) 556-9331
 COPYRIGHT 2003