

ADDRESS: 7710 LITTLE THICKET COURT



LEGEND

IRON ROD	U.E.	COVERED AREA
UTILITY EASEMENT	B.L.	CONCRETE
RAILING LINE	A.C.	WOOD
SEAL EASEMENT		
WOOD FENCE		
WIRE FENCE		
CHAIN LINK FENCE		



GREENHOUSE ROAD (100' R/W)

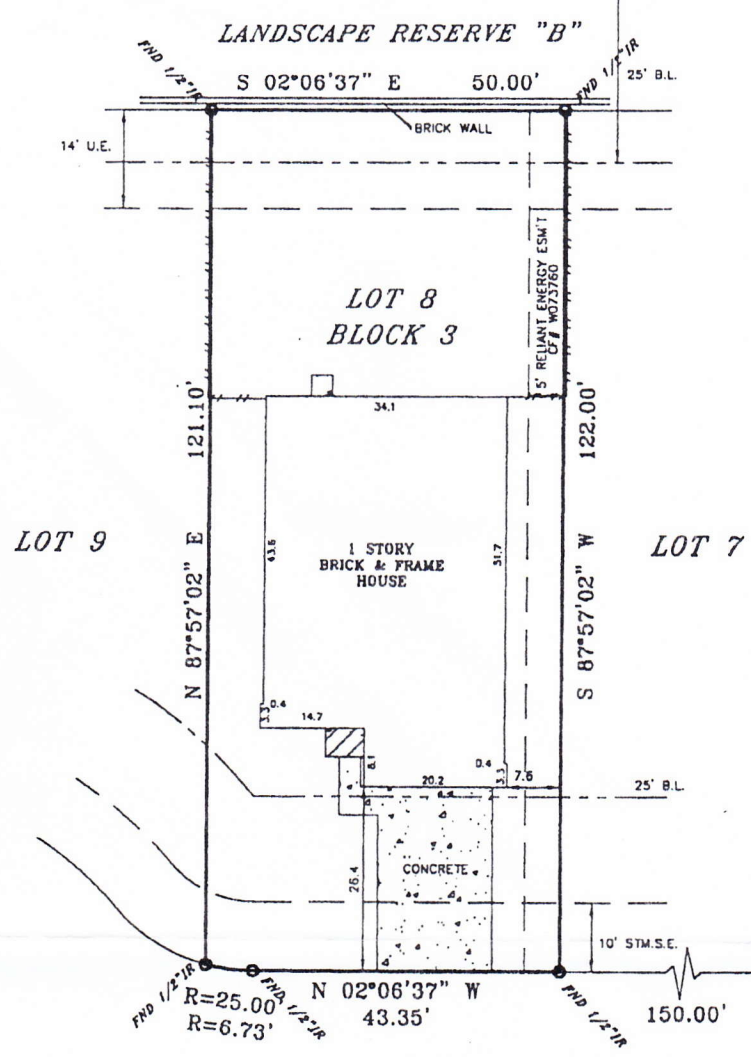

7710 LITTLE THICKET COURT (50' R/W)

LEGAL DESCRIPTION
 Lot Eight (8), in Block Three (3), of YAUPON RANCH, SECTION ONE (1), an addition in Harris County, Texas, according to the map or plat thereof recorded under Film Code No. 518176 of the Map Records of Harris County, Texas.

THIS PROPERTY IS SUBJECT TO THE FOLLOWING:
 RESTRICTIONS - FC# 518176 HCMR AND CF#S W216520, W860834, 860836, Y911879, Z062399, Z519496, 20100296484, 20110265303, 20120126051 AND 20120212443.
 AGREEMENT WITH RELIANT ENERGY PER CF# W127050.



ELEVATION EXPRESS LAND SURVEYS
 WWW.ELEVATIONEXPRESSLANDSURVEYS.COM
 1450 W. GRAND PARKWAY SOUTH
 SUITE G-158
 KATY, TX 77494
 281-474-5683



I DO HEREBY CERTIFY THAT THIS SURVEY WAS THIS DAY MADE ON THE GROUND OF THE PROPERTY LEGALLY DESCRIBED HEREON, IS CORRECT AND THERE ARE NO ENCROACHMENTS EXCEPT SHOWN, AS WAS DONE BY ME OR UNDER MY SUPERVISION, AND CONFORMS TO OR EXCEEDS THE CURRENT STANDARDS AS ADOPTED BY THE TEXAS BOARD OF PROFESSIONAL LAND SURVEYING.

BUYER: NATASHA BRYANT
 JOB#: 1303002
 GFA: ATH-17-ATH130286653MB
 DATE: 3-4-2013

ALL BEARINGS ARE BASED ON THIS MAP OR PLAT OF RECORDS IF THE SUBJECT PROPERTIES LIE IN A RECORDED SUBDIVISION OF SAID COUNTY.
 THIS SURVEY IS CERTIFIED FOR THE TRANSACTION ONLY. IT IS NOT TRANSFERABLE TO ADDITIONAL PURCHASERS OR SUBSEQUENT OWNERS.
 SUBJECT TO ANY AND ALL RECORDED AND UNRECORDED EASEMENTS, DEEDS, RESTRICTIONS OR BUILDING LINES THAT MAY APPLY TO SUBJECT PROPERTY.

Any reference to the 100 year flood plain or flood hazard zones are an estimate based on the data shown on the Flood Insurance Rate Map provided by FEMA and should not be interpreted as a study or determination of the flooding propensities of this property. According to the Flood Insurance Rate Map for HARRIS COUNTY, Dated JUNE 19, 2007, Map No. 4870C DMS L, the property described lies within "ZONE X" outside the 500 yr. Flood. Flood information is based on graphic plotting only due to inherent inaccuracies on FEMA maps, we can not assume responsibility for exact determination.