

ELIJAH COLLARD SURVEY A-7

TRACT ONE:
BEING a 1.179 acre tract of land siting in the Elijah Collard Survey, Abstract No. 1022/157, Montgomery County, Texas, out of a tract described in Volume 982, Page 1022 of the Deed Records of Montgomery County, Texas, being out of BLUE BELL, an unrecorded subdivision, said 1.179 acre tract being particularly described by attached plat of boundaries.

TRACT TWO:
BEING a 1.3 acre tract of land siting in the Elijah Collard Survey, Abstract No. 9047714, Montgomery County, Texas, out of a tract described in Volume 566, Page 1022 of the Deed Records of Montgomery County, Texas, being out of BLUE BELL, an unrecorded subdivision, said 1.3 acre tract being particularly described by attached plat of boundaries.

I hereby certify that this survey is correct on the ground under my supervision and this drawing correctly represents the facts as shown at the time of survey.

Date of Survey: 30 May 2013

Michael C. Warren
Registered Professional Land Surveyor

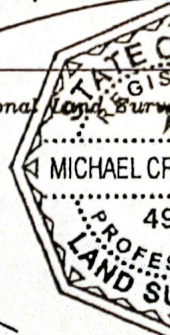

3.00 AC
2000-098388
Gary & Corene Finley
Kevin R. Woolsey
3.00 AC & 30' Roadway Esmt
2010033425

52

LAND TITLE SURVEY FOR: KEVIN FIELDS & CHERI FIELDS BLUE BELL DRIVE WILLIS, TEXAS 77318

POINT OF BEGINNING
called to bear
S 15°42'42"W 1718.7'
from NEC 47.547 AC 982/914

1.179 ACRES

1.3 ACRES

BLUE BELL (UNREC. SUBD.)

50

N 25°57'27" E 88.44'

N 21°57' E 143.00'

N 02°37'00" E 102.70'

N 74°14'33" W 167.82'

N 74°14'33" W 199.76'

N 15°50'42" E 299.87'

S 64°21'36" E 202.78'

S 15°51'39" W 265.07'

N 64°28'51" W 624.42'
4.47 AC 986/1
called N64°34'W 620.7'

N 64°29'22" W 421.63'

2.0697 AC
W. & J. Harwell
2003-113770
pt of 3.36 AC
961/724

60' Roadway 759/312

0.857 AC 1022/157

47.547 AC 80 AC 566/61

0.857 AC 986/1
4.47 AC 986/1

called 201 Contour (Woolsey)

see detail

fnd. 1/2" Iron rod (2.5' deep)

fnd. 5/8" Iron rod

fnd. 1/2" Iron rod

fnd. 1/2" Iron rod

fnd. 1/2" Iron rod

April 26, 2013

48

LDJ Bluebell LLC
2009-996819
(1048/858)
to Walter Rosemund
2011007164

3.29 AC
CF 9047710
to Walter Rosemund
2011010551

49

SCALE: 1"=60'
Reduced: 1"=80'±

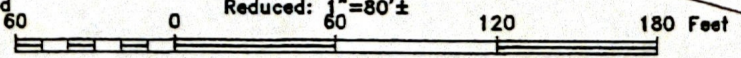

WILLIS, TEXAS 77378