

TEXAS OFFICIAL WOOD DESTROYING INSECT REPORT

Rule §7.176 Requires this department prescribed form to be used for real estate transactions in Texas regarding the visible presence or absence of wood destroying insects and conditions conducive to infestations of wood destroying insects.

8205 Arrowhead Lane

Inspected Address

Houston

City

77075

Zip Code

SCOPE OF INSPECTION

- A. This inspection covers only the multi-family structure, primary dwelling or place of business. Sheds, detached garages, lean-tos, fences, guest houses or any other structure will not be included in this inspection report unless specifically noted in Section 5 of this report.
- B. This inspection is limited to those parts of the structure(s) that are visible and accessible at the time of the inspection. Examples of inaccessible areas include but are not limited to (1) areas concealed by wall coverings, furniture, equipment and stored articles and (2) any portion of the structure in which inspection would necessitate removing or defacing any part of the structure(s) (including the surface appearance of the structure). **Inspection does not cover any condition or damage which was not visible in or on the structure(s) at time of inspection but which may be revealed in the course of repair or replacement work.**
- C. Due to the characteristics and behavior of various wood destroying insects, it may not always be possible to determine the presence of infestation without defacing or removing parts of the structure being inspected. Previous damage to trim, wall surface, etc., is frequently repaired prior to the inspection with putty, spackling, tape or other decorative devices. Damage that has been concealed or repaired may not be visible except by defacing the surface appearance. **The WDI inspecting company cannot guarantee or determine that work performed by a previous pest control company, as indicated by visual evidence of previous treatment; has rendered the pest(s) inactive.**
- D. If visible evidence of active or previous infestation of listed wood destroying insects is reported, it should be assumed that some degree of damage is present.
- E. If visible evidence is reported, it does not imply that damage should be repaired or replaced. Inspectors of the inspection company usually are not engineers or builders qualified to give an opinion regarding the degree of structural damage. Evaluation of damage and any corrective action should be performed by a qualified expert.
- F. **THIS IS NOT A STRUCTURAL DAMAGE REPORT OR A WARRANTY AS TO THE ABSENCE OF WOOD DESTROYING INSECTS.**
- G. If termite treatment (including pesticides, baits or other methods) has been recommended, the treating company must provide a diagram of the structure(s) inspected and proposed for treatment, label of pesticides to be used and complete details of warranty (if any). The warranty should specify which areas of the structure(s) are covered by warranty, renewal options and approval by a certified applicator in the termite category. Information regarding treatment and any warranties should be provided by the party contracting for such services to any prospective buyers of the property. The inspecting company has no duty to provide such information to any person other than the contracting party.
- H. There are a variety of termite control options offered by pest control companies. These options will vary in cost, efficacy, areas treated, warranties, treatment techniques and renewal options.
- I. There are some specific guidelines as to when it is appropriate for corrective treatment to be recommended. Corrective treatment may only be recommended if (1) there is visible evidence of an active infestation in or on the structure, (2) there is visible evidence of a previous infestation with no evidence of a prior treatment.
- J. If treatment is recommended based solely on the presence of conducive conditions, a preventive treatment or correction of conducive conditions may be recommended. The buyer and seller should be aware that there may be a variety of different strategies to correct the conducive condition(s). These corrective measures can vary greatly in cost and effectiveness and may or may not require the services of a licensed pest control operator. There may be instances where the inspector will recommend correction of the conducive conditions by either mechanical alteration or cultural changes. Mechanical alteration may be in some instances the most economical method to correct conducive conditions. If this inspection report recommends any type of treatment and you have any questions about this, you may contact the inspector involved, another licensed pest control operator for a second opinion, and/or the Structural Pest Control Service of the Texas Department of Agriculture.

8205 Arrowhead Lane

Houston

77075

Inspected Address

City

Zip Code

1A. WDIolutions 1B. TPCL # 848783
Name of Inspection Company SPCS Business License Number

1C. 5100 Westheimer Rd. #200 Houston TX 77056 832-292-3094
Address of Inspection Company City State Zip Telephone No.

1D. Al Spencer # 2812171634 eyeballrei@gmail.com 1.E Certified Applicator Technician
Name of Inspector (Please Print) (check one)

0000036280 1F. 11/05/2021
Inspection Date

2. Kiesha Curtis Seller Agent Buyer Management Co. Other
Name of Person Purchasing Inspection

3. N/A
Owner/Seller

4.REPORT FORWARDED TO: Title Company or Mortgagee Purchaser of Service Seller Agent Buyer
(Under the Structural Pest Control regulations only the purchaser of the service is required to receive a copy)

The structure(s) listed below were inspected in accordance with the official inspection procedures adopted by the Texas Department of Agriculture Structural Pest Control Service. This report is made subject to the conditions listed under the Scope of Inspection. A diagram must be attached including all structures inspected.

5A. Single Family Residence
List structure(s) inspected that may include residence, detached garages and other structures on the property. (Refer to Part A, Scope of Inspection)

5B. Type of Construction: Foundation: Slab Pier & Beam Pier Type: Cinder blocks Basement Other: N/A
Siding: Wood Fiber Cement Board Brick Stone Stucco Other: N/A
Roof: Composition Wood Shingle Metal Tile Other: N/A

6A. This company has treated or is treating the structure for the following wood destroying insects: N/A
If treating for subterranean termites, the treatment was: Partial Spot Bait Other
If treating for drywood termites or related insects, the treatment was: Full Limited

6B. N/A N/A N/A
Date of Treatment by Inspecting Company Common Name of Insect Name of Pesticide, Bait or Other Method

This company has a contract or warranty in effect for control of the following wood destroying insects:
Yes No List Insects: N/A
If "Yes", copy(ies) of warranty and treatment diagram must be attached.

Neither I nor the company for which I am acting have had, presently have, or contemplate having any interest in the purchase or sale of this property. I do further state that neither I nor the company for which I am acting is associated in any way with any party to this real estate transaction.

7A. Inspector (Technician or Certified Applicator Name and License Number)

Others Present:
7B. Apprentices, Technicians, or Certified Applicators Name(s) and Registration/License Number(s)

Notice of Inspection Was Posted At or Near:
8A. Electric Breaker Box Water Heater Closet Beneath the Kitchen Sink
8B. Date Posted: 11/05/2021

9A. Were any areas of the property obstructed or inaccessible? Yes X No
(Refer to Part B & C, Scope of Inspection) If "Yes" specify in 9B.

9B. The obstructed or inaccessible areas include but are not limited to the following:
Attic Insulated area of attic Plumbing Areas Planter box abutting structure
Deck Sub Floors Slab Joints Crawl Space
Soil Grade Too High Heavy Foliage Eaves Weepholes
Other Specify: N/A

10A. Conditions conducive to wood destroying insect infestation: Yes X No
(Refer to Part J, Scope of Inspection) If "Yes" specify in 10B.

10B. Conducive Conditions include but are not limited to:
Debris under or around structure (K) Wood to Ground Contact (G) Formboards left in place (I) Excessive Moisture (J)
Planter box abutting structure (O) Footing too low or soil line too high (L) Wood Rot (M) Heavy Foliage (N)
Insufficient ventilation (T) Wood Pile in Contact with Structure (Q) Wooden Fence in Contact with the Structure (R)
Other (C) Specify: N/A

Licensed and Regulated by the Texas Department of Agriculture
PO Box 12847, Austin, Texas 78711-2847 Phone 866-918-4481, Fax 888-232-2567

Inspected Address

City

Zip Code

11. Inspection Reveals Visible Evidence in or on the structure:

11A.Subterranean Termites

11B.Drywood Termites

11C Formosan Termites

11D.Carpenter Ants

11E .Other Wood Destroying Insects

Active Infestation

Yes No

Yes No

Yes No

Yes No

Yes No

Previous Infestation

Yes No

Yes No

Yes No

Yes No

Yes No

Previous Treatment

Yes No

Yes No

Yes No

Yes No

Yes No

Specify: N/A

11F.Explanation of signs of previous treatment (including pesticides, baits, existing treatment stickers or other methods) identified: N/A

11G.Visible evidence of: N/A has been observed in the following areas: N/A

If there is visible evidence of active or previous infestation, it must be noted. The type of insect(s) must be listed in the first blank and all identified infested areas of the property inspected must be noted in the second blank. (Refer to Part D, E & F, Scope of Inspection)

12A. Corrective treatment recommended for active infestation or evidence of previous infestation with no prior treatment as identified in Section 11. (Refer to Part G, H, and I, Scope of Inspection) Yes No

12B. A preventive treatment and/or correction of conducive conditions as identified in 10A & 10B is recommended as follows: Yes No

Specify reason: Wood to Ground Contact (G), Debris under or around structure (K), Wood Rot (M)

Refer to Scope of Inspection Part J

Diagram of Structure(s) Inspected

The inspector must draw a diagram including approximate perimeter measurements and indicate active or previous infestation and type of insect by using the following codes: E- Evidence of Infestation, A-Active; P-Previous; D-Drywood Termites; S-Subterranean Termites; F-Formosan Termites; C-Conductive Conditions; B-Wood Boring Beetles; H- Carpenter Ants; Other(s) - Specify N/A

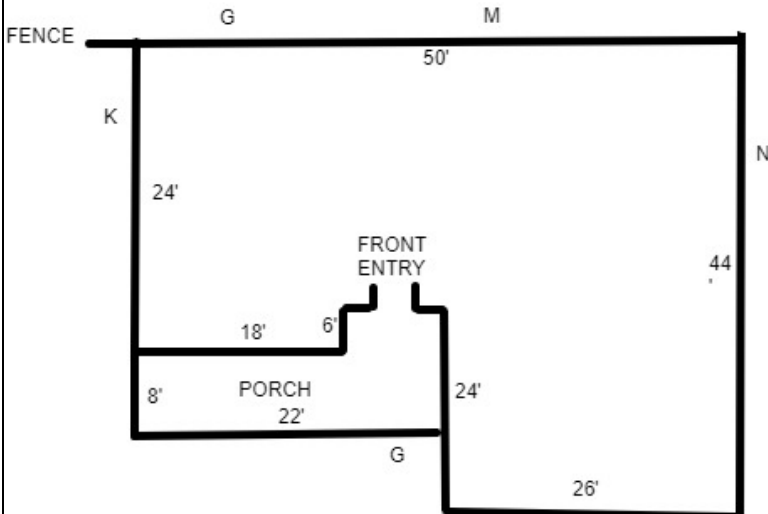

G - WOOD TO GROUND CONTACT
 K - WOOD DEBRIS AROUND OR UNDER STRUCTURE
 M - WOOD ROT

Additional Comments Your Report Recommends a Preventive Treatment. Your WDI Inspection makes a recommendation for Treatment based solely on Conductive Conditions which makes it eligible for WDI Suppression treatment. Please see the attached addendum for important information.

Inspected Address

City

Zip Code

Statement of Purchaser

I have received the original or a legible copy of this form. I have read and understand any recommendations made. I have also read and understand the "Scope of Inspection." I understand that my inspector may provide additional information as an addendum to this report.

If additional information is attached, list number of pages: 1

Signature of Purchaser of Property or their Designee _____ Date _____

Customer or Designee Not Present

Buyer's Initials _____







Thank you for choosing WDI Solutions and BUGSTOP

Your Inspection report recommends a preventive treatment based solely on conducive conditions. **This does NOT mean that it is free of a hidden Termite Infestation. However your home IS eligible for a Suppression treatment that is an alternative to costly traditional treatment.**



Suppression has some major benefits for both buyers & sellers.

- **Low cost of only \$299.00 up to 2500 Sq. Ft. (10 cents SqFt)**
- **1 year warranty on Subterranean Termites & Carpenter ants**
- **Minimizes the need to correct most conducive conditions.**
- **Includes a clear WDI report required by most lenders.**
- **Accepted by VA/FHA and most mortgage lenders.**



**Call Tammy Schwartz
Sales & Scheduling
210-668-3936
service.bugstop@gmail.com**

