

ELEVATION CERTIFICATE

Important: Follow the instructions on pages 1-9.

Copy all pages of this Elevation Certificate and all attachments for (1) community official, (2) insurance agent/company, and (3) building owner.

SECTION A – PROPERTY INFORMATION					FOR INSURANCE COMPANY USE	
A1. Building Owner's Name TBD Job#7-75673-19					Policy Number:	
A2. Building Street Address (including Apt., Unit, Suite, and/or Bldg. No.) or P.O. Route and Box No. 7301 Palmira Way					Company NAIC Number:	
City Galveston		State TX		ZIP Code 77551		
A3. Property Description (Lot and Block Numbers, Tax Parcel Number, Legal Description, etc.) Lot 7, Magnolia Curt Subdivision						
A4. Building Use (e.g., Residential, Non-Residential, Addition, Accessory, etc.) Residential						
A5. Latitude/Longitude: Lat. 29° 19' 22.7"N Long. 94° 50' 40.3"W Horizontal Datum: <input type="checkbox"/> NAD 1927 <input checked="" type="checkbox"/> NAD 1983						
A6. Attach at least 2 photographs of the building if the Certificate is being used to obtain flood insurance.						
A7. Building Diagram Number 1B						
A8. For a building with a crawlspace or enclosure(s):						
a) Square footage of crawlspace or enclosure(s) N/A sq ft						
b) Number of permanent flood openings in the crawlspace or enclosure(s) within 1.0 foot above adjacent grade N/A						
c) Total net area of flood openings in A8.b N/A sq in						
d) Engineered flood openings? <input type="checkbox"/> Yes <input checked="" type="checkbox"/> No						
A9. For a building with an attached garage:						
a) Square footage of attached garage 386 sq ft						
b) Number of permanent flood openings in the attached garage within 1.0 foot above adjacent grade 2						
c) Total net area of flood openings in A9.b 400* sq in						
d) Engineered flood openings? <input checked="" type="checkbox"/> Yes <input type="checkbox"/> No						
SECTION B – FLOOD INSURANCE RATE MAP (FIRM) INFORMATION						
B1. NFIP Community Name & Community Number City of Galveston 485469			B2. County Name Galveston		B3. State TX	
B4. Map/Panel Number 485469 0023	B5. Suffix E	B6. FIRM Index Date 12-06-02	B7. FIRM Panel Effective/ Revised Date 12-06-02	B8. Flood Zone(s) AE	B9. Base Flood Elevation(s) (Zone AO, use Base Flood Depth) 11.0'	
B10. Indicate the source of the Base Flood Elevation (BFE) data or base flood depth entered in Item B9: <input type="checkbox"/> FIS Profile <input checked="" type="checkbox"/> FIRM <input type="checkbox"/> Community Determined <input type="checkbox"/> Other/Source: _____						
B11. Indicate elevation datum used for BFE in Item B9: <input type="checkbox"/> NGVD 1929 <input type="checkbox"/> NAVD 1988 <input checked="" type="checkbox"/> Other/Source: NAVD 1988/2001 ADJ						
B12. Is the building located in a Coastal Barrier Resources System (CBRS) area or Otherwise Protected Area (OPA)? <input type="checkbox"/> Yes <input checked="" type="checkbox"/> No Designation Date: _____ <input type="checkbox"/> CBRS <input type="checkbox"/> OPA						

ELEVATION CERTIFICATE

OMB No. 1660-0008
Expiration Date: November 30, 2018

IMPORTANT: In these spaces, copy the corresponding information from Section A.

Building Street Address (including Apt., Unit, Suite, and/or Bldg. No.) or P.O. Route and Box No.
7301 Palmira Way

FOR INSURANCE COMPANY USE
Policy Number:

City **Galveston** State **TX** ZIP Code **77551**

Company NAIC Number

SECTION C – BUILDING ELEVATION INFORMATION (SURVEY REQUIRED)

C1. Building elevations are based on: Construction Drawings* Building Under Construction* Finished Construction
*A new Elevation Certificate will be required when construction of the building is complete.

C2. Elevations – Zones A1–A30, AE, AH, A (with BFE), VE, V1–V30, V (with BFE), AR, AR/A, AR/AE, AR/A1–A30, AR/AH, AR/AO.
Complete Items C2.a–h below according to the building diagram specified in Item A7. In Puerto Rico only, enter meters.

Benchmark Utilized: **AW 0461** Vertical Datum: **NAVD 1988/2001 ADJ**

Indicate elevation datum used for the elevations in items a) through h) below.

NGVD 1929 NAVD 1988 Other/Source: **NAVD 1988/2001 ADJ**

Datum used for building elevations must be the same as that used for the BFE.

		Check the measurement used.	
a) Top of bottom floor (including basement, crawlspace, or enclosure floor)	<u>12.82</u>	<input checked="" type="checkbox"/> feet	<input type="checkbox"/> meters
b) Top of the next higher floor	<u>N/A</u>	<input type="checkbox"/> feet	<input type="checkbox"/> meters
c) Bottom of the lowest horizontal structural member (V Zones only)	<u>N/A</u>	<input type="checkbox"/> feet	<input type="checkbox"/> meters
d) Attached garage (top of slab)	<u>9.59</u>	<input checked="" type="checkbox"/> feet	<input type="checkbox"/> meters
e) Lowest elevation of machinery or equipment servicing the building (Describe type of equipment and location in Comments)	<u>13.01</u>	<input checked="" type="checkbox"/> feet	<input type="checkbox"/> meters
f) Lowest adjacent (finished) grade next to building (LAG)	<u>9.4</u>	<input checked="" type="checkbox"/> feet	<input type="checkbox"/> meters
g) Highest adjacent (finished) grade next to building (HAG)	<u>9.9</u>	<input checked="" type="checkbox"/> feet	<input type="checkbox"/> meters
h) Lowest adjacent grade at lowest elevation of deck or stairs, including structural support	<u>N/A</u>	<input type="checkbox"/> feet	<input type="checkbox"/> meters

SECTION D – SURVEYOR, ENGINEER, OR ARCHITECT CERTIFICATION

This certification is to be signed and sealed by a land surveyor, engineer, or architect authorized by law to certify elevation information. I certify that the information on this Certificate represents my best efforts to interpret the data available. I understand that any false statement may be punishable by fine or imprisonment under 18 U.S. Code, Section 1001.

Were latitude and longitude in Section A provided by a licensed land surveyor? Yes No Check here if attachments.

Certifier's Name **Richard Fussell** License Number **4148**

Title **R.P.L.S**

Company Name **Survey 1, Inc., Firm Number #100758-00**

Address **2408 Mustang Road**

City **Alvin** State **TX** ZIP Code **77511**

Signature  Date **8-29-19** Telephone **281.393.1382** Ext.

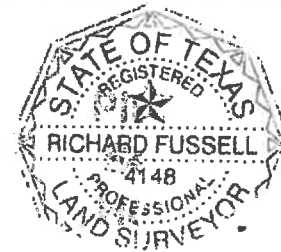

Copy all pages of this Elevation Certificate and all attachments for (1) community official, (2) insurance agent/company, and (3) building owner.

Comments (including type of equipment and location, per C2(e), if applicable)

- 1). Centerline street elevation - 7.39'
- 2). TBM Elevation - 7.39'
- 3). TBM Location - Mag nail in centerline of Palmira Way at the center of property
- 4). C2e used for A/C
- 5). *2 Vents providing 400 sq ft of coverage per ECC-ES Report which is equivalent to 400 sq in. of net flood vent area

1 CERTIFICATE

OMB No. 1660-0008
Expiration Date: November 30, 2018

In these spaces, copy the corresponding information from Section A.

Address (including Apt., Unit, Suite, and/or Bldg. No.) or P.O. Route and Box No.
Mira Way

FOR INSURANCE COMPANY USE
Policy Number:

City _____ State TX ZIP Code 77551

Company NAIC Number

**SECTION E – BUILDING ELEVATION INFORMATION (SURVEY NOT REQUIRED)
FOR ZONE AO AND ZONE A (WITHOUT BFE)**

and A (without BFE), complete Items E1–E5. If the Certificate is intended to support a LOMA or LOMR-F request, use Zones A, B, and C. For Items E1–E4, use natural grade, if available. Check the measurement used. In Puerto Rico only,

elevation information for the following and check the appropriate boxes to show whether the elevation is above or below the adjacent grade (HAG) and the lowest adjacent grade (LAG).

Bottom floor (including basement, porch, or enclosure) is _____ feet meters above or below the HAG.

Bottom floor (including basement, porch, or enclosure) is _____ feet meters above or below the LAG.

Ground floor (elevation C2.b in Diagrams 6–9 with permanent flood openings provided in Section A Items 8 and/or 9 (see pages 1–2 of Instructions), or lowest floor (elevation C2.b in Diagrams 6–9) is _____ feet meters above or below the HAG.

Grade (top of slab) is _____ feet meters above or below the HAG.

Height of machinery and/or equipment above the building is _____ feet meters above or below the HAG.

Only: If no flood depth number is available, is the top of the bottom floor elevated in accordance with the community's management ordinance? Yes No Unknown. The local official must certify this information in Section G.

SECTION F – PROPERTY OWNER (OR OWNER'S REPRESENTATIVE) CERTIFICATION

I, _____, Property Owner or owner's authorized representative who completes Sections A, B, and E for Zone A (without a FEMA-issued or approved BFE) or Zone AO must sign here. The statements in Sections A, B, and E are correct to the best of my knowledge.

Signature of Owner's Authorized Representative's Name

City _____ State _____ ZIP Code _____

Date 8-29-19 Telephone _____

Check here if attachments.

ELEVATION CERTIFICATE

OMB No. 1660-0008
Expiration Date: November 30, 2018

IMPORTANT: in these spaces, copy the corresponding information from Section A.

Building Street Address (including Apt., Unit, Suite, and/or Bldg. No.) or P.O. Route and Box No.
7301 Palmira Way

City **Galveston** State **TX** ZIP Code **77551**

FOR INSURANCE COMPANY USE
Policy Number:

Company NAIC Number

SECTION G - COMMUNITY INFORMATION (OPTIONAL)

The local official who is authorized by law or ordinance to administer the community's floodplain management ordinance can complete Sections A, B, C (or E), and G of this Elevation Certificate. Complete the applicable item(s) and sign below. Check the measurement used in Items G8-G10. In Puerto Rico only, enter meters.

- G1. The information in Section C was taken from other documentation that has been signed and sealed by a licensed surveyor, engineer, or architect who is authorized by law to certify elevation information. (Indicate the source and date of the elevation data in the Comments area below.)
- G2. A community official completed Section E for a building located in Zone A (without a FEMA-issued or community-issued BFE) or Zone AO.
- G3. The following information (Items G4-G10) is provided for community floodplain management purposes.

G4. Permit Number _____ G5. Date Permit Issued _____ G6. Date Certificate of Compliance/Occupancy Issued _____

G7. This permit has been issued for: New Construction Substantial Improvement

G8. Elevation of as-built lowest floor (including basement) of the building: _____ feet meters Datum _____

G9. BFE or (in Zone AO) depth of flooding at the building site: _____ feet meters Datum _____

G10. Community's design flood elevation: _____ feet meters Datum _____

Local Official's Name _____ Title _____

Community Name _____ Telephone _____

Signature _____ Date **8-29-19**

Comments (including type of equipment and location, per C2(e), if applicable)

Check here if attachments.

ELEVATION CERTIFICATE

BUILDING PHOTOGRAPHS

See Instructions for Item A6.

OMB No. 1660-0008
Expiration Date: November 30, 2018

IMPORTANT: In these spaces, copy the corresponding information from Section A.

Building Street Address (including Apt., Unit, Suite, and/or Bldg. No.) or P.O. Route and Box No.
7301 Palmira Way

FOR INSURANCE COMPANY USE

Policy Number:

City

Galveston

State

TX

ZIP Code

77551

Company NAIC Number

If using the Elevation Certificate to obtain NFIP flood insurance, affix at least 2 building photographs below according to the instructions for Item A6. Identify all photographs with date taken; "Front View" and "Rear View"; and, if required, "Right Side View" and "Left Side View." When applicable, photographs must show the foundation with representative examples of the flood openings or vents, as indicated in Section A8. If submitting more photographs than will fit on this page, use the Continuation Page.



Photo One Caption **Front of Home 7-31-19**

PHOTO ONE

Clear Photo One



Photo Two Caption **Back of Home 7-31-19**

PHOTO TWO

Clear Photo Two