

- NOTES:
- RECORD EASEMENTS, RESTRICTIONS, ROADWAYS, RIGHTS-OF-WAY, ETC. BY COMMON KNOWLEDGE ONLY. OTHER RESTRICTIONS MAY APPLY
  - Restrictions as per recorded plat unless otherwise noted
  - Vol 2074, Pg 693, OCCGC
  - 10' utility esmt w/ 5' x 20' aerial easement along front
  - 20' road side building line
  - 8' side building lines
  - True ground distances shown
  - Bearings assumed as platted
  - Survey monuments reconciled w/numerous previous surveys

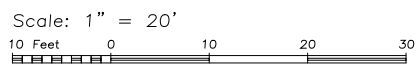

LAND TITLE SURVEY OF A TRACT OF LAND being Lot 106, of SEA ISLE, SECTION 15, a subdivision in Galveston County, Texas, according to the map or plat thereof recorded in Volume 1616, Page 190, and transferred to Plat Record 8, Map No. 90, both of the Map Records of Galveston County, Texas.

Subject property: 22129 Pecos Drive  
 Galveston County, Texas  
 To Michael Blaine Yeary, Amy McCreight-Yeary and Seaside Construction;

I hereby certify that this survey was made on the ground under my direct supervision and that this plat correctly represents the facts found at the time of the survey.

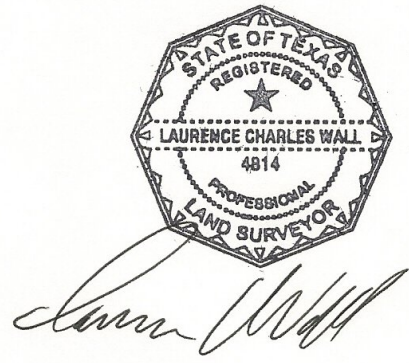

Laurence C. Wall  
 RPLS #4814  
 December 11, 2012

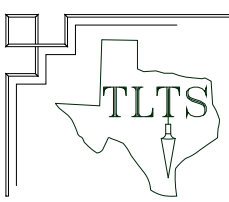

**TLTS, Inc.**  
 TEXAS LAND TITLE SURVEYORS  
 1801 Moody Avenue  
 Galveston, Texas 77550  
 (409) 765-8883