

RIVER PLANTATION DRIVE  
(60' R.O.W.)

RIVER PLANTATION SECTION FIVE  
(VOL. 9, PG. 2)

RIVER PLANTATION PROPERTIES LLC  
71.9974 ACRES TRACT  
(CP NO. 2008014711)

LOT 1

LOT 2

WOOD FENCE

BARBED WIRE FENCE

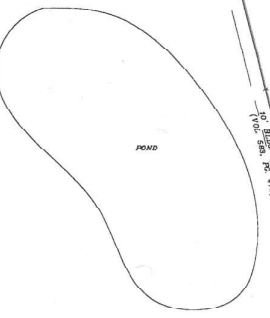

VACANT LOT  
7.942 ACRES TRACT  
(CALLED 7.9530 ACRES TRACT)  
(A.K.A. TRACT 312)  
(CP NO. 2018070992)  
345959 SQ. FT.

CHARLES PROFFER TRACT  
PORTION OF TRACT 311  
(A.K.A. TRACT 310B)  
(CP NO. 85008)  
5.10033 E. 114.41'  
S. 120.23' E. 115.65' CALLED

MONTGOMERY COUNTY, STATE OF TEXAS  
N 150.00' W 113.44'  
N 150.00' W 113.44'  
N 150.00' W 113.44'  
N 150.00' W 113.44'

200' ANIMAL BLDG. SETBACK  
(VOL. 683, PG. 473)

100' BLDG. SETBACK  
(VOL. 683, PG. 478)

EHLERS ROAD  
(UNKNOWN R.O.W.)

S 75°05'40" W 299.61' (CALLED)  
S 75°05'40" W 299.52'

