

S PRESA ST
50' R.O.W.

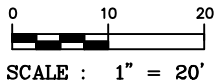

LEGEND

- F.I.P. : FOUND IRON PIN
- S.I.P. : SET 1/2" IRON PIN
- C.M. : CONTROLLING MONUMENT
- F.P. : IRON FENCE POST
- A/C : 3'x3' CONCRETE A/C PAD
- W.M. : WATER METER
- P.P. : POWER POLE
- C.P. : CALCULATED POINT
- D.P.R. : DEED AND PLAT RECORDS
- P- : OVERHEAD POWER LINE
- : WOODEN FENCE
- : WROUGHT IRON FENCE
- △ : SHEET METAL FENCE

STREET ADDRESS: 1511 S PRESA STREET
 LOT: 22 BLOCK: - N.C.B.: 3078
 SUBDIVISION: F.C. BIERING SUBDIVISION
 PLAT RECORDS, VOLUME: 105 PAGE(S): 108
 CITY: SAN ANTONIO, BEXAR COUNTY, TEXAS
 SURVEYED FOR: ALAMO TITLE COMPANY
 G.F. NO.: SAT-06-4000062000677-RM
 BUYER(S): EDWIN KREUSEL, JR AND
ROBIN PEVEHOUSE GULDENPFENNIG

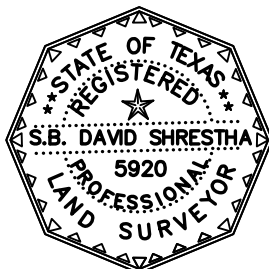

STATE OF TEXAS
COUNTY OF BEXAR

I HEREBY CERTIFY THAT THE ABOVE PLAT IS TRUE, CORRECT AND AN ACCURATE REPRESENTATION OF THE PROPERTY ACCORDING TO AN ACTUAL SURVEY MADE ON THE GROUND UNDER MY SUPERVISION AND EXCEPT AS SHOWN ABOVE THERE ARE NO VISIBLE DISCREPANCIES, CONFLICTS, PROTRUSIONS OR INTRUSIONS, OVERLAPPING OF IMPROVEMENTS, EASEMENTS, OR RIGHT-OF-WAY.

NOTE:
BEARINGS ARE BASED ON THE RECORDED PLAT.

UPDATED: 04/16/2020

THIS 30-TH DAY OF MARCH, 2020 A.D.

S. B. Shrestha



TEXAS ENGINEERING & SURVEYING, INC.

CONSULTING ENGINEERS & LAND SURVEYORS

www.TexasEngineeringSurveying.com

FIRM REG: TBPE F-14631, TBPLS 10193833

114 W. GLENVIEW DRIVE, SUITE 100 TEL (210) 524-3288
 SAN ANTONIO, TEXAS 78228 FAX (210) 979-9866

THIS PROPERTY IS SUBJECT TO RESTRICTIVE COVENANTS RECORDED IN:

VOL. - PG. - VOL. - PG. - VOL. - PG. -
 VOL. - PG. - VOL. - PG. - VOL. - PG. -
 VOL. - PG. - VOL. - PG. - VOL. - PG. -