

ROSS DESIGN SERVICE

P.O. Box 1167
Pinehurst, TX 77362
281-384-3976
ANDREW@ROSSDESIGNSERVICE.COM

CRAIG METCALF
AGG ROAD
TOMBALL, TX 77377

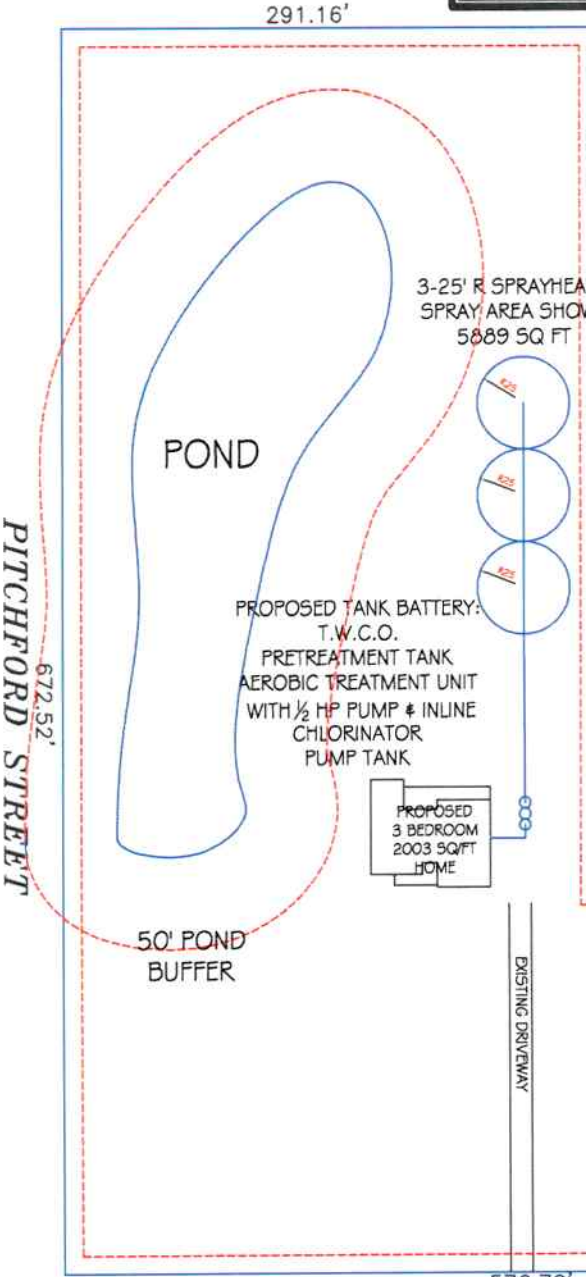

COUNTY	HARRIS
ACREAGE	
SURVEY	JESSE PRUITT
ABSTRACT	A-529
SUBDIVISION	
SECTION	
BLOCK	
LOT	
FLOOD ZONE	X
FEMA #:	48201C0230L
SLOPE	<5%
BEDROOMS	3
LIVING AREA	2,003

DATE	03-21-2018
DRAWN BY:	AKR
DESIGNED BY:	AKR
SCALE	AS NOTED
TOTAL GPD	240
APPLICATION RATE	0.041
REQUIRED SPRAY AREA:	5,854
PROVIDED SPRAY AREA:	5,890

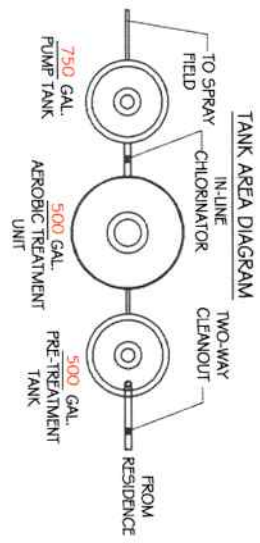

PROPOSED ON-SITE SEWAGE FACILITY	
EQUIPMENT SPECIFICATIONS	
PRETREATMENT TANK	500 GALLON ~ PRE-CAST CONCRETE
AEROBIC TREATMENT UNIT	500 GALLON ~ PROFLO500 OR EQUAL
PUMP TANK	750 GALLON ~ PRE-CAST CONCRETE
SPRAYHEADS:	RAINBIRD ~25" RADIUS ~ R50LA OR EQUAL
TANK NOTES	
1. ALL EXISTING SEPTIC TANKS TO BE ABANDONED	
2. TANKS NOT BUILT FOR TRAFFIC BEARING LOADS	
3. TANKS INSTALLED IN LINE ON 90' OFFSETS	
MISCELLANEOUS NOTES	
1. MAINTAIN ALL BUFFER ZONES SHOWN ON DRAWING	
2. PRIVATE WATER WELL MUST BE A MINIMUM OF 50 FT. FROM SEPTIC TANKS AND 100 FT. FROM SPRAY FIELD, UNLESS IT IS PRESSURE CEMENTED, THEN IT MUST BE 50 FT. FROM SEPTIC TANKS AND SPRAY FIELD.	
BUFFER ZONE NOTES	
-SEPTIC TANKS MUST BE AT LEAST 10 FT. FROM	
- ANY EASEMENT NOT SHOWN ON DRAWING.	

GENERAL NOTES:	
1. AN ON-SITE SEWAGE LICENSE MUST BE OBTAINED PRIOR TO INSTALLING THIS WASTEWATER DISPOSAL SYSTEM	
2. SYSTEM INSTALLATION MUST BE BY A REGISTERED INSTALLER OF ON-SITE SEWAGE FACILITIES AS REQUIRED BY ARTICLE 4477-76 OF VERNON'S CIVIL STATUTES OR BY THE OWNER OF THE PROPERTY UNDER LICENSE. NO COMPONENT OF THIS SYSTEM SHALL BE COVERED UP WITHOUT COUNTY'S APPROVAL	
3. IF ANY DISCREPANCIES EXIST BETWEEN THIS DESIGN AND ACTUAL FIELD CONDITIONS IT IS THE INSTALLER'S RESPONSIBILITY TO IMMEDIATELY NOTIFY THE ENGINEER AND THE JURISDICTION PRIOR TO BEGINNING OF CONSTRUCTION.	
4. ALL CONSTRUCTION METHODS AND MATERIALS MUST BE IN ACCORDANCE WITH COUNTY AND STATE RULES AND POLICIES, UNLESS SPECIFICALLY NOTED ON THESE DRAWINGS AND ARE APPROVED BY THE JURISDICTION.	
5. SITE SHALL BE CAREFULLY FINISH GRADED AFTER CONSTRUCTION OF SYSTEM IS COMPLETED. TO PROVIDE ADEQUATE STORM WATER DRAINAGE, ABSORPTION AREA SHALL BE CROWNED, DRAINAGE SWALES SHALL BE CONSTRUCTED TO ADEQUATELY CONVEY STORM WATER DRAINAGE AWAY FROM ABSORPTION AREA.	
6. THIS SYSTEM INSTALLED AND OPERATED IN ACCORDANCE WITH THIS PLAN SHALL NOT PRESENT A HAZARD TO PUBLIC HEALTH OR THREATEN PROPOSED OR ADJACENT WATER WELLS.	
7. THERE SHALL BE AT LEAST ONE DAY OF DRY STORAGE VOLUME OF ONE-THIRD THE DAILY FLOW BETWEEN THE ALARM-ON LEVEL AND THE INLET TO THE PUMP TANK.	
8. IF SYSTEM IS LOCATED IN FLOOD PLAIN, THEN ALL ELECTRICAL COMPONENTS NEED TO BE INSTALLED 18" ABOVE BASE FLOOD ELEVATION.	
9. PUMP TANK FLOAT ELEVATIONS MUST BE SET IN COMPLIANCE WITH 30 TAC 285.33(a)(2)(G)(iv)(1)	
10. SPRAY HEADS TO BE NO CLOSER THAN 10' FROM TREES OR OTHER OBSTRUCTIONS THAT INTERFERE WITH SPRAY PATTERN	
11. TIMER MUST BE SET TO DISCHARGE BETWEEN THE HOURS OF MIDNIGHT AND 5 am.	