



LOT :	54	BLOCK :	4	SUBDIVISION :	SILVERSTONE	SECTION :	1
COUNTY :	STATE :	RECORDATION :	SURVEY:		SCALE: 1"=20'		
HARRIS	TEXAS	VOL. 254, PG. 56 H.C.M.R.	FIELD WORK: 07-17-98/GG		FINAL CHECK: 07-24-98/SB		
PURCHASER: MARY MARGARET FITZGERALD			DRAFTING: 07-24-98/ A.A.		KEY MAP: 485 H		
ADDRESS: 903 WESTERN HILLS DRIVE, KATY, TEXAS, 77450							



**ALLTEX**  
REALTY SERVICES

REAL ESTATE SURVEY DIVISION  
9525 KATY FREEWAY, SUITE 420  
HOUSTON, TEXAS 77024  
TEL: (713) 468-7707  
FAX: (713) 468-8815

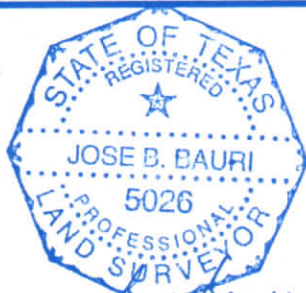

*Jose B. Bauri*

I DO HEREBY CERTIFY THAT THIS SURVEY WAS THIS DAY MADE ON THE GROUND OF THE PROPERTY LEGALLY DESCRIBED HEREON IS CORRECT AND THERE ARE NO ENCROACHMENTS EXCEPT AS SHOWN HEREON.

• Subject Property IS NOT Located in a Federal Insurance Administration Designated Flood Hazard Area. ZONE "X"  
As per map 480287  
Panel 0595 J Dated NOV. 06, 1996

• THIS INFORMATION IS BASED ON GRAPHIC PLOTTING ONLY. WE DO NOT ASSUME RESPONSIBILITY FOR EXACT DETERMINATION.

MORT. CO.	FOREMOST MTG.
TITLE CO.	ALAMO TITLE CO.
Q.F. NO.	9875278079
JOB NO.	98 - 08693
REV. DATE	-