

Building Sketch

Borrower					
Property Address		1516 Prairie Grove Dr			
City	Houston	County	Harris	State	TX
Zip Code		77077			
Lender/Client					

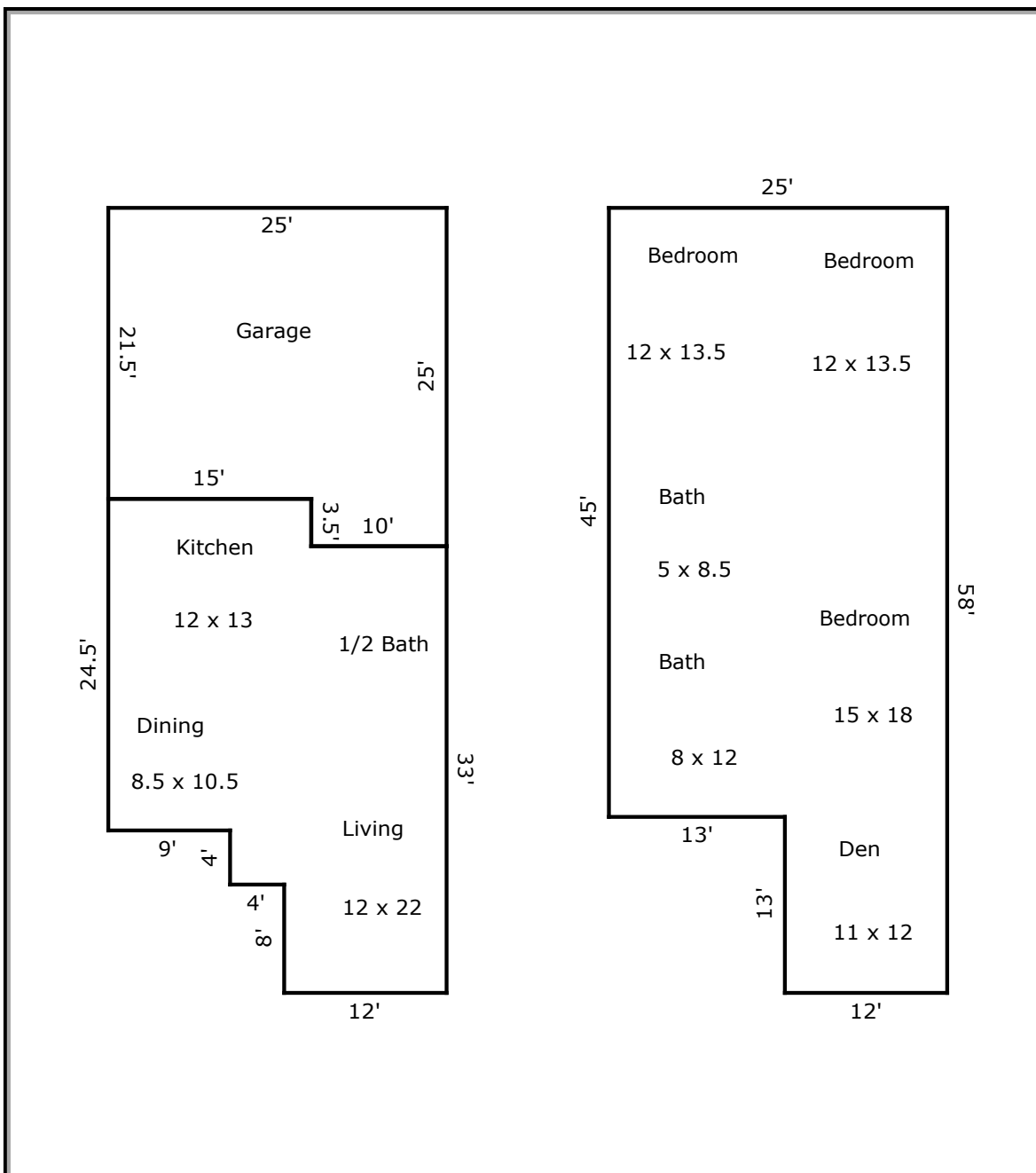

TOTAL Sketch by a la mode, inc.

Area Calculations Summary

Living Area	Calculation Details	
First Floor	737.5 Sq ft	$12 \times 8 = 96$ $25 \times 10 = 250$ $6 \times 4 = 24$ $24.5 \times 15 = 367.5$
Second Floor	1281 Sq ft	$12 \times 13 = 156$ $45 \times 25 = 1125$
Total Living Area (Rounded):	2019 Sq ft	
Non-living Area		
2 Car Attached	572.5 Sq ft	$25 \times 21.5 = 537.5$ $10 \times 3.5 = 35$