

NOTES:
 1.) SUBJECT TO APPLICABLE RESTRICTIVE COVENANTS IN ITEM NO. 1, SCHEDULE "B"
 OF TITLE COMMITMENT ISSUED BY COMMERCE LAND TITLE CO. UNDER G.F. NO. 99-31-11685.

ABSTRACTING BY TITLE COMPANY.
 SUBJECT PROPERTY IS BASED ON TITLE COMMITMENT LISTED BELOW.
 ALL BEARINGS SHOWN ARE REFERENCED PER RECORDED PLAT OF SAID SUBDIVISION.

| | | | | | | | |
|---|-------|-------------------------|-------|--------------------------|----------------------------|---------------|---|
| LOT: | 8 | BLOCK: | 13 | SUBDIVISION: | THE LANDING | SECTION: | 1 |
| COUNTY: | TEXAS | STATE: | TEXAS | RECORDATION: | BOOK 15, PG. 159, G.C.M.R. | SURVEY: | - |
| PURCHASER: SHANNON R. DOUGHER | | FIELD WORK: 10-06-99/LG | | FINAL CHECK: 10-13-99/SB | | SCALE: 1"=20' | |
| ADDRESS: 2816 KNOXVILLE DRIVE, LEAGUE CITY, TEXAS | | DRAFTING: 10-13-99/CP | | KEY MAP: 658 T | | | |



ALTEX
 REALTY SERVICES

REAL ESTATE SURVEY DIVISION
 9610 LONGPOINT, SUITE 150
 HOUSTON, TEXAS 77055
 TEL: (713) 468-7707
 FAX: (713) 468-8815

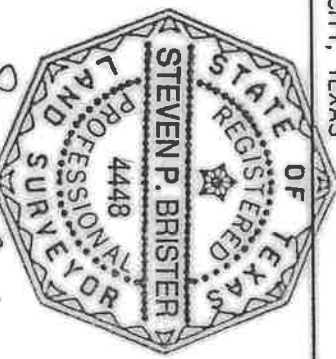

Steven P. Brister

I DO HEREBY CERTIFY THAT THIS SURVEY WAS THIS DAY MADE ON THE GROUND OF THE PROPERTY LEGALLY DESCRIBED HEREON IS CORRECT AND THERE ARE NO ENCROACHMENTS EXCEPT AS SHOWN.

| | |
|-----------|---------------------|
| MORT. CO. | CORNERSTONE MORTG. |
| TITLE CO. | COMMERCE LAND TITLE |
| G.F. No. | 99-31-11685 |
| JOB No. | 99-21537 |
| REV. DATE | - |

* SUBJECT PROPERTY -IS NOT- LOCATED IN A FEDERAL INSURANCE ADMINISTRATION DESIGNATED FLOOD HAZARD AREA ZONE "X" AS PER MAP 485488 DATED: 11-05-95 PANEL 0025 C

* This information is based on graphic plotting only. We do not assume responsibility for exact determination.