

# SIERRA VISTA and STERLING LAKES AT IOWA COLONY A CANYON GATE® COMMUNITY

## COMPOSITE LAND PLAN

LOT TABLE								
	45' Lots	50' Lots	55' Lots	60' Lots	65' Lots	70' Lots	100' Lots	TOTAL
Sterling Lakes North	323 Lots	183 Lots	-	365 Lots	5 Lots	-	-	876 Lots
Sterling Lakes	478 Lots	173 Lots	253 Lots	241 Lots	-	59 Lots	78 Lots	1,282 Lots
Sierra Vista	-	368 Lots	-	184 Lots	-	32 Lots	-	584 Lots
Sierra Vista West	-	887 Lots	-	371 Lots	-	-	-	1,258 Lots
<b>TOTAL</b>	<b>801 Lots</b>	<b>1,611 Lots</b>	<b>253 Lots</b>	<b>1,161 Lots</b>	<b>5 Lots</b>	<b>91 Lots</b>	<b>78 Lots</b>	<b>4,000 Lots</b>

110 For Rent Units  
532 Townhouse Units

LEGEND	
	Indicates Commercial Tracts
	Indicates School Sites
	Indicates Detention Lakes
	Indicates Civic Sites
	Indicates Proposed Crystal Lagoon
	Indicates Iowa Colony City Limit
	Indicates Possible Location of Crystal Lagoon Based on City Approval

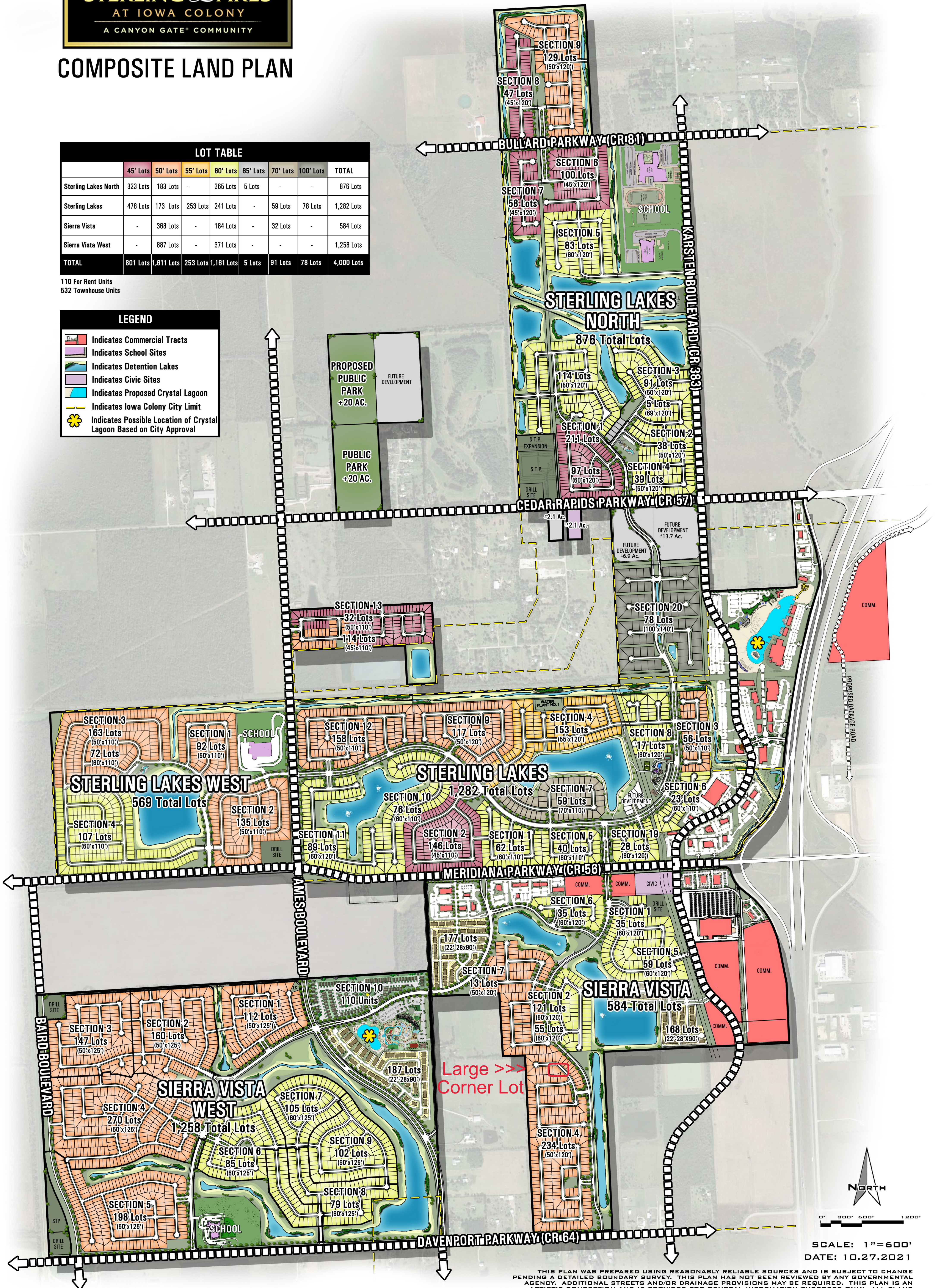

SCALE: 1"=600'  
DATE: 10.27.2021

THIS PLAN WAS PREPARED USING REASONABLY RELIABLE SOURCES AND IS SUBJECT TO CHANGE PENDING A DETAILED BOUNDARY SURVEY. THIS PLAN HAS NOT BEEN REVIEWED BY ANY GOVERNMENTAL AGENCY. ADDITIONAL STREETS AND/OR DRAINAGE PROVISIONS MAY BE REQUIRED. THIS PLAN IS AN ARTIST'S CONCEPTION AND IS PROVIDED FOR GENERAL INFORMATION PURPOSES ONLY. ALL PLANS FOR FACILITIES OR LAND USES ARE SUBJECT TO CHANGE WITHOUT NOTICE.