

FLOORPLAN SKETCH

Client: Lori Craft File No.: 19507 Wildflower Field
 Property Address: 19507 Wildflower Field Ct Case No.:
 City: Cypress State: Tx Zip: 77433

Sketch

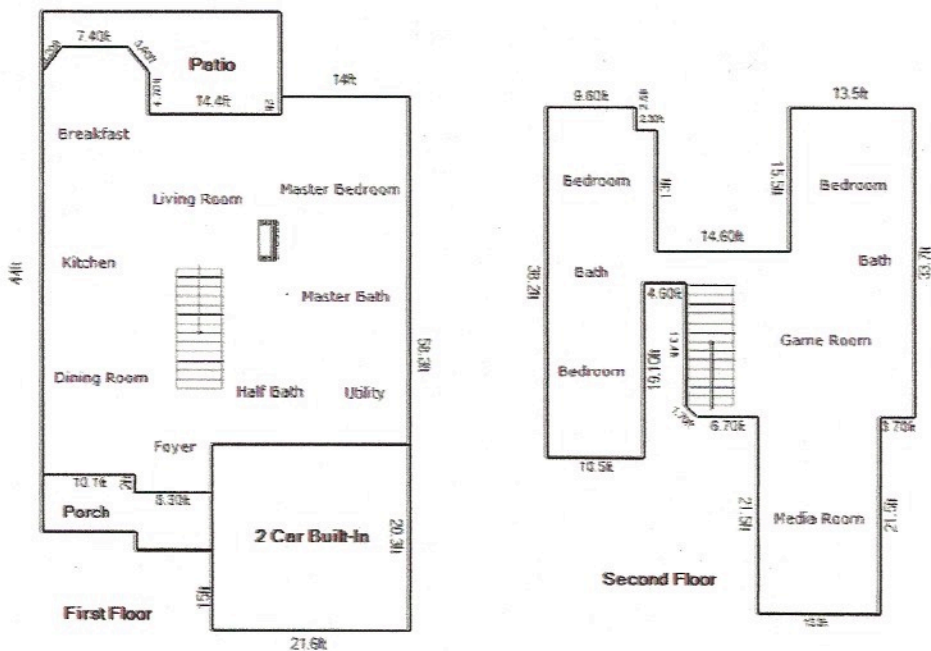

14 ft

| Living Area | | Area Calculation | | | |
|------------------------------|---------------|---------------------|--|--------|-------------------------|
| First Floor | 2063.05 sq ft | First Floor | | | x 1.00 = 2063.05 sq ft |
| 2 Car Built-In | -438.48 sq ft | 28 ft x 148 ft | | 1.00 = | 4112 sq ft |
| Second Floor | 1361.29 sq ft | 4.70 ft x 11.6 ft | | 1.00 = | 54.52 sq ft |
| Nonliving Area | | 39.3 ft x 40 ft | | 1.00 = | 1572 sq ft |
| Porch | 115.72 sq ft | 17 ft x 21.6 ft | | 1.00 = | 367.2 sq ft |
| Patio | 214.54 sq ft | 8.30 ft x 28 ft | | 1.00 = | 232.4 sq ft |
| | | 3.29 ft x 2.01 ft | | 0.40 = | 2.62 sq ft |
| | | 7.40 ft x 2.60 ft | | 1.00 = | 19.27 sq ft |
| | | 2.19 ft x 3.40 ft | | 0.38 = | 2.85 sq ft |
| | | 20.3 ft x 21.6 ft | | 1.00 = | 438.48 sq ft |
| 2 Car Built-In | -438.48 sq ft | | | | x -1.00 = -438.48 sq ft |
| Second Floor | 1361.29 sq ft | | | | x 1.00 = 1361.29 sq ft |
| | | 15.5 ft x 13.9 ft | | 1.00 = | 215.45 sq ft |
| | | 19.10 ft x 10.9 ft | | 1.00 = | 208.09 sq ft |
| | | 2.9 ft x 8.60 ft | | 1.00 = | 24.94 sq ft |
| | | 21.8 ft x 13.3 ft | | 1.00 = | 289.94 sq ft |
| | | 23.7 ft x 18.2 ft | | 1.00 = | 431.34 sq ft |
| | | 16.60 ft x 11.90 ft | | 1.00 = | 197.52 sq ft |
| | | 3.60 ft x 4.40 ft | | 1.00 = | 15.84 sq ft |
| | | 1.70 ft x 1.20 ft | | 0.35 = | 0.72 sq ft |
| Total Living Area (rounded): | 3005 sq ft | 13.4 ft x 1.20 ft | | 1.00 = | 16.08 sq ft |