

Building Sketch

Borrower	Kenneth Scott & Shellie Boyd				
Property Address	25428 Ramrock Dr				
City	Porter	County	Montgomery	State	TX
Zip Code	77365				
Lender/Client	Wells Fargo Bank NA				

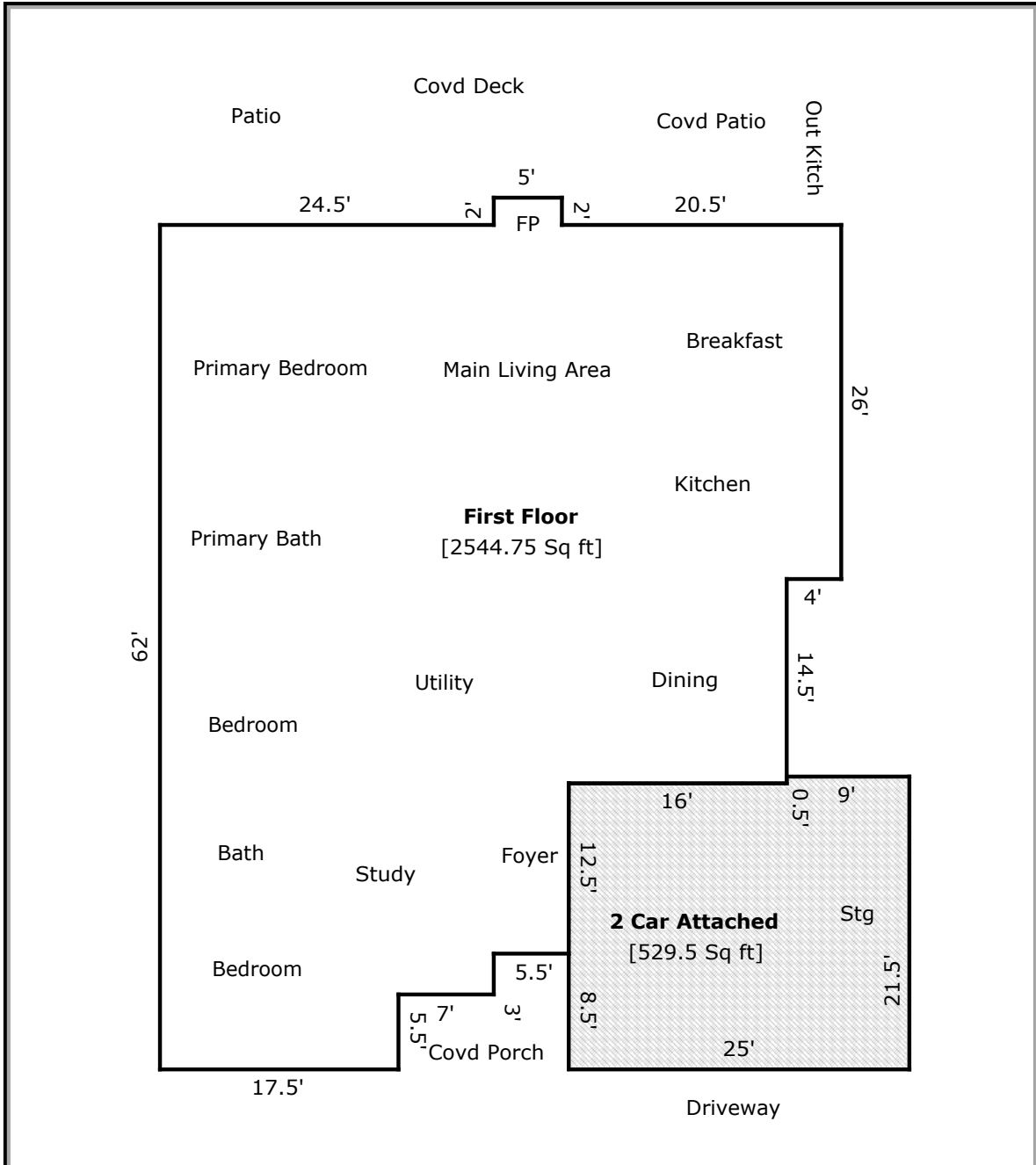

Living Area		Calculation Details
First Floor	2544.75 Sq ft	5 × 2 = 10 50 × 26 = 1300 15 × 16 = 240 30 × 27.5 = 825 8.5 × 17.5 = 148.75 3 × 7 = 21
Total Living Area (Rounded):		2545 Sq ft
Non-living Area		
2 Car Attached	529.5 Sq ft	25 × 21 = 525 9 × 0.5 = 4.5