

PEDRO VARELA A-30

FOREST GLADE COMMUNITY

WOOD PRIVACY FENCE

5/8" IRON ROD FOUND AT POST

$N6^{\circ}22'32"E$

179.55'

5/8" IRON ROD FOUND AT POST

SMALL PORTABLE STORAGE BLDG. 9.8' x 11.7'
WOOD STORAGE BLDG. 10.2' x 11.5'
WATER WELL
BACK SHOP 17.1' x 14'

CHAIN-LINK FENCE
 $N83^{\circ}57'52"W$
238.71'
ELECTRIC
GEORGE LEWIS ET UX
INSTRUMENT NO. 122143
L.C.D.R.

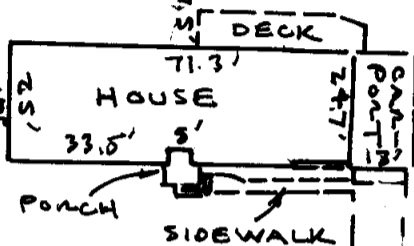

$S83^{\circ}57'52"E$
237.53'
RANDOM POST ALONG LINE

PATRICIA GAIL BOYD
CALLED 2 ACRES
VOL. 1179, PG. 232
L.C.D.R.

0.982 ACRE

J.T. SANDIFER ET UX
CALLED 1 ACRE
VOL. 968, PG. 474
L.C.D.R.

DRIVEWAY

GAS METER
WATER METER

1/2" IRON ROD SET

R.O.W LINE
5/8" IRON ROD FOUND AT UTILITY POLE

$S6^{\circ}00'00"W$

179.55'

(BASIS OF BEARING)
 $S6^{\circ}00'00"W$

COUNTY ROAD LCR 463

(OLD HWY. 14)

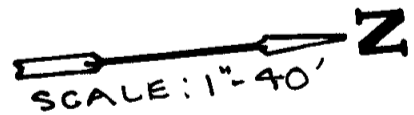

PLAT
0.982 ACRE TRACT
FOREST GLADE COMMUNITY
PEDRO VARELA SURVEY A-30
LIMESTONE COUNTY, TEXAS

Being all of that called 1.00 acre tract described in the deed recorded in Vol. 968, Pg. 474, Deed Records of Limestone County, Texas (L.C.D.R.)

Owner: J. T. Sandifer Estate



The plat hereon represents the facts found from that survey made on the ground under my supervision. Dated May 15, 2017.

Mark D. Haney

Mark D. Haney, R.P.L.S. No. 5841
Haney Surveying Services
201 Red Bird Lane Mexia, Texas
Tel. No. 254/562-69