

Legend:

- x-x-x-x-x- Fence
- Lot
- - - - - Building Line
- - - - - Easement
- Drive/Walk/Patio
- ▣ Retaining Wall
- ▨ Pad Area
- ▩ Slab/Porch
- Drainage Direction

Structural Options:

1. Roofing : 6:12 Pitch
2. 3rd Car Garage w/ 3X3 Stoop
3. Foundation: 3 Sides Brick

Lot Coverage Calculations:

Lot Area	21848 Sq. Ft.
Slab Area	2939 Sq. Ft.
Coverage Ratio	13%

Sod Calculation:

Front	181 Sq.Yd.
Side	85 Sq.Yd.
Rear	45 Sq.Yd.
Total	310 Sq.Yd.

Flatwork Areas:

Private Walk (A)	41 Sq. Ft.
Driveway (B)	964 Sq. Ft.
In-Turn (C)	335 Sq. Ft.
Public Walk (D)	0 Sq. Ft.
Conc. Patio (E)	9 Sq. Ft.
AC Pad	16 Sq. Ft.

General Notes:

1. The purpose of this plan is to show the proposed building footprint as defined by the metes and bounds of the recorded plat.
2. Dimensions, setbacks, easements, plan selection, and any other information shown here in shall be verified at permitting and prior to construction for accuracy and compliance with all applicable codes and ordinances.
3. Builder is solely responsible for ensuring that the footprint is contained within the prepared building pad. The building pad shall be set high enough to allow for adequate drainage.
4. All calculations are approximate. They must be verified prior to permitting, purchasing, and/or construction.

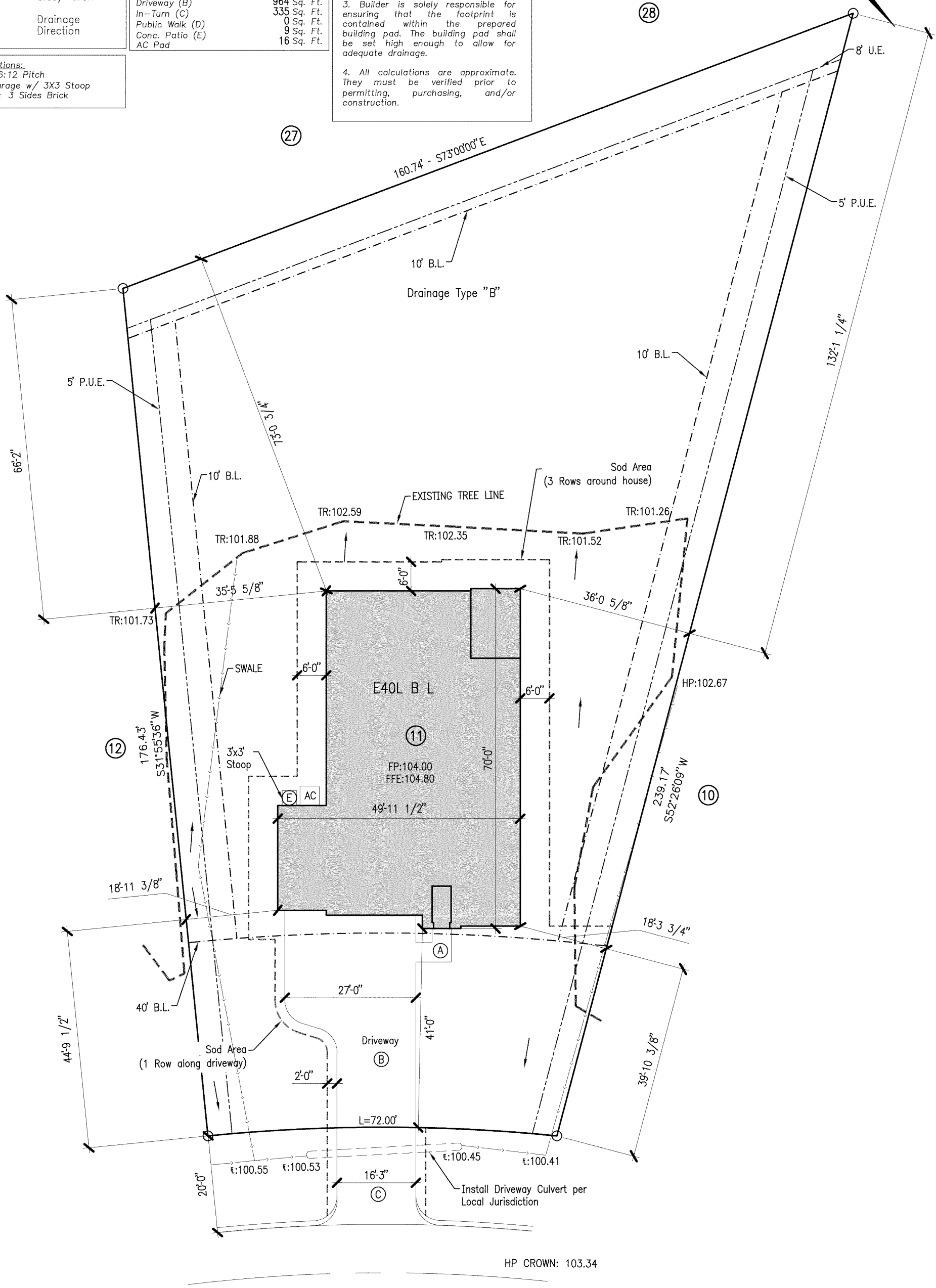
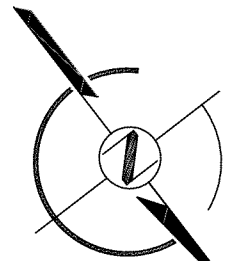

H:\House Plans\DR_Horton_Houston - North\Plot Plans\Roman Forest 4\E40L V5 BL LOT 11 BLK 6 (2141413PL).dwg 12/15/2021 4:48:37 PM Audit#: 1722

STRAND 2141413	PL1	DATE	8/24/21	BUILDER	DR Horton Houston North
		SCALE	1"=20'	SUBD.	Roman Forest Section IV
		DRN	J.P.X.	LOT	11 BLOCK 6
				ADDRESS	2908 Constantine
				CITY	Montgomery County, Texas
				PLAN	E40L B L
				VER.	5

PLOT PLAN

12/15/21

10003 Technology Blvd West
 Dallas, TX 75220
 972-520-8204
 Registration No. F-1629

STRAND

The use of these plans and specifications shall be restricted to the site for which they were prepared. Any reproduction or distribution is expressly limited to such use. Any other reproduction, reuse or disclosure by any method, in whole or in part, is prohibited. These drawings and specifications contain proprietary information and title remains in STRAND SYSTEMS ENGINEERING INC.