

- NOTES:**
- 1. ALL BEARINGS AND STREET ARE BASED ON RECORDED PLAT.
 - 2. UNDERGROUND ELECTRIC SERVICE AGREEMENT PER C.F. NO. 2012091838.
 - 3. FLOOD ZONE "X-SHADED" CASE #02-06-266P *L.O.M.C.* 08-22-2007.

PLAT OF LOT 4, BLOCK 1 OF SIENNA VILLAGE OF BEES CREEK, SECTION 5 ACCORDING TO THE PLAT RECORDED IN PLAT NO. 20120120 OF THE OFFICIAL RECORDS OF HARRIS COUNTY, TEXAS.

This survey is being provided solely for the use of the current parties and that no license has been created, express or implied, to copy the survey except as is necessary in conjunction with the original transaction.

PROPERTY LIES WITHIN FLOOD ZONE "X-SHADED", ACCORDING TO F.I.R.M. MAP NO. 02-06-266P, DATE 08-22-02, BY GRAPHING PLOTTING ONLY, WE DO NOT ASSUME RESPONSIBILITY FOR EXACT DETERMINATION. BEFORE ANY DEVELOPMENT PLANNING, DESIGN, OR CONSTRUCTION IS STARTED, THE COMMUNITY, CITY AND COUNTY IN WHICH SUBJECT TRACT EXISTS SHOULD BE CONTACTED. SAID ENTITIES MAY IMPOSE LARGER FLOOD PLAIN AND FLOODWAY AREAS THAN SHOWN BY F.I.R.M. MAPS THAT WILL AFFECT DEVELOPMENT.

PROPERTY SUBJECT TO SUBDIVISION COVENANTS, CONDITIONS AND RESTRICTIONS.

I hereby certify that this survey was made on the ground and that this plat correctly represents the facts found at the time of survey showing any improvements, from legal descriptions supplied by client. There are no encroachments apparent on the ground, except as shown. This survey is only certified for boundary and this transaction only. Surveyor did not abstract property. Easements, building lines, etc. shown are as identified by:

GF 902-57815 of COMMONWEALTH LAND TITLE INSURANCE COMPANY

Fred W. Lawton, Registered Professional Land Surveyor No. 2321

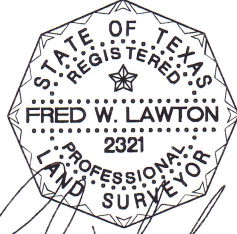

ADDRESS: 31 FORT ARBOR LANE LENDER:
 CITY: MISSOURI CITY, TEXAS ZIP: 77459
 PURCHASER: VLADIMIR GRECHKA AND JACKIE LYNN KERMODE
 JOB NO: NM25773 DATE: 01-18-13 SCALE: 1"=30'-00" REVISION: Key Map 649D

SOUTH TEXAS SURVEYING ASSOCIATES, INC.
 11281 Richmond Ave. Suite J-101 Houston, Texas 77082
 TEL. (281) 556-6918 FAX (281) 556-9331

Copyright 2013 South Texas Surveying Associates, Inc. M.C.