

Building Sketch

Borrower	Wohlwend, Samuel & Jessica		
Property Address	6802 Grapevine Trl		
City	Richmond	County	FORT BEND
		State	TX
		Zip Code	77407
Lender/Client	Frost Bank		

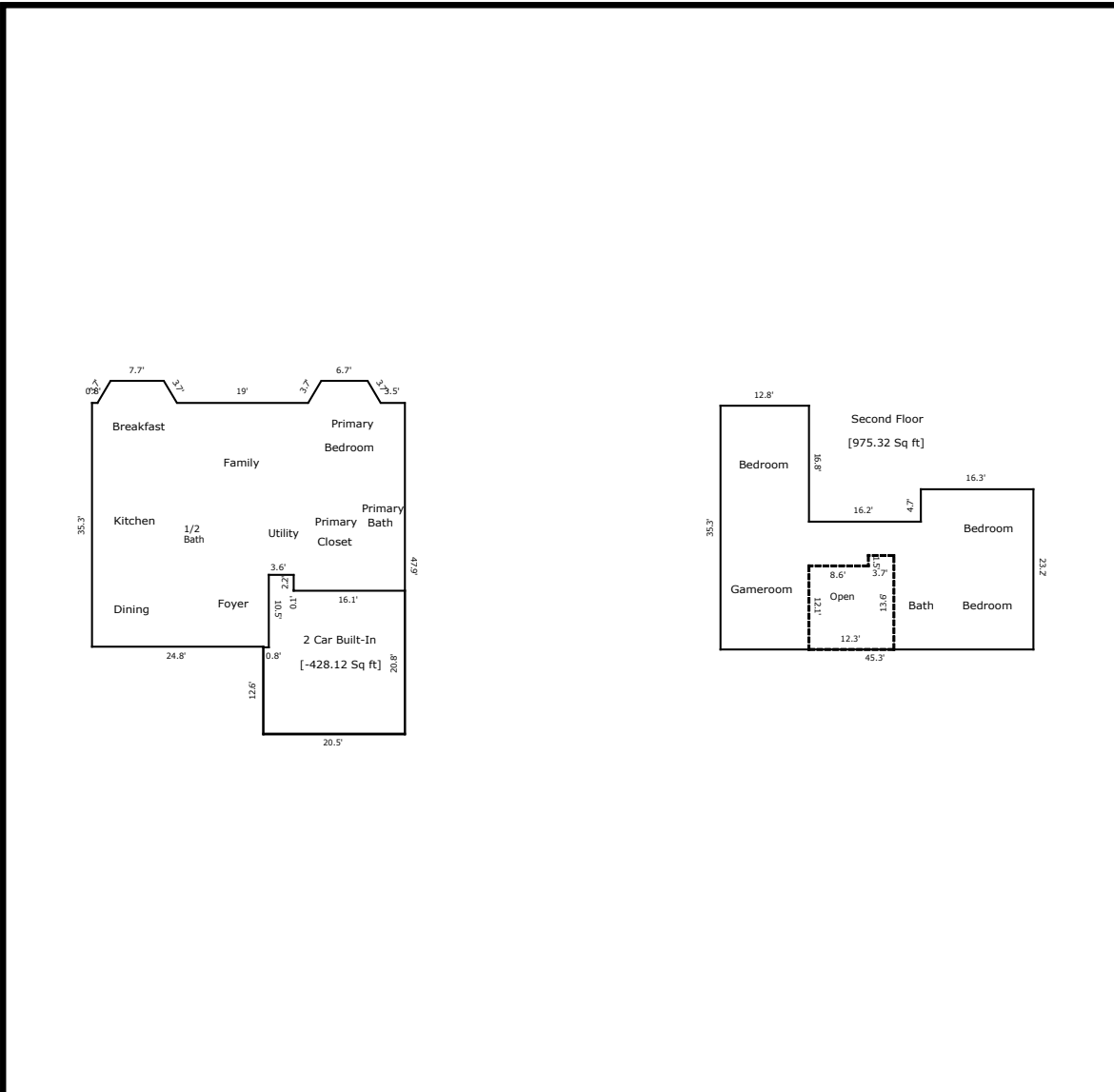

TOTAL Sketch by a la mode, inc.

Area Calculations Summary

Living Area	Area	Calculation Details
2 Car Built-In	-428.1 Sq ft	$20.8 \times 16.1 = 334.9$ $4.4 \times 12.6 = 55.4$ $3.6 \times 10.5 = 37.8$
First Floor	1915.6 Sq ft	$0.5 \times 1.9 \times 3.2 = 3$ $0.5 \times 3.2 \times 1.9 = 3$ $6.7 \times 3.2 = 21.4$ $0.5 \times 1.9 \times 3.2 = 3$ $0.5 \times 3.2 \times 1.9 = 3$ $7.7 \times 3.2 = 24.6$ $45.3 \times 35.3 = 1599.1$ $12.6 \times 20.5 = 258.3$
Second Floor	1129.7 Sq ft	$12.8 \times 16.8 = 215$ $23.2 \times 16.3 = 378.2$ $29 \times 18.5 = 536.5$
Open to Below	-154.4 Sq ft	$12.3 \times 12.1 = 148.8$ $3.7 \times 1.5 = 5.6$
Total Living Area (Rounded):	2463 Sq ft	