

ADDRESSES
3614 Clingby Lane
Parsippany, N.J. 07054

LEGAL DESCRIPTION (AS FURNISHED)
Lot 7 in Block 2, Parkway 5 subdivision, Section 1, according to the map of said thereof, recorded in Vol. 15, Page 377 and 378, H.L.C. Ch.

NOTES
1) Positive Observations and Data of Reference

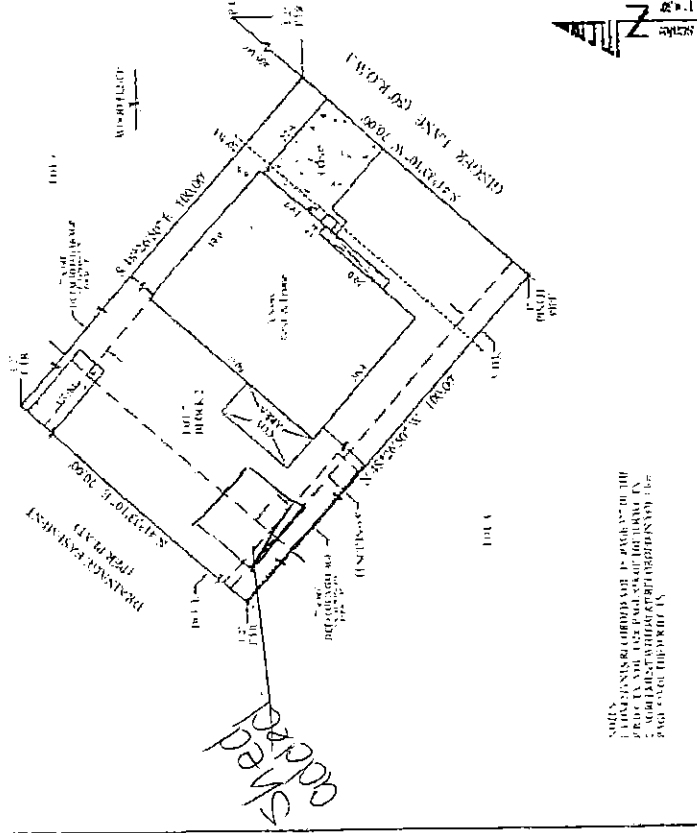

NOTES
1) POSITIVE OBSERVATIONS AND DATA OF REFERENCE
2) THIS SURVEY IS BASED ON THE RECORDS OF THE COUNTY CLERK'S OFFICE AND THE RECORDS OF THE COUNTY ENGINEER'S OFFICE.
PAGE THREE THEREOF IS

BASIS OF MEASUREMENT BEARING BASED ON THE RECORDED PLAT

TITLE COMPANY:

MAP DESIGN
Chicago Title Insurance Company
200 North Dearborn Street
Chicago, Illinois 60610

CLIENT: 05/14/07
SURVEY FILE #: 01005
SURVEY NUMBER: 4804
SURVEYOR: TJS
DRAFTER: CMM
APPROVED: WJW

CERTIFIED TO: (AS FURNISHED)
Surveying Company
Surveying License No. 10000

THIS SURVEY WAS MADE BY THE SURVEYOR IN THE FIELD AND IS THE RESULT OF HIS PERSONAL OBSERVATION AND MEASUREMENTS.

DATE: 05/14/07

SCALE: AS SHOWN

SURVEYOR INFORMATION:

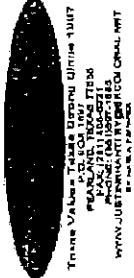

Ward D. Kelsey
Professional Surveyor
New Jersey License No. 4804

Trane Valve, Trane Control Unit, Trane
Packaged, Trane, Trane
WYNN JUSTINIANI WYNN JUSTINIANI
BY: WYNN JUSTINIANI

FLOOD ZONE
FOR INFORMATION PURPOSES ONLY
THIS SURVEY WAS MADE IN ACCORDANCE WITH THE
REQUIREMENTS OF THE STATE OF NEW JERSEY
THE DATA INFORMATION IS ONLY FOR INFORMATION PURPOSES
AND DOES NOT CONSTITUTE A WARRANTY OR GUARANTEE

SURVEYOR'S CERTIFICATE

I hereby certify that the above is a true and correct copy of the survey as shown on the attached plan and that the same was made by me or under my direct supervision and that I am a duly licensed Surveyor in the State of New Jersey.

WARD D. KELSEY
Professional Surveyor
New Jersey License No. 4804

DATE: 05/14/07

REVISION: _____

DATE: _____

REVISION: _____

