

INVOICE

FROM:

Dunlap Appraisal Services
 2210 Lashley Ct
 Katy, TX 77450

Telephone Number: 281-352-1925

Fax Number:

TO:

Melissa Reyes

E-Mail: MelissaReyes@kw.com

Telephone Number: 713-492-7890

Fax Number:

Alternate Number:

INVOICE NUMBER

1089

DATES

Invoice Date: 03/08/2022

Due Date:

REFERENCE

Internal Order #:

Lender Case #:

Client File #:

FHA/VA Case #:

Main File # on form: 1089

Other File # on form:

Federal Tax ID:

Employer ID:

DESCRIPTION

Lender:	N/A	Client:	
Purchaser/Borrower:	N/A		
Property Address:	20730 Kendra Ln		
City:	Katy		
County:	Harris	State:	TX
Legal Description:	Lot 42, Block 3, Section 9, Nottingham Country	Zip:	77450

FEES

AMOUNT

Sketch only	200.00
SUBTOTAL	200.00

PAYMENTS

AMOUNT

Check #: 6790	Date: 03/07/2022	Description: paid in full	200.00
Check #:	Date:	Description:	
Check #:	Date:	Description:	
SUBTOTAL			200
TOTAL DUE			\$ 0.00

Building Sketch

Borrower	N/A			
Property Address	20730 Kendra Ln			
City	Katy	County Harris	State TX	Zip Code 77450
Lender/Client	N/A			

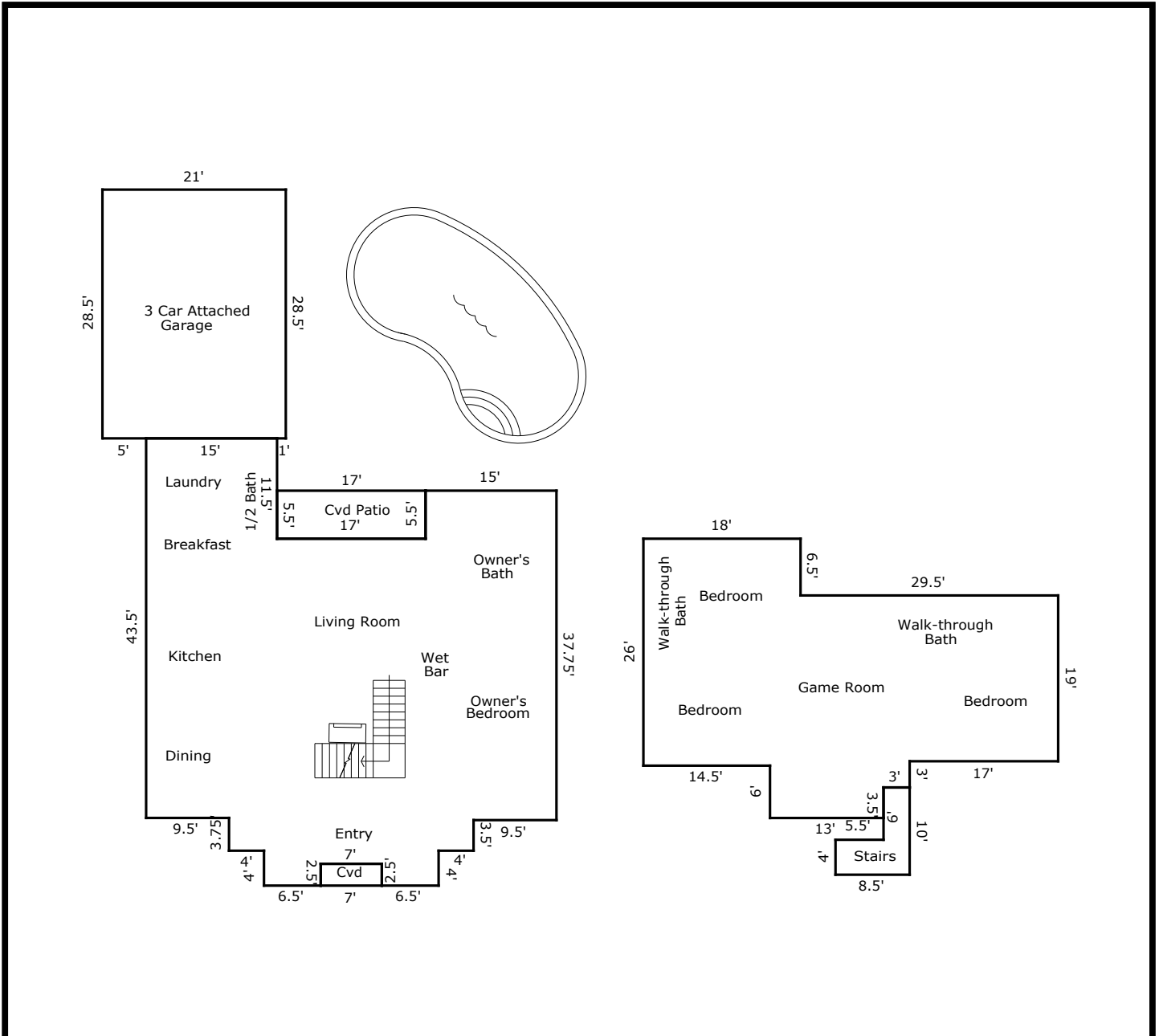

TOTAL Sketch by a la mode, inc.

Area Calculations Summary

Living Area	Calculation Details	
First Floor	1928.88 Sq ft	
		15 × 11.5 = 172.5
		15 × 5.5 = 82.5
		47 × 32 = 1504
		37.5 × 0.25 = 9.38
		28 × 3.5 = 98
		20 × 1.5 = 30
		6.5 × 2.5 = 16.25
		6.5 × 2.5 = 16.25
Second Floor	1120.25 Sq ft	
		19 × 17 = 323
		26 × 14.5 = 377
		3.5 × 6.5 = 22.75
		16 × 22 = 352
		13 × 3.5 = 45.5
Second Floor	52 Sq ft	
		4 × 5.5 = 22
		10 × 3 = 30
Total Living Area (Rounded):		3101 Sq ft
Non-living Area		
Concrete Patio	93.5 Sq ft	5.5 × 17 = 93.5
3 Car Attached	598.5 Sq ft	28.5 × 21 = 598.5
Open Porch	17.5 Sq ft	2.5 × 7 = 17.5

Appraisal License

MELISSA ANNE DUNLAP
2210 LASHLEY COURT
KATY, TX 77450



Certified General Real Estate Appraiser

Appraiser: **Melissa Anne Dunlap**

License #: **TX 1329787 G**

License Expires: **11/30/2022**

Having provided satisfactory evidence of the qualifications required by the Texas Appraiser Licensing and Certification Act, Occupations Code, Chapter 1103, authorization is granted to use this title:
Certified General Real Estate Appraiser

For additional information or to file a complaint please contact TALCB at www.talcb.texas.gov.

A handwritten signature in blue ink that reads 'Chelsea Buchholtz'.

Chelsea Buchholtz
Commissioner