

Building Sketch (Page - 1)

Borrower	N/A				
Property Address	20399 Presley Grove Dr				
City	Porter	County	Montgomery	State	TX
				Zip Code	77365
Lender/Client	Scott and Debbie Brown				

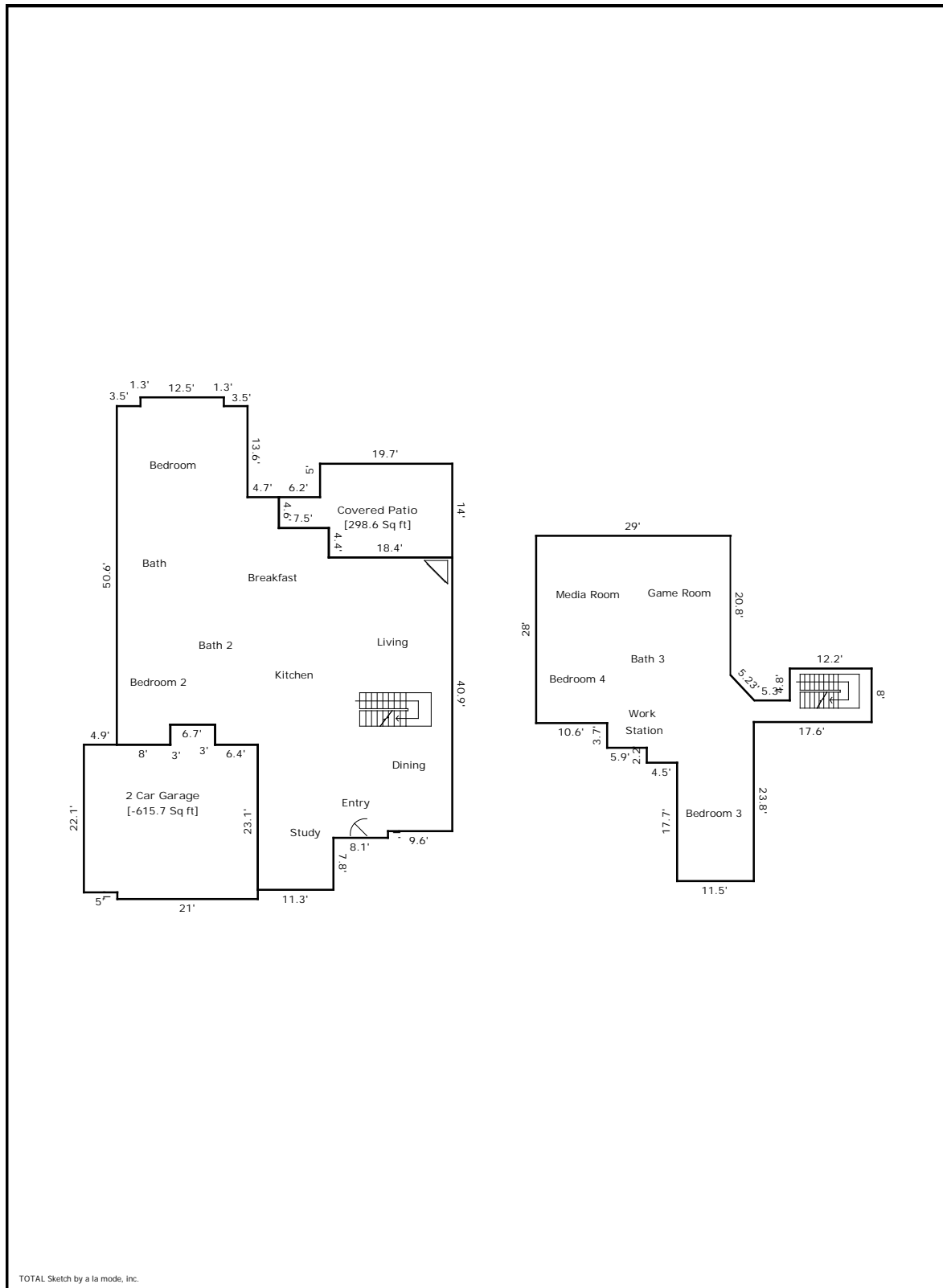

Building Sketch (Page - 2)

Borrower	N/A				
Property Address	20399 Presley Grove Dr				
City	Porter	County	Montgomery	State	TX
Lender/Client	Scott and Debbie Brown				
				Zip Code	77365

Living Area		Calculation Details
First Floor	2396.59 Sq ft	$12.5 \times 1.3 = 16.25$ $19.5 \times 13.6 = 265.2$ $11.3 \times 7.8 = 88.14$ $40.9 \times 9.6 = 392.64$ $19.4 \times 13.9 = 269.66$ $28 \times 8.8 = 246.4$ $32.4 \times 7.5 = 243$ $24.2 \times 34 = 822.8$ $3 \times 9.5 = 28.5$ $3 \times 8 = 24$
2 Car Garage	-615.7 Sq ft	$6.7 \times 3 = 20.1$ $23.1 \times 21 = 485.1$ $22.1 \times 5 = 110.5$
Second Floor	1265.4 Sq ft	$11.5 \times 17.7 = 203.55$ $16 \times 2.2 = 35.2$ $21.9 \times 3.7 = 81.03$ $32.5 \times 0.2 = 6.5$ $50.1 \times 3.2 = 160.32$ $12.2 \times 4.8 = 58.56$ $0.5 \times 3.8 \times 3.6 = 6.84$ $29 \times 3.8 = 110.2$ $29 \times 20.8 = 603.2$
Total Living Area (Rounded):	3662 Sq ft	
Non-living Area		
Covered Patio	298.6 Sq ft	$14 \times 18.4 = 257.6$ $4.6 \times 6.2 = 28.52$ $9.6 \times 1.3 = 12.48$

ABBIE GAIL HAWKINS
6607 EMERALD ASH COURT
HUMBLE, TX 77346



**Certified Residential
Real Estate Appraiser**

Appraiser: **ABBIE GAIL HAWKINS**
License #: **TX 1338340 R** License Expires: **03/31/2023**

Having provided satisfactory evidence of the qualifications required by the Texas Appraiser Licensing and Certification Act, Occupations Code, Chapter 1103, authorization is granted to use this title:
Certified Residential Real Estate Appraiser

For additional information or to file a complaint please contact TALCB at www.talcb.texas.gov.



Chelsea Buchholtz
Commissioner