

<b>Structural Options:</b>	
1. Roofing : 6:12 Pitch	
2. 3rd Car Garage w/ 3x3 stoop	
3. Foundation: 3 Sides brick	
<b>Lot Coverage Calculations:</b>	
Lot Area	30000 Sq. Ft.
Slab Area	2717 Sq. Ft.
Coverage Ratio	9%
<b>Sod Calculation:</b>	
Front	433 Sq.Yd.
Side	84 Sq.Yd.
Rear	40 Sq.Yd.
Total	557 Sq.Yd.
<b>Flatwork Areas:</b>	
Private Walk (A)	31 Sq. Ft.
Driveway (B)	1082 Sq. Ft.
In-Turn (C)	335 Sq. Ft.
Public Walk (D)	0 Sq. Ft.
Conc. Patio (E)	9 Sq. Ft.
AC Pad	16 Sq. Ft.

**General Notes:**

- The purpose of this plan is to show the proposed building footprint as defined by the metes and bounds of the recorded plat.
- Dimensions, setbacks, easements, plan selection, and any other information shown here in shall be verified at permitting and prior to construction for accuracy and compliance with all applicable codes and ordinances.
- Builder is solely responsible for ensuring that the footprint is contained within the prepared building pad. The building pad shall be set high enough to allow for adequate drainage.
- All calculations are approximate. They must be verified prior to permitting, purchasing, and/or construction.

**Legend:**

-x-x-x-x-	Fence
—	Lot
- - - - -	Building Line
- · - · - · -	Easement
—	Drive/Walk/Patio
█	Retaining Wall
▨	Pad Area
■	Slab/Porch
→	Drainage Direction

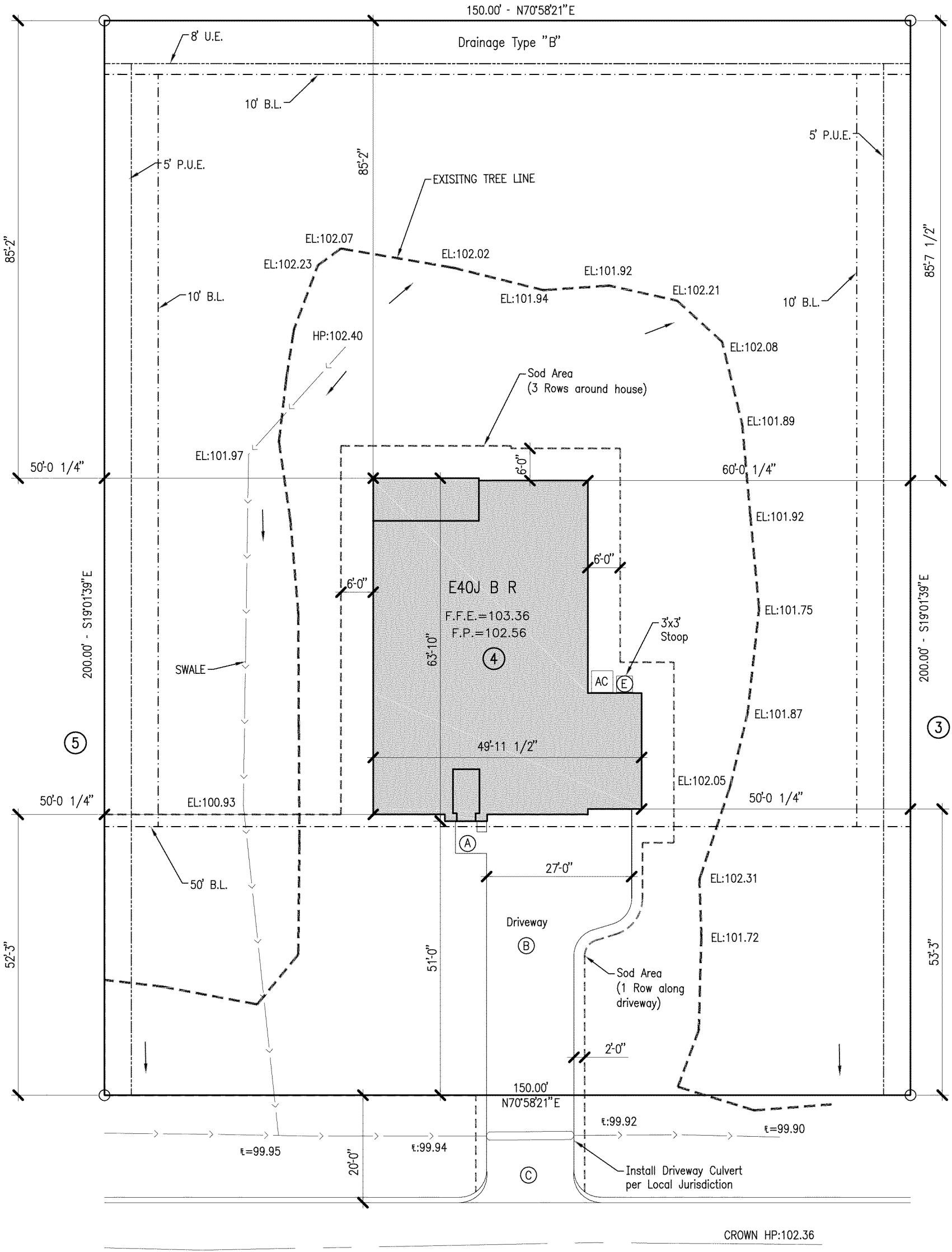
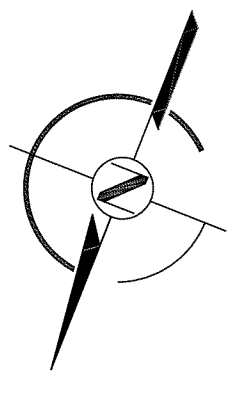

H:\House\_Plans\DR\_Horton\_Houston - North\Plot Plans\Roman Forest 4\E40J BR LOT 4 BLK 6 (2136309PL2).dwg 2/10/2022 10:54:02 AM Audit#: 7797

<b>PL1</b>	DATE	2/10/22
	SCALE	1"=20'
STRAND 2136309R2	DRN	KP

BUILDER	DR Horton Houston North
SUBD.	Roman Forest Section IV
LOT	4 BLOCK 6
ADDRESS	2802 Roman Forest Blvd
CITY	Montgomery County, Texas
PLAN	E40J B R
VER.	5

**PLOT PLAN**

KMP  
2/10/22

10003 Technology Blvd West  
Dallas, TX 75220  
972-620-8204  
Registration No. F-1629

