

Legend:	
	Fence
	Lot
	Building Line
	Easement
	Drive/Walk/Patio
	Retaining Wall
	Pad Area
	Slab/Porch
	Drainage Direction

Structural Options:
 1. Foundation: 3 Sides Brick.
 2. Roofing : 6:12 Pitch
 3. 3rd Car Garage W/ 3'X3' Stoop

General Notes:

- The purpose of this plan is to show the proposed building footprint as defined by the metes and bounds of the recorded plat.
- Dimensions, setbacks, easements, plan selection, and any other information shown here in shall be verified at permitting and prior to construction for accuracy and compliance with all applicable codes and ordinances.
- Builder is solely responsible for ensuring that the footprint is contained within the prepared building pad. The building pad shall be set high enough to allow for adequate drainage.
- All calculations are approximate. They must be verified prior to permitting, purchasing, and/or construction.

Lot Coverage Calculations:	
Lot Area	20500 Sq. Ft.
Slab Area	2717 Sq. Ft.
Coverage Ratio	13%
Sod Calculation:	
Front	234 Sq.Yd.
Side	84 Sq.Yd.
Rear	40 Sq.Yd.
Total	358 Sq.Yd.
Flatwork Areas:	
Private Walk (A)	31 Sq. Ft.
Driveway (B)	920 Sq. Ft.
In-Turn (C)	335 Sq. Ft.
Public Walk (D)	0 Sq. Ft.
Conc. Patio (E)	9 Sq. Ft.
AC Pad	16 Sq. Ft.

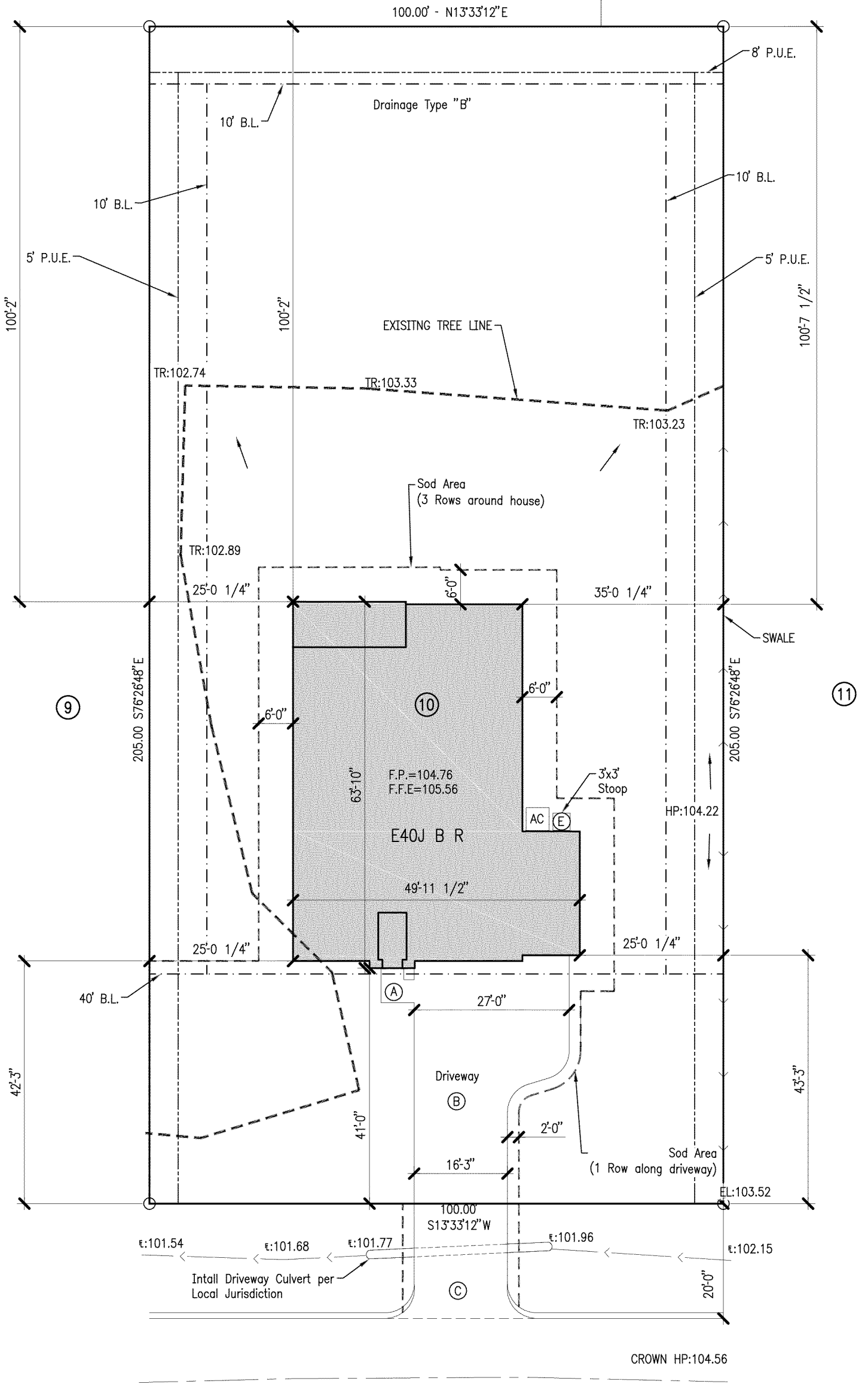
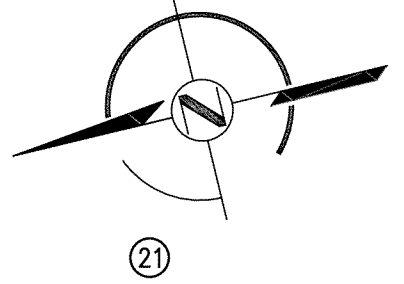

House Plans\DR Horton Houston - North\Plot Plans\Roman Forest 4\E40J V5 BR LOT 10 BLK 10 (2141851PL).dwg 1/14/2022 4:34:30 PM Audit#: 9691

STRAND 2141851	PL1	DATE	8/24/21	BUILDER	DR Horton Houston North	VER. 5	PLOT PLAN	 1/17/22	10003 Technology Blvd West Dallas, TX 75220 972-620-8204 Registration No. F-1629	STRAND
		SCALE	1"=20'	SUBD.	Roman Forest Section IV					
		DRN	X.X.S.	LOT	10 BLOCK 10					
				ADDRESS	822 Forest View					
				CITY	Montgomery County, Texas					
				PLAN	E40J B R					

The use of these plans and specifications shall be restricted to the site for which they were prepared. Any reproduction or distribution is expressly limited to such use. Any other reproduction, reuse or disclosure by any method, in whole or in part, is prohibited. These drawings and specifications contain proprietary information and title remains in STRAND SYSTEMS ENGINEERING INC.