

SCALE: 1" = 100'

GF NO. 565615 STEWART TITLE  
 ADDRESS: 722 LAGO TRACE DRIVE  
 HUFFMAN, TEXAS 77336  
 BORROWER: KOKOU AMEGA

**LOTS 7 AND 8, BLOCK 7  
 COMMONS OF LAKE HOUSTON  
 SECTION 1**

ACCORDING TO THE MAP OR PLAT THEREOF RECORDED  
 UNDER FILM CODE NO. 362101 OF THE MAP RECORDS  
 OF HARRIS COUNTY, TEXAS

NOTE: SUBJECT TO ALL EASEMENTS AND SET BACK LINES AS REFLECTED UNDER AMENDED, RESTATED AND CONSOLIDATED DECLARATION PER CF NO. Y503501.  
 NOTE: RIGHT OF WAY AND EASEMENT WITH FREE INGRESS AND EGRESS PER CF NO. P-412800.  
 NOTE: UNLOCATED RAILROAD RIGHT OF WAY PER VOL. 182, PG. 469, VOL. 542, PG. 15 AND VO. 128, PG. 217.

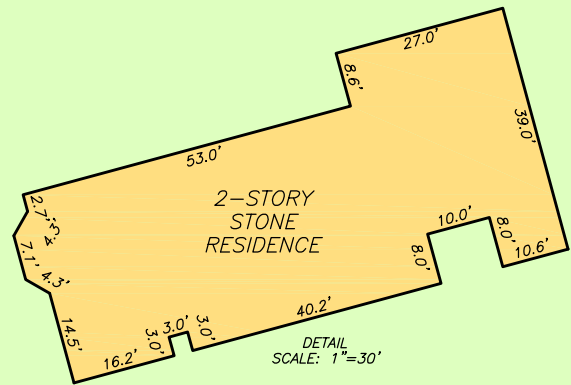

THIS PROPERTY DOES NOT LIE WITHIN THE 100 YEAR FLOOD PLAIN AS PER FIRM PANEL NO. 48201C 0330 L MAP REVISION: 06/18/2007 ZONE X  
 BASED ONLY ON VISUAL EXAMINATION OF MAPS. INACCURACIES OF FEMA MAPS PREVENT EXACT DETERMINATION WITHOUT DETAILED FIELD STUDY.

A SUBSURFACE INVESTIGATION WAS BEYOND THE SCOPE OF THIS SURVEY

D.C.L. = DIRECTIONAL CONTROL LINE  
 RECORD BEARING: F.C. NO. 362101 H.C.M.R. DRAWN BY: MM

I HEREBY CERTIFY THAT THIS SURVEY WAS MADE ON THE GROUND, THAT THIS PLAT CORRECTLY REPRESENTS THE FACTS FOUND AT THE TIME OF SURVEY AND THAT THERE ARE NO ENCROACHMENTS APPARENT ON THE GROUND, EXCEPT AS SHOWN HEREON. THIS SURVEY IS CERTIFIED FOR THIS TRANSACTION ONLY AND ABSTRACTING PROVIDED IN THE ABOVE REFERENCED TITLE COMMITMENT WAS RELIED UPON IN PREPARATION OF THIS SURVEY.

GEORGE GALE  
 PROFESSIONAL LAND SURVEYOR  
 NO. 4678  
 JOB NO. 19-10596  
 DECEMBER 09, 2019

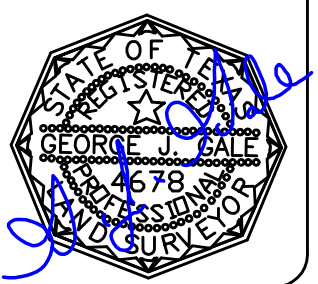

**stewart**  
 title  
 VANESSA DILLON  
 281-359-1280



**PRECISION**  
 surveyors

1-800-LANDSURVEY  
 www.precisionssurveyors.com  
 281-496-1586 FAX 281-496-1867 210-829-4941 FAX 210-829-1555  
 950 THREADNEEDLE STREET SUITE 150 HOUSTON, TEXAS 77079 1777 NE LOOP 410 SUITE 600 SAN ANTONIO, TEXAS 78217  
 FIRM NO. 10063700