

D 1/2" IRON ROD  
2" IRON ROD  
FENCE  
LEAD ELECTRIC LINE

Erica A. Padilla  
remainder of 13.8 Acres  
Vol. 504, Pg. 718 of the  
Llave County Official Records)

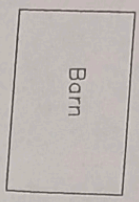

Barn

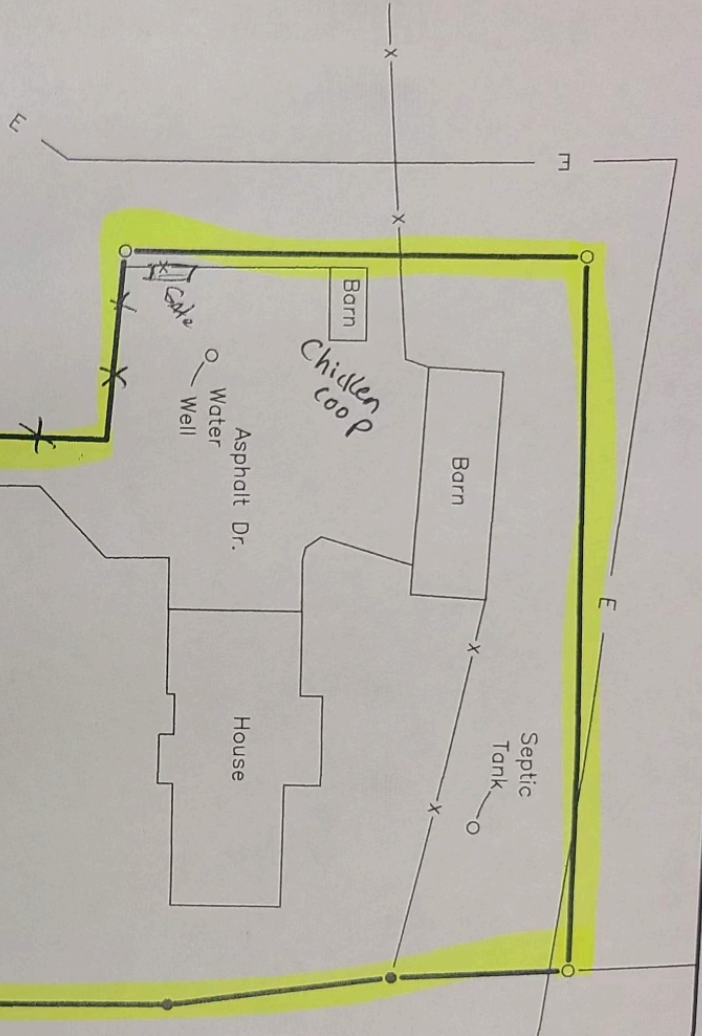

Chicken coop

Barn

Barn

Asphalt Dr.

House

Septic Tank

Water Well

Gate

Driveway

1.0 ACRES

JAMES KERR SURVEY  
(A-24)

SCALE: 1"=50'



Bruce Schimick, at ux  
2.48 Acres  
(Vol. 456, Pg. 325 of the  
Lavaca County Official Records)

Public Road (LCR 172)

Public Road (Farm Road No. 318)

J.P.L.S. \* 3465 US HIGHWAY 90A E \* HALLETTSVILLE TEXAS 77964 (361-798-5208)