

FIRST FLOOR PLAN

HANDRAILS AND GUARDRAILS TABLE 503.5.1 FOOTING D IRC 2012
 HANDRAILS AND GUARDRAILS SHALL BE DESIGNED FOR A MINIMUM
 200LB LIVE LOAD AND A SINGLE CONCENTRATED LOAD APPLIED IN
 ANY DIRECTION AT ANY POINT ALONG THE TOP

14'-0"

ALL ANGLES 45° UNLESS NOTED

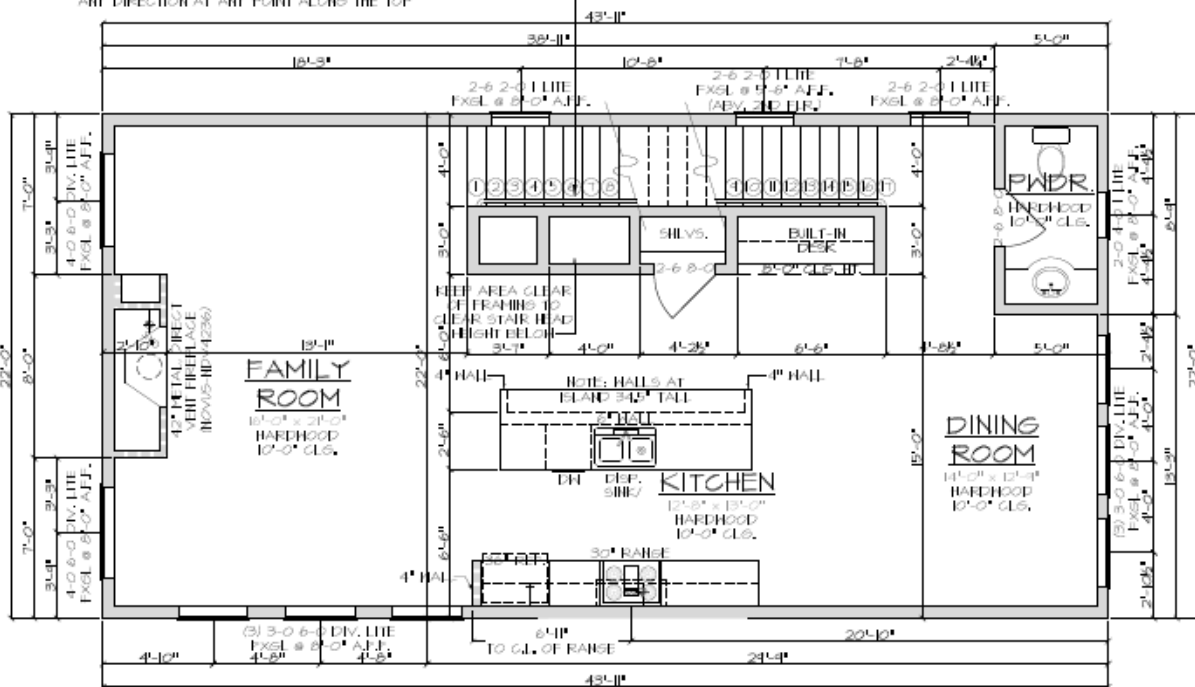

SECOND FLOOR PLAN

14'-0"

ALL ANGLES 45° UNLESS NOTED