

Charlyn Jensen
109 Sundrop Ridge Ct
Woodforest 60

inspired

Granada 2,374 SQ. FT. FIRST FLOOR

Home Run RG6 for
Camera DVR to be
connected &
Conduit
Conduit @ 6' AFF by
Electric Outlet

Camera Prewire @ Soffit
(1 CAT5e, 1 RG6 & 1 16/2)

Homerun Surround Sound,
Patio Audio & Conduit
Conduit @ 5.5' AFF
By Electric Outlet

In-Wall Safe Location:
Pre-construction wall
box @ 34" aff.
Prewire security
contact wire

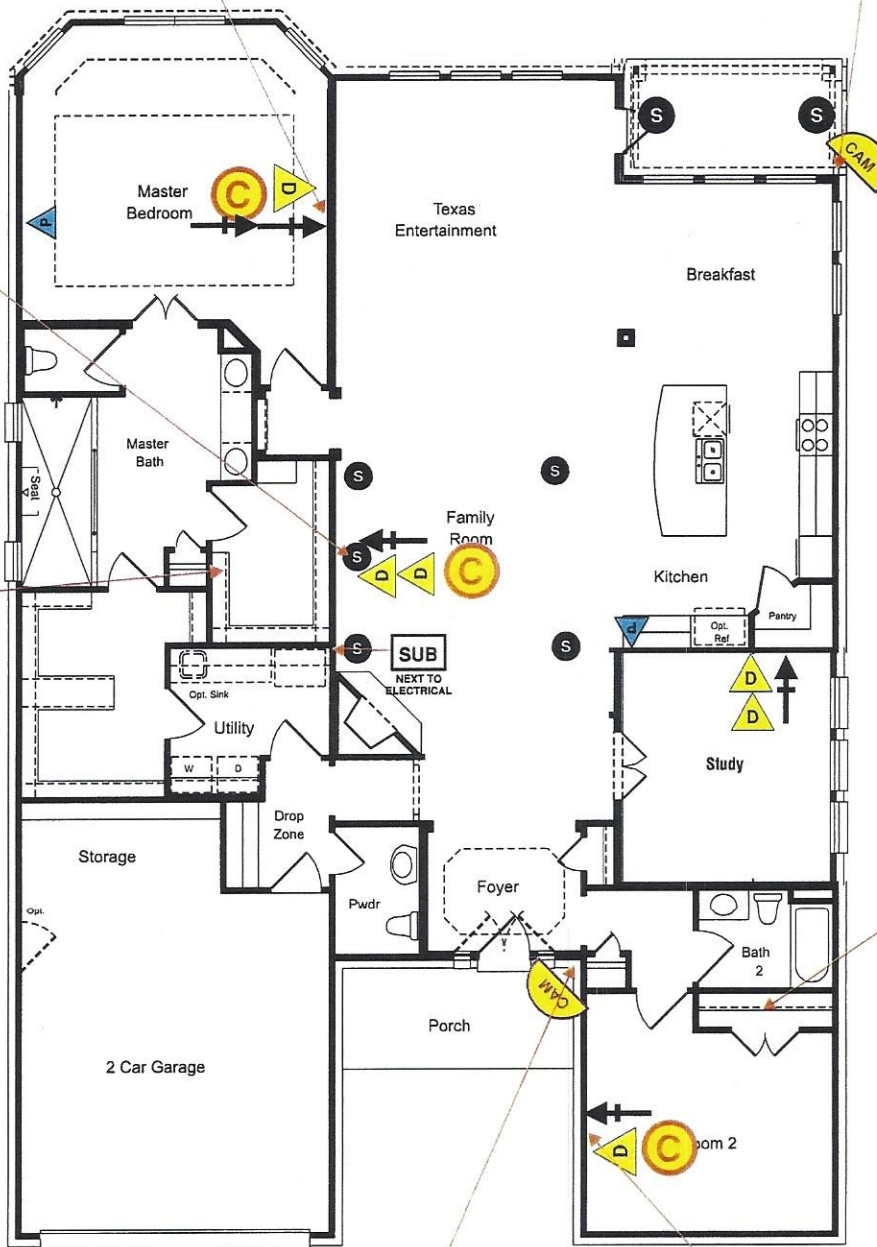

- Phone/Cable
- HOH (2-data/1-cable)
- Phone
- Data
- Cable
- Phone/Data
- Quad (2-data/2-cable)
- 3-Phone/1-Cable
- Conduit
- In-Ceiling Speaker
- In-Wall Speaker
- Subwoofer
- HDMI
- Carbon Monoxide
- GlassBreak Detector
- Smoke Detector
- Motion Detector

Taylor Morrison Premium
28" Panel @ 34" aff.
1 - 1" Conduit Run to the
Dmark from Panel
1- 1.5" Conduit from Panel
to Attic
Demarc:
(2) CAT5e, (2) RG6

- ✓ Prewire
- ✓ Security
- ✓ Camera's
- ✓ TV's
- ✓ Home Theater
- ✓ Music Audio
- ✓ Central Vacuum
- ✓ Home Automation

Camera Prewire @ 8ft aff
Near Corner
(1 CAT5e, 1 RG6 & 1 16/2)

Home Run Conduit
Conduit @ 6' AFF by
Electric Outlet

****SECURITY TRIM****
All first floor operable
windows and any roof
accessible operable
windows on higher
floors.
Then, all operable
pedestrian doors.

Charlyn Jensen 1-19-18
SIGNATURE DATE



Offer void where prohibited by law. All information (including, but not limited to prices, availability, incentives, floor plans, site plans, features, standards and options, assessments and fees, planned amenities, programs, conceptual artists' renderings and community development plans) is not guaranteed and remains subject to change or delay without notice. Maps and plans are not to scale and all dimensions are approximate. Please see a Taylor Morrison sales associate for details and visit www.taylormorrison.com for additional disclaimers. © January 2018. All rights reserved.