

U.S. DEPARTMENT OF HOMELAND SECURITY
 FEDERAL EMERGENCY MANAGEMENT AGENCY
 National Flood Insurance Program

ELEVATION CERTIFICATE

IMPORTANT: FOLLOW THE INSTRUCTIONS ON PAGES 8-15

OMB Control Number: 1660-0008
 Expiration: 11/30/2018

Copy all pages of this Elevation Certificate and all attachments for (1) community official, (2) insurance agent/company, and (3) building owner.

| SECTION A - PROPERTY INFORMATION | | | | FOR INSURANCE COMPANY USE | |
|---|--|-------------|---|--|--|
| A1. Building Owner's Name JKD INDUSTRIES, LLC | | | 1802144 | Policy Number: | |
| A2. Building Street Address (including Apt., Unit, Suite, and/or Bldg. No.) or P.O. Route and Box No. 36704 BRONCHO ROAD | | | Company NAIC Number: | | |
| City WALLIS | | State TEXAS | | Zip Code 77485 | |
| A3. Property Description (Lot and Block Numbers, Tax Parcel Number, Legal Description, etc.) BRAZOS VALLEY SEC 2, BLOCK 33, LOT 9 | | | | | |
| A4. Building Use (e.g., Residential, Non-Residential, Addition, Accessory, etc.) RESIDENTIAL | | | | | |
| A5. Latitude/Longitude: Lat. 29°40'45.25" N Long. 95°59'54.13" W Horizontal Datum: <input type="radio"/> NAD 1927 <input checked="" type="radio"/> NAD 1983 | | | | | |
| A6. Attach at least 2 photographs of the building if the Certificate is being used to obtain flood insurance. | | | | | |
| A7. Building Diagram Number <u>1A</u> | | | | | |
| A8. For a building with a crawlspace or enclosure(s): | | | A9. For a building with an attached garage: | | |
| a) Square footage of crawlspace or enclosure(s) | | <u>N/A</u> | sq ft | a) Square footage of attached garage <u>N/A</u> sq ft | |
| b) Number of permanent flood openings in the crawlspace or enclosure(s) within 1.0 foot above adjacent grade | | <u>N/A</u> | | b) Number of permanent flood openings in the attached garage within 1.0 foot above adjacent grade <u>N/A</u> | |
| c) Total net area of flood openings in A8.b | | <u>N/A</u> | sq in | c) Total net area of flood openings in A9.b <u>N/A</u> sq in | |
| d) Engineered flood openings? <input type="radio"/> Yes <input checked="" type="radio"/> No | | | d) Engineered flood openings? <input type="radio"/> Yes <input checked="" type="radio"/> No | | |

| SECTION B - FLOOD INSURANCE RATE MAP (FIRM) INFORMATION | | | | | |
|---|-----------------|-------------------------------|---|-------------------------|--|
| B1. NFIP Community Name & Community Number CITY OF SIMONTON 481564 | | | B2. County Name FORT BEND | | B3. State TEXAS |
| B4. Map/Panel Number 48157C 0090 | B5. Suffix L | B6. FIRM Index Date 4-2-14 | B7. FIRM Panel Effective/Revised Date 4-2-14 | B8. Flood Zone(s) AE | B9. Base Flood Elevation(s) (Zone AO, use base flood depth) 113.5 |
| B10. Indicate the source of the Base Flood Elevation (BFE) data or base flood depth entered in Item B9: <input checked="" type="radio"/> FIS Profile <input type="radio"/> FIRM <input type="radio"/> Community Determined <input type="radio"/> Other/Source: _____ | | | | | |
| B11. Indicate elevation datum used for BFE in Item B9: <input type="radio"/> NGVD 1929 <input checked="" type="radio"/> NAVD 1988 <input type="radio"/> Other/Source: _____ | | | | | |
| B12. Is the building located in a Coastal Barrier Resources System (CBRS) area or Otherwise Protected Area (OPA)? <input type="radio"/> Yes <input checked="" type="radio"/> No Designation Date: <input type="radio"/> CBRS <input type="radio"/> OPA | | | | | |

| SECTION C - BUILDING ELEVATION INFORMATION (SURVEY REQUIRED) | | | | | |
|--|------------|---|----------------------------------|---------------------------------------|------------------------------|
| C1. Building elevations are based on: <input type="radio"/> Construction Drawings* <input type="radio"/> Building Under Construction* <input checked="" type="radio"/> Finished Construction | | | | | |
| * A new Elevation Certificate will be required when construction of the building is complete. | | | | | |
| C2. Elevations: Zones A1-A30, AE, AH, A (with BFE), VE, V1-V30, V (with BFE), AR, AR/A, AR/AE, AR/A1-A30, AR/AH, AR/AO. Complete Items C2.a-h below according to the building diagram specified in Item A7. In Puerto Rico only, enter meters. | | | | | |
| Benchmark Utilized: <u>NGS MON. AW 5487</u> | | | Vertical Datum: <u>NAVD 1988</u> | | |
| Indicate elevation datum used for the elevations in items a) through h) below. <input type="radio"/> NGVD 1929 <input checked="" type="radio"/> NAVD 1988 | | | | | |
| <input type="radio"/> Other/Source: _____ | | | | | |
| Datum used for building elevations must be the same as that used for the BFE. | | | | Check the measurement used. | |
| a) Top of bottom floor (including basement, crawlspace, or enclosure floor) | <u>110</u> | . | <u>6</u> | <input checked="" type="radio"/> feet | <input type="radio"/> meters |
| b) Top of the next higher floor | <u>N/A</u> | . | <u>N/A</u> | <input checked="" type="radio"/> feet | <input type="radio"/> meters |
| c) Bottom of the lowest horizontal structural member (V Zones only) | <u>N/A</u> | . | <u>N/A</u> | <input checked="" type="radio"/> feet | <input type="radio"/> meters |
| d) Attached garage (top of slab) | <u>N/A</u> | . | <u>N/A</u> | <input checked="" type="radio"/> feet | <input type="radio"/> meters |
| e) Lowest elevation of machinery or equipment servicing the building (Describe type of equipment and location in Comments) | <u>109</u> | . | <u>7</u> | <input checked="" type="radio"/> feet | <input type="radio"/> meters |
| f) Lowest adjacent (finished) grade next to building (LAG) | <u>108</u> | . | <u>9</u> | <input checked="" type="radio"/> feet | <input type="radio"/> meters |
| g) Highest adjacent (finished) grade next to building (HAG) | <u>109</u> | . | <u>8</u> | <input checked="" type="radio"/> feet | <input type="radio"/> meters |
| h) Lowest adjacent grade at lowest elevation of deck or stairs, including structural support | <u>N/A</u> | . | <u>N/A</u> | <input checked="" type="radio"/> feet | <input type="radio"/> meters |

ELEVATION CERTIFICATE, page 2

OMB Control Number: 1660-0008
Expiration: 11/30/2018

| | | | |
|---|-------------|----------------------------------|----------------------|
| IMPORTANT: In these spaces, copy the corresponding information from Section A. | | FOR INSURANCE COMPANY USE | |
| Building Street Address (including Apt., Unit, Suite, and/or Bldg. No.) or P.O. Route and Box No. 36704 BRONCHO ROAD | | Policy Number: | |
| City WALLIS | State TX | Zip Code 77485 | Company NAIC Number: |

SECTION D - SURVEYOR, ENGINEER, OR ARCHITECT CERTIFICATION

This certification is to be signed and sealed by a land surveyor, engineer, or architect authorized by law to certify elevation information. *I certify that the information on this Certificate represents my best efforts to interpret the data available. I understand that any false statement may be punishable by fine or imprisonment under 18 U.S. Code, Section 1001.*

Check here if attachments.

Were latitude and longitude in Section A provided by a licensed land surveyor?
 Yes No

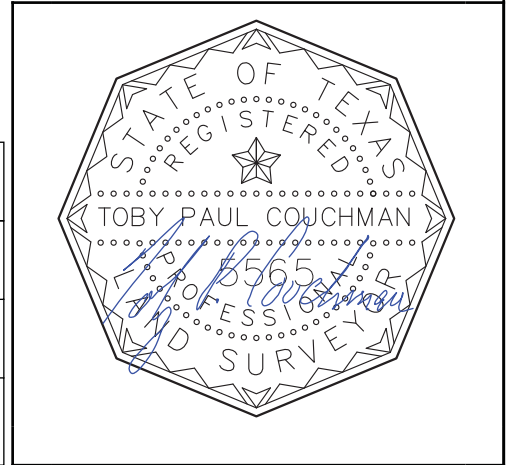

| | | | |
|--|--|---------------------------|-------------------|
| Certifier's Name TOBY PAUL COUCHMAN | | License Number 5565 | |
| Title R.P.L.S. | Company Name PRO-SURV TBPLS FIRM NO. 10119300 | | |
| Address P.O. BOX 1366 | City FRIENDSWOOD | State TX | Zip Code 77549 |
| Signature <i>Toby P. Couchman</i> | Date 2-14-18 | Telephone 281-996-1113 | |

Copy all pages of this Elevation Certificate for (1) community official, (2) insurance agent/company, and (3) building owner.

Comments (including type of equipment and location, per C2(e), if applicable)

THE ELEVATION IN SECTION C2e REFERS TO AN AIR CONDITIONING UNIT (CONDENSER)

Signature *Toby P. Couchman* Date 2-14-18

SECTION E - BUILDING ELEVATION INFORMATION (SURVEY NOT REQUIRED) FOR ZONE AO AND ZONE A (WITHOUT BFE)

For Zones AO and A (without BFE), complete Items E1-E5. If the Certificate is intended to support a LOMA or LOMR-F request, complete Sections A, B, and C. For Items E1-E4, use natural grade, if available. Check the measurement used. In Puerto Rico only, enter meters.

- E1. Provide elevation information for the following and check the appropriate boxes to show whether the elevation is above or below the highest adjacent grade (HAG) and the lowest adjacent grade (LAG).
- a) Top of bottom floor (including basement, crawlspace, or enclosure) is _____ . _____ feet meters above or below the HAG.
- b) Top of bottom floor (including basement, crawlspace, or enclosure) is _____ . _____ feet meters above or below the LAG.
- E2. For Building Diagrams 6-9 with permanent flood openings provided in Section A Items 8 and/or 9 (see page 8 of Instructions), the next higher floor (elevation C2.b in the diagrams) of the building is _____ . _____ feet meters above or below the HAG.
- E3. Attached garage (top of slab) is _____ . _____ feet meters above or below the HAG.
- E4. Top of platform of machinery and /or equipment servicing the building is _____ . _____ feet meters above or below the HAG.
- E5. Zone AO only: If no flood depth number is available, is the top of the bottom floor elevated in accordance with the community's floodplain management ordinance? Yes No Unknown. The local official must certify this information in Section G.

SECTION F - PROPERTY OWNER (OR OWNER'S REPRESENTATIVE) CERTIFICATION

The property owner or owner's authorized representative who completes Sections A, B, and E for Zone A (without a FEMA-issued or community-issued BFE) or Zone AO must sign here. The statements in Sections A, B, and E are correct to the best of my knowledge.

| | | | |
|--|---------------------|----------------|----------|
| Property Owner or Owner's Authorized Representative's Name TOBY PAUL COUCHMAN | | | |
| Address P.O. BOX 1366 | City FRIENDSWOOD | State TEXAS | ZIP Code |
| Signature | Date 2-14-18 | Telephone | |

Comments

Check here if attachments.

| | | |
|---|----------------|----------------------------------|
| IMPORTANT: In these spaces, copy the corresponding information from Section A. | | FOR INSURANCE COMPANY USE |
| Building Street Address (including Apt., Unit, Suite, and/or Bldg. No.) or P.O. Route and Box No. 36704 BRONCHO ROAD | | Policy Number: |
| City WALLIS | State TEXAS | Zip Code 77485 |
| | | Company NAIC Number: |

SECTION G - COMMUNITY INFORMATION (OPTIONAL)

The local official who is authorized by law or ordinance to administer the community's floodplain management ordinance can complete Sections A, B, C (or E), and G of this Elevation Certificate. Complete the applicable item(s) and sign below. Check the measurement used in Items G8-G10. In Puerto Rico only, enter meters.

- G1. The information in Section C was taken from other documentation that has been signed and sealed by a licensed surveyor, engineer, or architect who is authorized by law to certify elevation information. (Indicate the source and date of the elevation data in the Comments area below.)
- G2. A community official completed Section E for a building located in Zone A (without a FEMA-issued or community-issued BFE) or Zone AO.
- G3. The following information (Items G4-G10) is provided for community floodplain management purposes.

| | | |
|-------------------|------------------------|---|
| G4. Permit Number | G5. Date Permit Issued | G6. Date Certificate of Compliance/Occupancy Issued |
|-------------------|------------------------|---|

G7. This permit has been issued for: New Construction Substantial Improvement

G8. Elevation of as-built lowest floor (including basement) of the building: _____ . _____ feet meters Datum _____

G9. BFE or (in Zone AO) depth of flooding at the building site: _____ . _____ feet meters Datum _____

G10. Community's design flood elevation: _____ . _____ feet meters Datum _____

| | |
|-----------------------|-------|
| Local Official's Name | Title |
|-----------------------|-------|

| | |
|----------------|-----------|
| Community Name | Telephone |
|----------------|-----------|

| | | |
|-----------|------|---------|
| Signature | Date | 2-14-18 |
|-----------|------|---------|

Comments (including type of equipment and location, per C2(e), if applicable)

Check here if attachments.

| | | | | | |
|---|----------------|-------------------|----------------------------------|--|--|
| IMPORTANT: In these spaces, copy the corresponding information from Section A. | | | FOR INSURANCE COMPANY USE | | |
| Building Street Address (including Apt., Unit, Suite, and/or Bldg. No.) or P.O. Route and Box No. 36704 BRONCHO ROAD | | | Policy Number: | | |
| City WALLIS | State TEXAS | Zip Code 77485 | Company NAIC Number: | | |

If using the Elevation Certificate to obtain NFIP flood insurance, affix at least 2 building photographs below according to the instructions for Item A6. Identify all photographs with date taken; "Front view" and Rear view"; and, if required, "Right Side View" and "Left Side View." When applicable, photographs must show the foundation with representative examples of the flood openings or vents, as indicated in Section A8. If submitting more photographs than will fit on this page, use the Continuation Page.



FRONT VIEW

DATE: 2-14-18



REAR VIEW

DATE: 2-14-18