

- NOTES:**
1. ALL BEARINGS SHOWN HEREON ARE REFERENCED TO A PRIOR DEED CONVEYED INTO TRESSA O. ALMENDAREZ, RECORDED IN COUNTY CLERK'S FILE NO. 9344186 OF THE OFFICIAL PUBLIC RECORDS OF GALVESTON COUNTY, TEXAS, POINTS (A) AND (B) WERE HELD FOR HORIZONTAL CONTROL.
 2. ABSTRACT INFORMATION FOR THE SUBJECT TRACT WAS PROVIDED BY THE TITLE INSURANCE COMPANY LISTED BELOW. SURVEYOR HAS NOT INDEPENDENTLY ABSTRACTED SUBJECT PROPERTY.
 3. THIS SURVEY IS CERTIFIED TO THE TITLE INSURANCE COMPANY LISTED BELOW FOR THIS TRANSACTION ONLY, IT IS NOT TRANSFERABLE TO ADDITIONAL INSTITUTIONS OR SUBSEQUENT OWNERS.
 4. ALL EASEMENTS AND BUILDING LINES SHOWN ARE PER THE RECORDED PLAT UNLESS OTHERWISE NOTED.
 5. THERE ARE NO NATURAL DRAINAGE COURSES ON SUBJECT PROPERTY.
 6. SUBJECT TO THE RESTRICTIVE COVENANTS AS LISTED IN SCHEDULE B OF THE TITLE COMMITMENT ISSUED ON AUG. 26, 2021, UNDER G.F. NO. 21-617314-CY.
 7. EASEMENT, AS RECORDED IN C.F. NO. 9735508 R.P.R.G.C.
 8. EASEMENT, AS RECORDED IN C.F. NO. 200102503 R.P.R.G.C.

		Capital Title A Shaddock Company	
G.F. #:	21-617314-CY	ISSUE DATE:	AUG. 26, 2021

LEGAL DESCRIPTION: A TRACT OF LAND CONTAINING 1.9612 ACRES (85,428 SQUARE FEET) SITUATED IN THE M. AUSTIN SURVEY, ABSTRACT 1, GALVESTON COUNTY, TEXAS. SAID TRACT BEING MORE PARTICULARLY DESCRIBED BY METES AND BOUNDS AS ATTACHED.

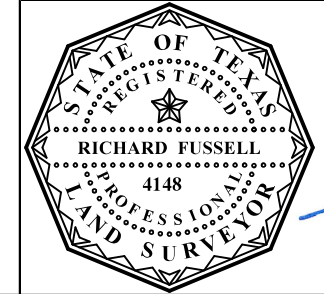
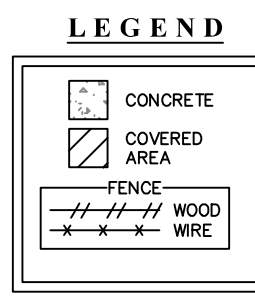

SURVEYORS CERTIFICATE:
IN MY PROFESSIONAL OPINION, THIS PLAT REPRESENTS THE FACTS FOUND ON THE GROUND DURING THE COURSE OF A BOUNDARY SURVEY CONDUCTED UNDER MY SUPERVISION ON SEPT. 16, 2021 AND THAT THIS PLAT SUBSTANTIALLY COMPLES WITH THE CURRENT STANDARDS AS ADOPTED BY THE TEXAS BOARD OF PROFESSIONAL LAND SURVEYING, AND THAT THERE ARE NO ENCROACHMENTS OR PROTRUSIONS EXCEPT AS SHOWN.

RICHARD FUSSELL
PROFESSIONAL LAND SURVEYOR
RPLS# 4148

CLIENT:
BAKER & BAKER INVESTMENTS PROPERTIES, LLC AN/OR ASSIGNS

ADDRESS:
1803 AVENUE Q
www.survey1inc.com
survey1@survey1inc.com

FIELD CREW:	TECH:
LG	MA
DRAFTER:	FINAL CHECK:
AR	EF
DATE:	
9-23-21	
JOB#	
9-102390-21	

Firm Registration No. 100758-00
P.O. Box 2543 | Alvin, TX 77512 | (281)393-1382