

8911 Nature Park Dr.. - Cameron Plan

SIENNA 45' - Heritage Park - Section 29A

MOVE-IN READY!

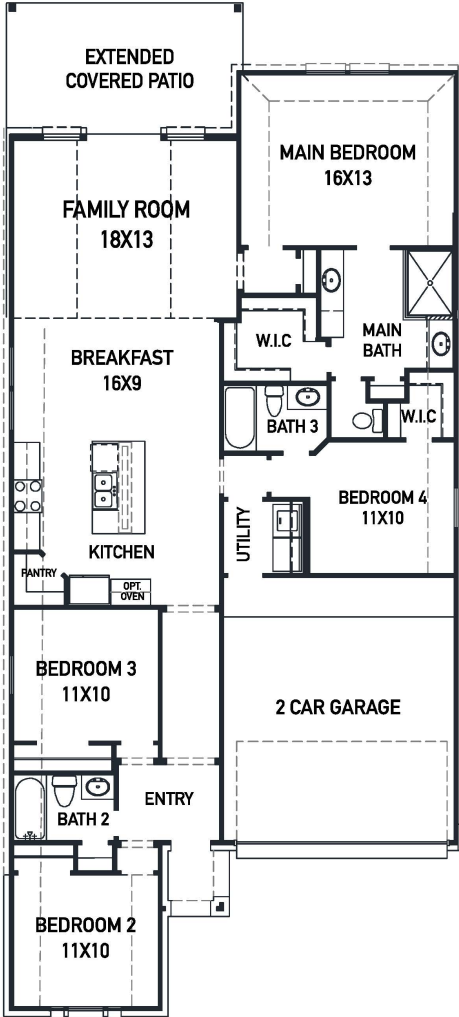

FIRST FLOOR PLAN



- Upgraded stucco front elevation w/ brick on 1st floor sides/back
- Built in appliances w/ a 36" 5 burner gas cook-top
- Modern 42" kitchen cabinetry w/ hardware
- Fridge, washer, dryer, blinds included
- Wood look tile in the whole house
- Upgraded 8 ft. front door

- THE NEWMARK STANDARD IN SIENNA
- Open cell spray foam insulation
- 16 seer duel stage HVAC system
- Full sprinkler system & sod
- Full rain gutters
- 2 year Energy Ogre Agreement
- 3rd party inspections (Foundation, frame, energy, final)

FEATURES

- 1 Story - Apx: 1757 sqft.
- 4 Bedrooms - 3 Bathrooms
- 2 Car Garage
- 45 x 135 Homesite - 6075 sqft.

REV 8/20 (451C)



These drawings are conceptual only and are for the convenience of reference. They should not be relied upon as representations, express or implied, of the final detail of the residences. The builder expressly reserves the right to make modifications, revisions, and changes it deems desirable in its sole and absolute discretion. Dimensions and square footages are approximate and may vary with actual construction.