



2920 Cain Road
College Station, TX 77845
www.anchorfoundationrepair.net
Office: 979-690-2020
Cell: 979-587-9261

Invoice

Number
15048

Start Date
Apr 27, 2015

Job Address
Mrs Joyce Mahaney
212 Shadow Oak Ln.
Somerville, TX
c: 281-928-0101
w: 979-337-7514
h: 979-535-4579

Billing Address
Same as job address

Payment Terms

Service Description

Pier, Bell Bottom, Exterior
Installed 14x exterior drilled bell bottom piers.

Mud-pumping
Mud jacked settled driveway prior to installing trench drain.

Additional Comments
Installed driveway drain to catch water coming from street and redirect to existing catch basin

Additional Comments
Discount \$260.00, Regular \$0.00
Dirt remained on jobsite

Payment - 5/1/15 Check 11539

Payment - 6/9/15 Check 11704

PAID

Thank you so much!

Total	\$9,890.00
Payments	\$9,890.00
Balance	\$0.00



3819 McCullough Rd.
College Station, TX 77845
www.anchorfoundationrepair.net
Office: 979-690-2020
Cell: 979-587-9261

Invoice

Number
16144

Date
Sep 22, 2016

Job Address

Mrs Joyce Mahaney
212 Shadow Oak Ln.
Somerville, TX
c: 281-928-0101
w: 979-337-7514
h: 979-535-4579

Billing Address

Same as job address

Payment Terms

Service Description

Pier, Bell Bottom, Exterior

Installed 14x exterior drilled bell bottom piers.

Mud-pumping

Mud jacked settled driveway prior to installing trench drain.

Payment - 10/7/16 Check 4265

PAID

Thank you so much!

Total	\$5,950.00
Payments	\$5,950.00
Balance	\$0.00

LAIG TRIP
979-557-9261

2920 Cain Road
College Station, TX 77845
Office: (979)690-2020
www.anchorfoundationrepair.net



Date: 26 MAR 15

Anchor Structural Services, LLC. ("Contractor"), and MRS JOYCE MAHANEY ("Owner") agree that the sum of \$ 7,650.00, to be paid as follows: 50 % after piers are poured, balance upon completion.

Contractor will furnish labor, equipment, and materials to perform the following described work to the hereinafter described building or structure located at: 212 SHADOW OAK LN. SOMERVILLE, TX; Story: 1; Structure: BRICK/SLAB; Phone: 281-928-0101; Email: _____

1. The work shall consist of the installation of 14 EXTERIOR PIERS and N/A INTERIOR PIERS with 8" diameter shafts drilled to 8' to 12' (water table, rocks, and/or man placed objects permitting.) The bottom of the shaft will have a 20" diameter bell footing, unless rock is encountered.
2. Contractor assumes no responsibility for any under slab plumbing. It may currently be cracked, broken, deteriorated or may do so in the leveling process. Any repairs, if required, are the sole responsibility of the owner. Contractor will tunnel at a rate of \$ 215.00 in order to allow for repairs to plumbing.
3. Contractor will not make repairs to foundation watering systems after leveling. If damaged, Contractor will make every reasonable effort to repair lawn irrigation systems that are properly installed.
4. Contractor will carry all insurance required by the State of Texas.
5. When inside piers are required, contractor will patch floors with concrete to floor level. Carpet will NOT be stretched.
6. When surfaces such as concrete porches, patios, or drives are broken in order to install piers, Contractor will patch surfaces. However, the patches will NOT match the color or texture of the original surface. Special surfaces such as Flagstone, Spanish Tile, Brick or other such materials will be restored at an additional cost as specified below.
7. In foundation leveling, conditions might appear when work is begun that were not visible at time of estimate; such as, insufficient reinforcing steel in concrete slab, and/or other structural deficiency. In such cases the guarantee becomes invalid.

8. SPECIAL PROVISIONS: No Subcontractors.

- VOID TO BE MUD PUMPED AFTER RAISING
- OPTION TO MUD PUMP DRIVEWAY. ADD \$650 TO ABOVE
- POLYURETHANE DRIVEWAY REPAIR: \$750.00

9. **LIFETIME SERVICE AGREEMENT:** If any raising is necessary due to settling during the first five years from date of job completion, Contractor will re-raise the settled area **WITHOUT COST TO THE OWNER**. Servicing for additional years, if required, will be done at the rate of \$ 125.00, per adjusted pier, labor and materials included, plus or minus the U.S. Consumer Price Index each year. This service agreement applies only to the 14 piers installed by Contractor.

THIS AGREEMENT IS TRANSFERABLE TO NEW OWNERS. NOTIFICATION MUST BE TENDERED IN WRITING WITHIN 90 DAYS OF OWNERSHIP.

It is understood and agreed that in order to perform the above described work, it is possible that sheetrock, wallpaper, or other rigid material may crack. Therefore, the above figure does not include any redecorating, repairing, electrical work or the replacement of any material not called for in this Agreement. Contractor, upon request from the Owner, will transplant plants and shrubs obstructing operations, and replace same upon completion of repairs. Survival of plants and shrubs CANNOT be guaranteed.

It is understood and agreed that Contractor will furnish all the labor, equipment, and material and will perform all necessary work in connection with this job, in a good workmanlike manner. Job site will be clean of all excess dirt and material.

The Owner may order extra work to be done not contemplated by the contract. In which event, a separate Agreement for such work shall be entered between the Owner and the Contractor. No oral representation made by anyone can change or modify this Agreement. The Agreement, in order to be binding by both parties, must be signed and returned to this office within 90 days from the date shown above.

Owner Joyce Mahaney

[Signature]
Anchor Structural Services, LLC

2920 Cain Road

College Station, TX 77845

979.690.2020

www.AnchorFoundationRepair.net



ANCHOR
FOUNDATION REPAIR

Name Joyce Mahaney

Address 212 Shadow Oak Ln.

Tel 281-928-0101

Email _____

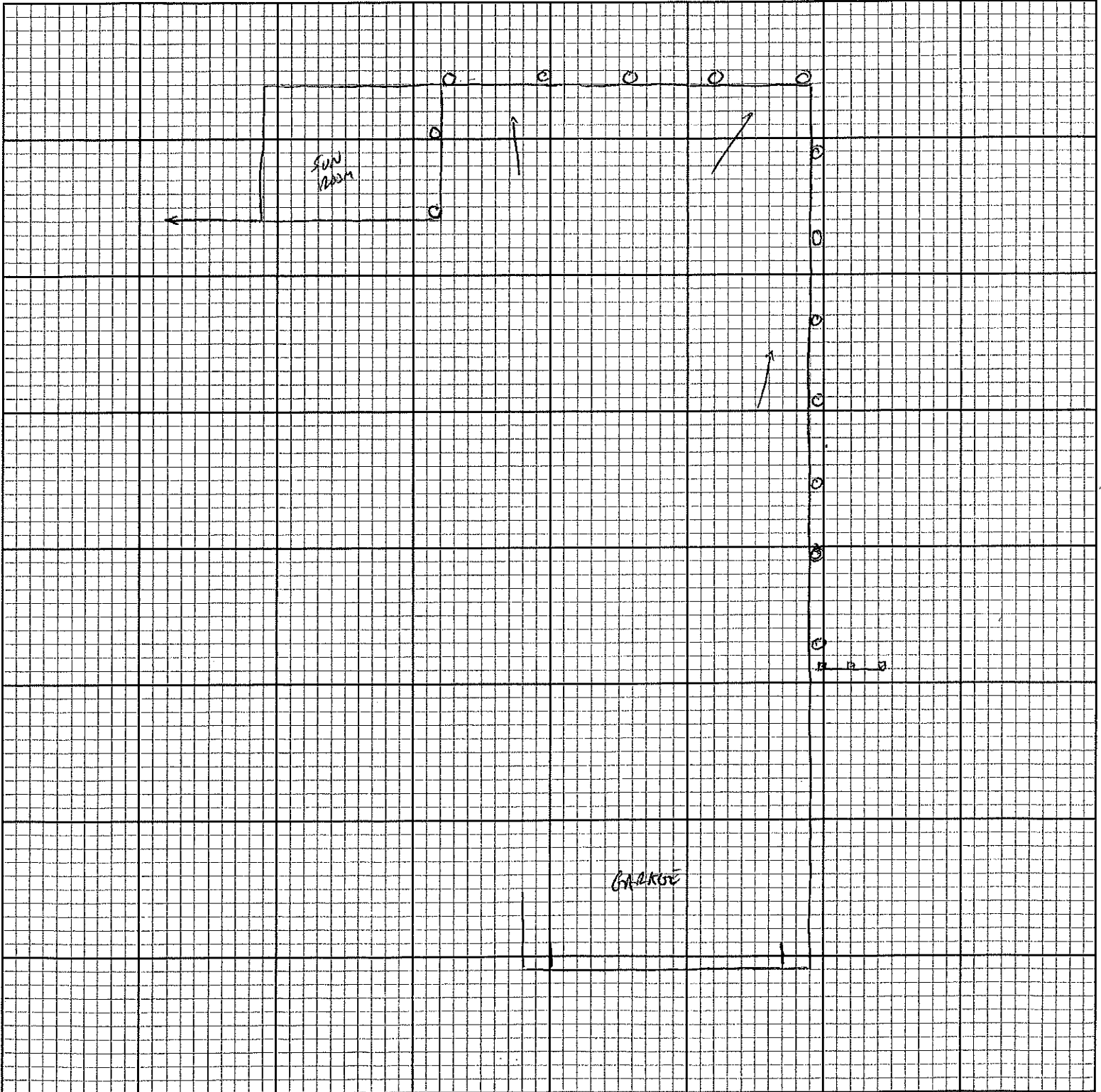

Interior _____

Exterior 14

➔ Direction of Slope

3819 McCullough Rd.
College Station, TX 77845
Office: (979)690-2020
www.anchorfoundationrepair.net



Date: 23 JUL 16

Anchor Structural Services, LLC. ("Contractor"), and Mrs Joyce Mailaney ("Owner") agree that the sum of \$ 2,700.00, to be paid as follows: 50 % after piers are poured, balance upon completion.

Contractor will furnish labor, equipment, and materials to perform the following described work to the hereinafter described building or structure located at: 212 SHADON OAK LN. SIMPSONVILLE; Story: 1; Structure: BRICK/SLAB; Phone: _____; Email: _____.

1. The work shall consist of the installation of 5 EXTERIOR PIERS and N/A INTERIOR PIERS with 8" diameter shafts drilled to 8' to 12' (water table, rocks, and/or man placed objects permitting.) The bottom of the shaft will have a 20" diameter bell footing, unless rock is encountered.

2. Contractor assumes no responsibility for any under slab plumbing. It may currently be cracked, broken, deteriorated or may do so in the leveling process. Any repairs, if required, are the sole responsibility of the owner. Contractor will tunnel at a rate of \$ 200.00 in order to allow for repairs to plumbing.

3. Contractor will not make repairs to foundation watering systems after leveling. If damaged, Contractor will make every reasonable effort to repair lawn irrigation systems that are properly installed.

4. Contractor will carry all insurance required by the State of Texas.

5. When inside piers are required, contractor will patch floors with concrete to floor level. Carpet will NOT be stretched.

6. When surfaces such as concrete porches, patios, or drives are broken in order to install piers, Contractor will patch surfaces. However, the patches will NOT match the color or texture of the original surface. Special surfaces such as Flagstone, Spanish Tile, Brick or other such materials will be restored at an additional cost as specified below.

7. In foundation leveling, conditions might appear when work is begun that were not visible at time of estimate; such as, insufficient reinforcing steel in concrete slab, and/or other structural deficiency. In such cases the guarantee becomes invalid.

8. SPECIAL PROVISIONS: No Subcontractors.

- GARAGE SHALL SLIGHT SETTLEMENT TOWARDS RD.
- PROPOSAL IS TO REPAIR GARAGE/HOME DOOR WITH 5 EXTERIOR PIERS.
- OPTION TO CONTINUE PIERS AROUND FRONT OF GARAGE w/c ADDITIONAL PIERS. \$5,950.00 TOTAL.

9. **LIFETIME SERVICE AGREEMENT:** If any raising is necessary due to settling during the first five years from date of job completion, Contractor will re-raise the settled area **WITHOUT COST TO THE OWNER**. Servicing for additional years, if required, will be done at the rate of \$ 120.00, per adjusted pier, labor and materials included, plus or minus the U.S. Consumer Price Index each year. This service agreement applies only to the ALL piers installed by Contractor.

THIS AGREEMENT IS TRANSFERABLE TO NEW OWNERS. NOTIFICATION MUST BE TENDERED IN WRITING WITHIN 90 DAYS OF OWNERSHIP.

It is understood and agreed that in order to perform the above described work, it is possible that sheetrock, wallpaper, or other rigid material may crack. Therefore, the above figure does not include any redecorating, repairing, electrical work or the replacement of any material not called for in this Agreement. Contractor, upon request from the Owner, will transplant plants and shrubs obstructing operations, and replace same upon completion of repairs. Survival of plants and shrubs CANNOT be guaranteed.

It is understood and agreed that Contractor will furnish all the labor, equipment, and material and will perform all necessary work in connection with this job, in a good workmanlike manner. Job site will be clean of all excess dirt and material.

The Owner may order extra work to be done not contemplated by the contract. In which event, a separate Agreement for such work shall be entered between the Owner and the Contractor. No oral representation made by anyone can change or modify this Agreement. The Agreement, in order to be binding by both parties, must be signed and returned to this office within 90 days from the date shown above.

2920 Cain Road
College Station, TX 77845
979.690.2020

www.AnchorFoundationRepair.net



ANCHOR
FOUNDATION REPAIR

Name Mrs Joyce MADANEY
Address 212 SHADOW OAK LN
Tel N: 979-535-4579
Email C: 281-928-0101

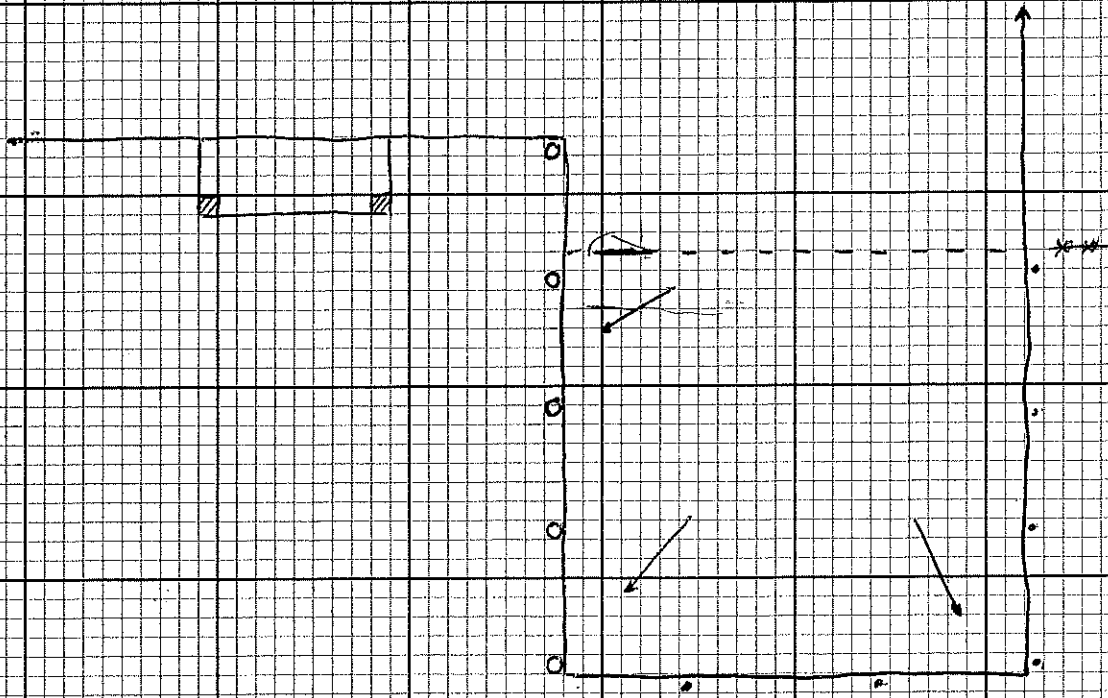

Interior _____
Exterior 5:0
➔ Direction of Slope