

TITLE COMPANY:

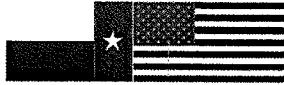

TEXAS AMERICAN TITLE COMPANY

281-484-8680

G.F. #

7800-15-1256

ISSUE DATE:

JUNE 16, 2015



SCALE 1" = 20'

LOT 1

SET 1/2" IR W/CAP MARKED "SURVEY 1"

WEST 100.00'

4" METAL POST

2.5' S.S.E. K216739

LOTS 6 & 7 BLOCK 3

LOT 5

NORTH 92.66'

(VACANT)

SOUTH 92.40'

DAVIS STREET (60' R.O.W.)

LOT 1 LOT 2 FND 5/8" I.R. (B)

195.00'

SET 1/2" IR W/CAP MARKED "SURVEY 1"

50.00'

S 89°51'10" W 100.00'

50.00'

SET 1/2" IR W/CAP MARKED "SURVEY 1"

FND 1/2" I.R. (A)

60.00'

QUITMAN STREET (60' R.O.W.)

NOTES:

1. ALL BEARINGS SHOWN HEREON ARE REFERENCED TO THE SUBDIVISION PLAT NAMED BELOW, POINTS (A) AND (B) WERE HELD FOR HORIZONTAL CONTROL.
2. ABSTRACT INFORMATION FOR THE SUBJECT TRACT WAS PROVIDED BY THE TITLE INSURANCE COMPANY LISTED ABOVE.
3. THIS SURVEY IS CERTIFIED TO THE TITLE INSURANCE COMPANY LISTED ABOVE FOR THIS TRANSACTION ONLY, IT IS NOT TRANSFERABLE TO ADDITIONAL INSTITUTIONS OR SUBSEQUENT OWNERS.
4. ALL EASEMENTS AND BUILDING LINES SHOWN ARE PER THE RECORDED PLAT UNLESS OTHERWISE NOTED.
5. THERE ARE NO NATURAL DRAINAGE COURSES ON SUBJECT PROPERTY.
6. SUBJECT TO THE RESTRICTIVE COVENANTS AS LISTED IN SCHEDULE B OF THE TITLE COMMITMENT ISSUED ON JUNE 16, 2015, UNDER G.F. NO. 7800-15-1256.

LEGEND

S.S.E. = SANITARY SEWER EASEMENT

LEGAL DESCRIPTION: LOTS 6 & 7, IN BLOCK 3, OF FOX AND FARMER ADDITION, A SUBDIVISION IN HARRIS COUNTY, TEXAS, ACCORDING TO THE MAP OR PLAT THEREOF RECORDED IN VOLUME 246, PAGE 615 OF THE DEED RECORDS OF HARRIS COUNTY, TEXAS.

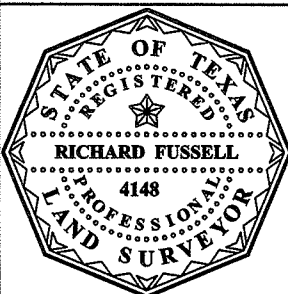

SURVEYORS CERTIFICATE: IN MY PROFESSIONAL OPINION, THIS PLAT REPRESENTS THE FACTS FOUND ON THE GROUND DURING THE COURSE OF A BOUNDARY SURVEY CONDUCTED UNDER MY SUPERVISION ON JUNE 18, 2015 AND THAT THIS PLAT SUBSTANTIALLY COMPLES WITH THE CURRENT STANDARDS AS ADOPTED BY THE TEXAS BOARD OF PROFESSIONAL LAND SURVEYING, AND THAT THERE ARE NO ENCROACHMENTS OR PROTRUSIONS EXCEPT AS SHOWN.

RICHARD FUSSELL RP25# 4148

CLIENT: STUART & ASSOC. INTERESTS, LP

ADDRESS: QUITMAN STREET

www.survey1inc.com survey1@survey1inc.com

Survey 1, Inc. Your Land Survey Company Firm Registration No. 100758-00 P.O. Box 2543 | Alvin, TX 77512 | (281)393-1382

FIELD CREW: CH	TECH: SF
DRAFTER: AR	FINAL CHECK: EF
DATE: 06-18-15	
JOB# 6-37208-15	