

Building Sketch

Borrower/Client	Zachary Davis, Katherine Davis			
Property Address	98 Hanover Ln			
City	Conroe	County	Montgomery	State TX Zip Code 77304
Lender	Cornerstone Home Lending, Inc.			

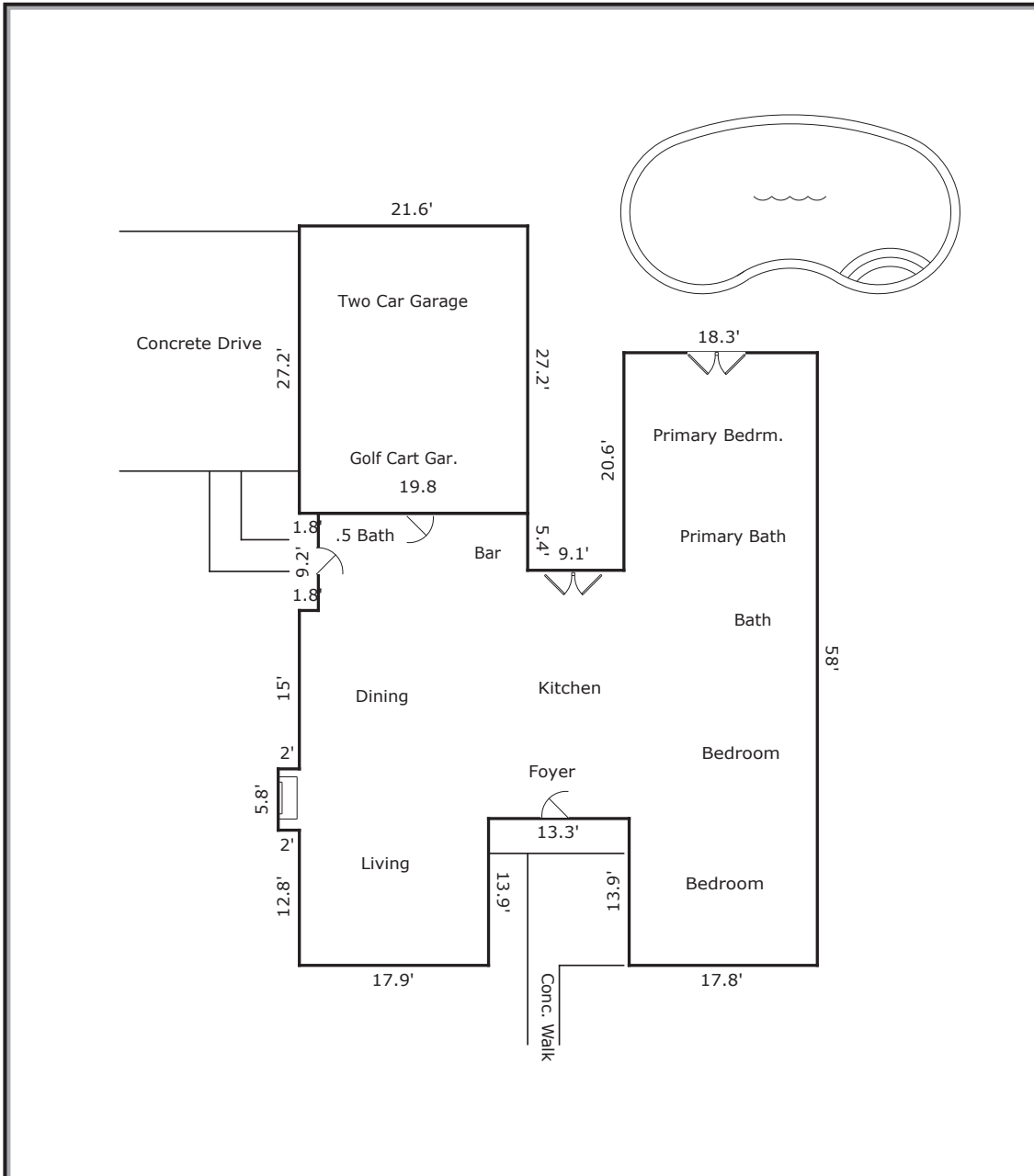

Area Calculations Summary

Living Area	Calculation Details	
First Floor	2136.39 Sq ft	$5.8 \times 2 = 11.6$ $18.3 \times 20.6 = 376.98$ $17.8 \times 13.9 = 247.42$ $23.5 \times 27.4 = 643.9$ $17.9 \times 13.9 = 248.81$ $21.6 \times 19.7 = 425.52$ $9.2 \times 19.8 = 182.16$
Total Living Area (Rounded):	2136 Sq ft	
Non-living Area		
2 Car Attached	587.52 Sq ft	$27.2 \times 21.6 = 587.52$