

LEGEND

- B.C.C.F. = BRAZORIA COUNTY CLERK'S FILE
- B.C.D.R. = BRAZORIA COUNTY DEED RECORDS
- B.C.P.R. = BRAZORIA COUNTY PLAT RECORDS
- BM = BENCHMARK
- D.M.E. = DRAINAGE/MAINTENANCE EASEMENT
- FND = FOUND
- C.I.R. = CAPPED IRON ROD
- I.R. = IRON ROD
- P.C.E. = POWER COMPANY EASEMENT
- P.O.B. = POINT OF BEGINNING
- P.O.C. = POINT OF COMMENCEMENT
- No. = NUMBER
- R.O.W. = RIGHT-OF-WAY
- VOL., Pg. = VOLUME PAGE
- P.C.E. = POWER COMPANY EASEMENT
- U.E. = UTILITY EASEMENT
- A.E. = AERIAL EASEMENT
- D.E. = DRAINAGE EASEMENT

SYMBOLS

- = SET 5/8" I.R. W/CAP "BAKER & LAWSON"
- ⊙ = FOUND MONUMENT (AS NOTED)
- ⊕ = (TBM) TEMPORARY BENCHMARK

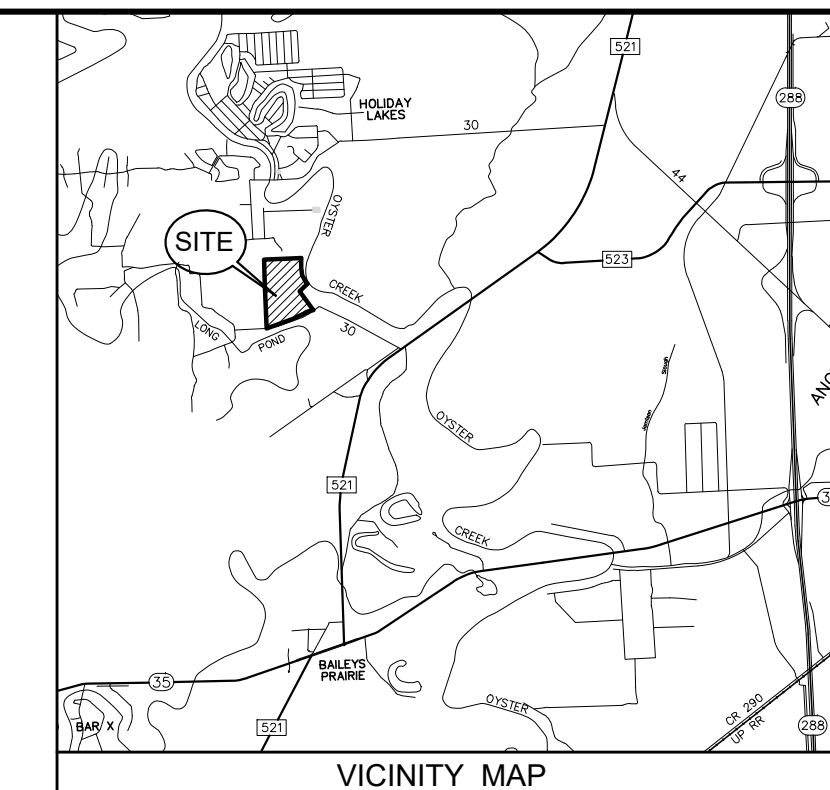
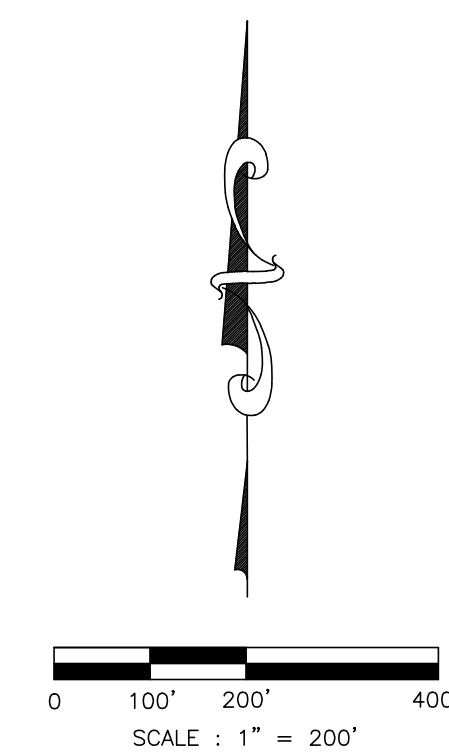

Curve Table					
Curve No.	Length	Radius	Delta	Chord Bearing	Chord Distance
C10	43.01'	1040.00'	2'22"10"	S79°39'32"W	43.01'
C11	148.15'	1030.00'	8'14"28"	S68°54'29"W	148.02'

Line Table		
Line No.	Length	Direction
L5	337.11'	S00°12'04"W
L6	280.81'	S07°42'11"E
L7	260.55'	S28°50'08"E
L8	104.95'	S42°49'29"E
L9	98.84'	S69°57'03"W
L10	134.86'	S64°40'38"W
L11	406.78'	S64°48'25"W



REVISED:

**OPTION 1
72.72 ACRES**

LOCATED IN THE
JOHN BRADLEY SURVEY, ABSTRACT No. 45
BRAZORIA COUNTY, TEXAS

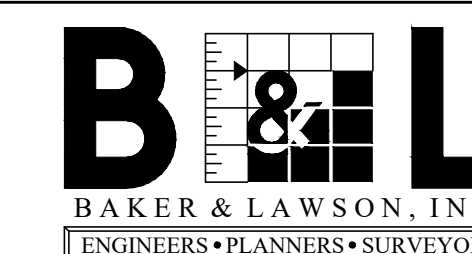

BAKER & LAWSON, INC.
ENGINEERS • PLANNERS • SURVEYORS

4005 Technology Drive, Suite 1530
Angleton, TX 77515
OFFICE: (979) 849-6681
TBPLS No. 10052500
REG. NO. F-825

OWNER:
GEORGE N. JENKS LIVING TRUST, ET AL
TRUSTEE: GEORGE JENKS

PROJECT NO.: 13271	SCALE: 1" = 200'	DRAWN BY: BT
DRAWING NO.: 13271 OPTION 1.DWG	DATE: 3/29/2022	CHECKED BY: PH