



SCALE: 1" = 20'

- LEGEND:
- UTILITY POLE
 - AERIAL ELECTRIC LINES
 - WELDED WIRE FENCE
 - CONCRETE
 - OVERHANG

N/F
JOE S. FALCO, JR.
657/748

N/F
NOLBERTA GUERRERO
653/569

5/8" IRON
ROD FOUND - CM

5/8" IRON
ROD FOUND - CM

N 56°00'00" E - 108.40

0.1672 ACRE TRACT

S 56°00'00" W - 107.40

KETTLER STREET
(60' R.O.W.)

1 STORY HOUSE WITH
VINYL SIDING
1319 KETTLER STREET

JUDSON AVENUE
(60' R.O.W.)

POINT OF BEGINNING

BRAD KERR
REGISTERED PROFESSIONAL
LAND SURVEYOR NO. 4502

SURVEYOR'S CERTIFICATE:
I, BRAD KERR, R.P.L.S. NO. 4502, DO HEREBY CERTIFY THAT THIS PLAT IS A TRUE REPRESENTATION OF A SURVEY MADE ON THE GROUND UNDER MY SUPERVISION AND THAT THERE ARE NO ENCROACHMENTS ON THIS TRACT EXCEPT AS SHOWN HEREON. THIS TRACT DOES NOT LIE WITHIN A DESIGNATED 100 YEAR FLOOD PLAIN ACCORDING TO THE F.L.R.M. MAPS, COMMUNITY PANEL NO. 480265 0005 A, EFFECTIVE DATE: 02-04-1988.

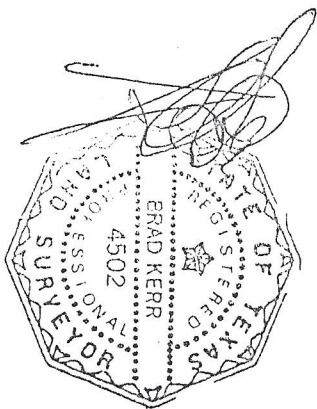

BUYER	FRANK W. PATOUT
TITLE COMPANY	GRIMES COUNTY TITLE, INC.
G.F. No.	99822L

LAND TITLE SURVEY PLAT
OF A
0.1672 ACRE TRACT
PORTION OF LOTS 3, 4 & 5, BLOCK 5
FELDER ADDITION
VOLUME 37, PAGE 516
NAVASOTA, GRIMES COUNTY, TEXAS

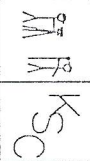

SCALE: 1 INCH = 20 FEET
SURVEY DATE: 11-08-99
PLAT DATE: 11-08-99
JOB NUMBER: 99-1332
CAD NAME: 99-1332
CRS FILE: NAVASOTA

PREPARED BY:
KERR SURVEYING, CO.
505 CHURCH STREET, P.O. BOX 299
COLLEGE STATION, TEXAS 77841
PHONE (409) 268-5195

SEE METES AND BOUNDS PREPARED NOVEMBER, 1999, FOR MORE DESCRIPTIVE INFORMATION.

Frank W. Patout
11-16-99