

### Building Sketch (Page - 1)

Borrower				
Property Address	12614 Craigwood Ln			
City	Cypress	County	Harris	State TX Zip Code 77429
Lender/Client	Michael Polotko			

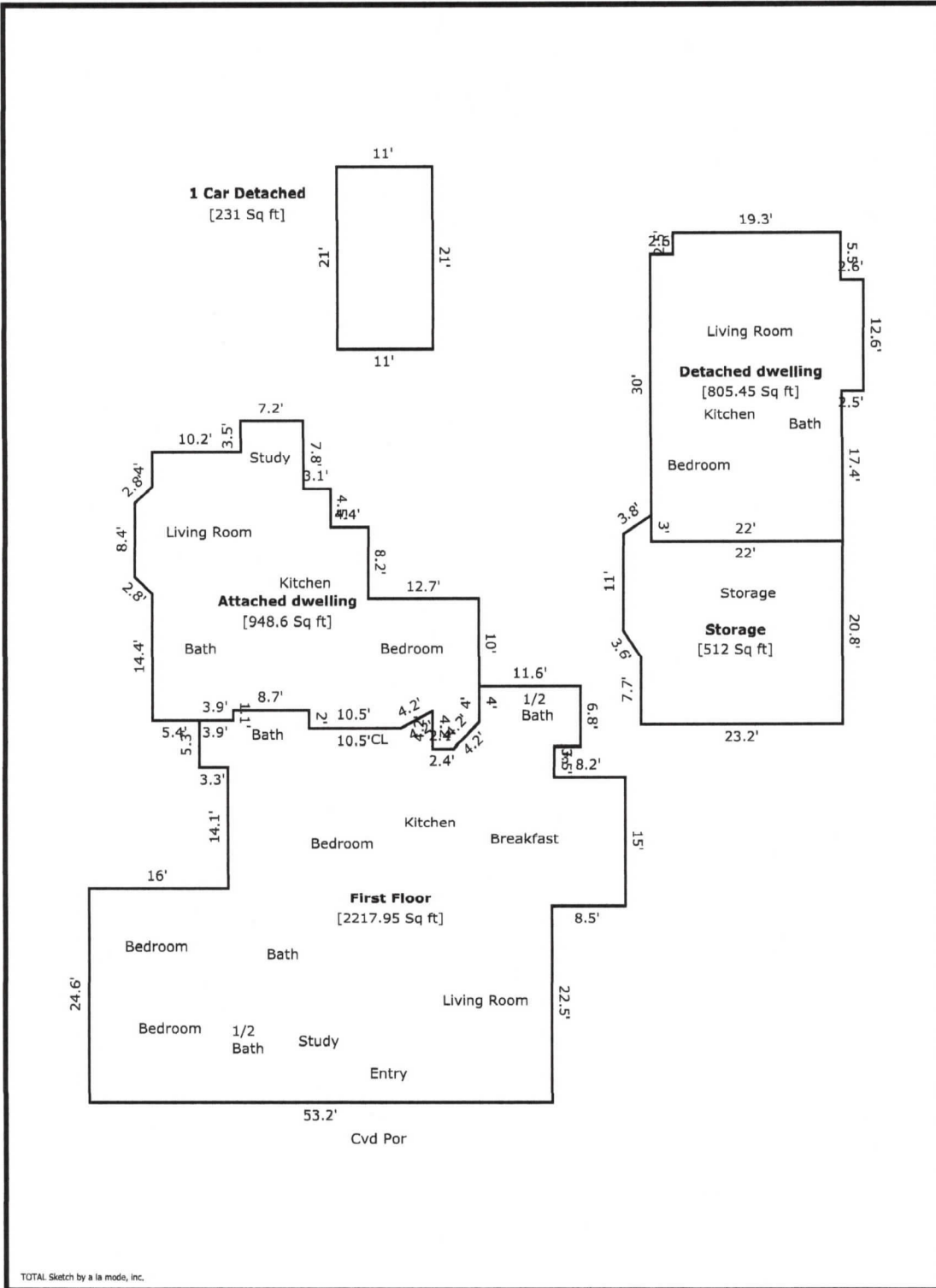

## Building Sketch (Page - 2)

Borrower				
Property Address	12614 Craigwood Ln			
City	Cypress	County	Harris	State TX Zip Code 77429
Lender/Client	Michael Polotko			

TOTAL Sketch by a la mode, inc.

### Area Calculations Summary

Living Area	Area	Calculation Details
First Floor	2217.9 Sq ft	15 × 8.2 = 123 6.8 × 3 = 20.4 8.6 × 4 = 34.4 8.7 × 1.1 = 9.6 21.3 × 0.3 = 6.4 43.8 × 8.3 = 363.5 44.9 × 24.6 = 1104.5 5.3 × 3.3 = 17.5 28.9 × 16.2 = 468.2 0.5 × 3 × 3 = 4.5 3.2 × 9.3 = 29.8 2.3 × 10.5 = 24.2 3.7 × 2.3 = 8.5 0.5 × 3.7 × 1.9 = 3.5
<b>Total Living Area (Rounded):</b>	<b>2218 Sq ft</b>	
<b>Non-living Area</b>		
Attached dwelling	948.6 Sq ft	0.5 × 2 × 2 = 2 0.5 × 2 × 2 = 2 8.4 × 2 = 16.8 7.2 × 3.5 = 25.2 30.8 × 9.3 = 286.4 8.1 × 4.3 = 34.8 11.2 × 4.5 = 50.4 15.6 × 8.2 = 127.9 12.7 × 8.7 = 110.5 14.7 × 10.5 = 154.4 9.1 × 12.8 = 116.5 0.5 × 3.7 × 1.9 = 3.5 4.2 × 2.4 = 10.1 3 × 1.2 = 3.6 0.5 × 3 × 3 = 4.5
Detached dwelling	805.5 Sq ft	22 × 17.4 = 382.8 24.5 × 12.6 = 308.7 3 × 2.6 = 7.8 19.3 × 5.5 = 106.2
Storage	512 Sq ft	20.8 × 22 = 457.6 1.2 × 7.7 = 9.2 1.2 × 3 = 3.6 0.5 × 3 × 2 = 3 3.2 × 11 = 35.2 0.5 × 3.2 × 2.1 = 3.4
1 Car Detached	231 Sq ft	21 × 11 = 231