

**803 Moonbeam Court**  
**Ramona J. Riley and Charles W. Riley, Sr.**

Being all of Lot 49 (FRONT YWEE), WOODBRIDGE SUBDIVISION, SECTION 2, an addition to Washington County, Texas, according to the plat recorded in Plat Cabinet File No. 811A of the Plat Records of Washington County, Texas.  
 I, Paul Williams, Registered Professional Land Surveyor No. 5743 do hereby certify that this plat represents the results of a survey performed on the ground, under my supervision on May 23, 2012, and is true and correct to the best of my knowledge.  
 I further certify that no improvements on this property encroach on adjacent property, nor do any improvements on adjacent property encroach on to this property, except as shown.

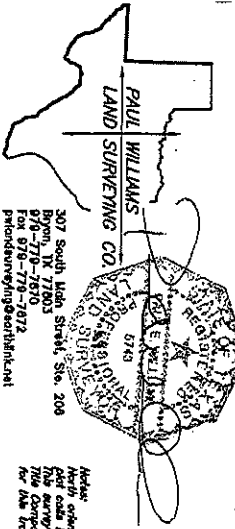

307 South Main Street, Ste. 200  
 P.O. Box 171003  
 Dallas, TX 75217-1003  
 Phone: 972-778-1972  
 paulwilliams@earthlink.net

Notice: My certification is based on reading the south line to plat case in Cabinet 811A, the absence of adjacent title encroachments, and the absence of any other information on file for the transaction only.  
 ts/pwbcy/clients/2011/cv11187.dwg