

MORT. CO.	CORNERSTONE MTS.
TITLE CO.	AMERICAN TITLE CO.
G.F. No.	2001 TH 446031-E
JOB No.	01-39847
REV. DATE	-

I DO HEREBY CERTIFY THAT THIS PLAT REPRESENTS THE RESULT OF A SURVEY MADE ON THE PROPERTY DESCRIBED HEREON.

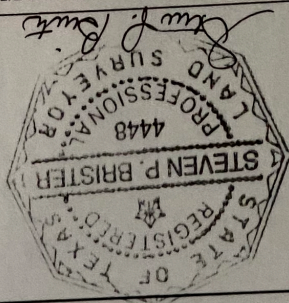

**ALLEX**  
 REALTY SERVICES  
 REAL ESTATE SURVEY DIVISION  
 9610 LONGPOINT, SUITE 150  
 HOUSTON, TEXAS 77055  
 TEL: (713) 468-7707  
 FAX: (713) 468-8815



• SUBJECT PROPERTY LOCATED IN A FEDERAL INSURANCE ADMINISTRATION DESIGNATED FLOOD HAZARD AREA & IS IN ZONE "A"  
 AS PER MAP 480228  
 DATED: 1-03-97  
 PANEL 0375 J  
 • PER HORIZON CERTIFICATION SERVICES, CERTIFICATION NO. 282364, DATED: 4-30-01.

COUNTY:	STATE:	RECORDATION:	SURVEY:
FORT BEND	TEXAS	-	-
PURCHASER: TONY K. BLALOCK & WIFE, DARENA L. BLALOCK		DRAFTING: 04-30-01/CP	KEY MAP: 645 S
ADDRESS: 6018 PLEAK ROAD, RICHMOND, TEXAS		FIELD WORK: 04-20-01/PP	FINAL CHECK: 04-30-01/SB
SCALE: 1"=40'			

1.008 ACRES, OUT OF THE C.B. STEWART 1/4 SURVEY, ABSTRACT NO. 90 (SEE METES & BOUNDS)

NOTES:  
 1.) SUBJECT TO CITY OF PLEAK ZONING ORDINANCES.  
 - ABSTRACTING BY TITLE COMPANY.  
 - ALL BEARINGS SHOWN ARE REFERENCED PER VOL. 1678, PG. 899, F.B.C.O.R.

