

# DUNN & STONE BUILDERS



ELEVATION A

© MARK GOOCH, DESIGNERS INC. 2004

## PLAN 2649

DUNN AND STONE BUILDERS, LLC  
3105 POLLOK DRIVE  
CONROE, TEXAS 77303  
936-441-3900  
WWW.DUNNANDSTONEBUILDERS.COM



# PLAN 2649

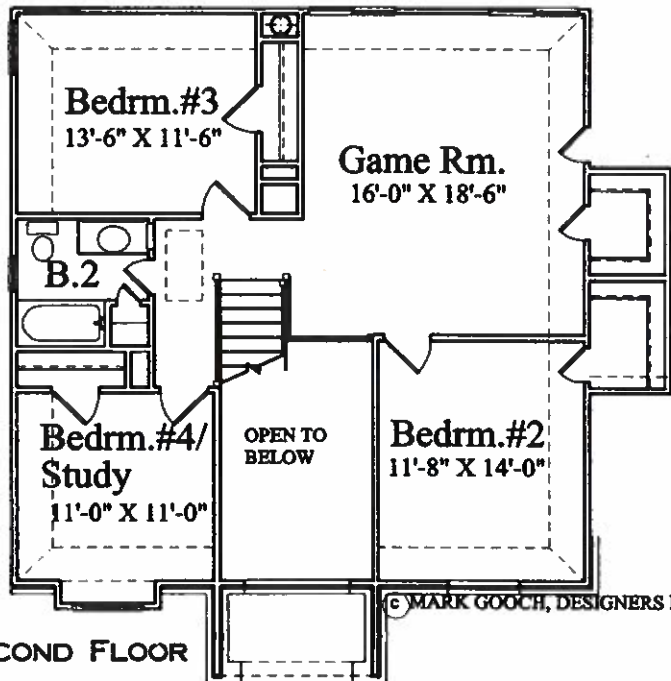
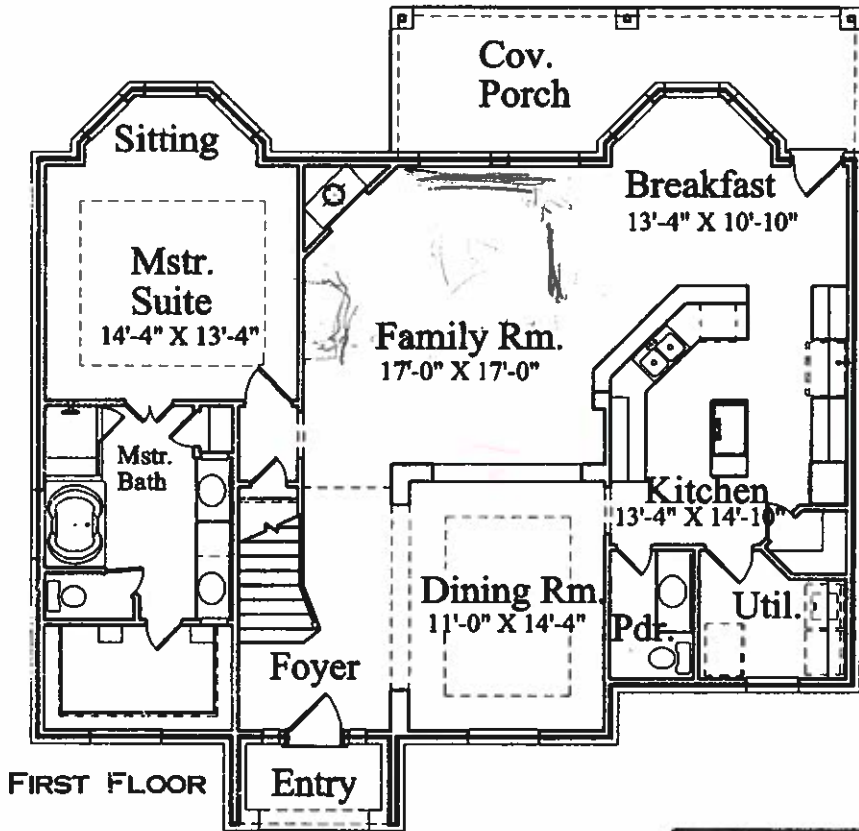

PLAN SHOWN IS AN ARTIST'S CONCEPT. MEASUREMENTS, DETAILS, AND FEATURES ARE APPROXIMATE AND ARE SUBJECT TO CHANGE WITHOUT NOTICE. CONSULT YOUR SALES COUNSELOR FOR EXACT SPECIFICATIONS.



## *Estate Series Design Features*

### *Interior Features*

- Choice of 12"-18" Decorator Ceramic Tile Floors in Foyer, Kitchen, Breakfast Area, Baths, Utility, & Powder Room
- 5yr Wear Dated carpet with ½"pad
- Fireplace includes mantle, brick surround/hearth & gas lighter
- Smooth round sheetrock corners except windows
- Décor rocker light switches
- Stained handrails per plan
- Crown & Chair rail molding in choice of 2 rooms
- Cat 5 phone outlets, high tech
- RG 6 cable outlets, high tech
- Décor raised 4-panel doors
- **Satin Nickel** lever door handles
- **Satin Nickel** Custom lighting
- **Satin Nickel** 5-blade reversible 52" ceiling fans with light kits in family room and master bedroom
- Powder rooms have **MOEN Monticello Platinum** fixtures, elongated commodes, & pedestal sink
- All living rooms & bedrooms wired and blocked for lighted ceiling fans
- Closets feature wood shelves & stained continuous wood rods
- Full State-of-the-art security system with one keypad
- Interconnected smoke detectors in all bedrooms and common areas

### *Kitchen*

- Beautiful Oak or Maple Cabinets with 42" uppers, choice of stains, and adjustable shelving
- Spacious pantry
- Ceramic or Porcelain Tile floors in Kitchen, Breakfast Room, Pantry and Utility Room

- **Whirlpool** built-in upgrade appliances with choice of white on white, black on black, or optional stainless.
- **Granite or Silestone** Countertops with full bullnose edges
- Ceramic tile backsplash
- **Three Bowl** Under mount Stainless Steel Sink, Per Plan
- Stylish **MOEN** chrome long-reach, extra height faucet w/integrated pullout wand
- Ice Maker water supply connection

### *Master Suite*

- Raised Ceilings to 9' or 10' per plan
- Separate sitting area (most plans)
- Large Walk-in Closet(s)
- Separate Shower with Cultured Marble surround & glass enclosure per plan
- **Jacuzzi** Tub with Jets, cultured marble skirt & surround
- Hand laid ceramic tile floor in bathroom
- Matching wood medicine cabinets
- **MOEN Monticello Platinum** fixtures
- Temperature controlled safety shower water valves
- Wide rim oval cultured marble vanity tops with choice of colors
- Elongated commode

### *Hall Bathroom Features*

- Choice of Maple or Oak cabinet with choice of stain colors
- **MOEN Chateau** chrome fixtures
- Cultured marble vanity tops with choice of colors
- Ceramic Tile tub/shower surrounds with choice of colors

*See reverse for additional features.* Feature list subject to change without notice. Page 2 of 2  
10/10/2006

# *Estate Series Design Features*

## *Protecting Your Investment*

- **10 year structural insurance backed warranty coverage from StrucSure Home Warranty Corporation**
- **First Year Workmanship/Materials Warranty provided by Dunn & Stone Builders, LLC**
- **Two Year Delivery Systems Warranty Provided by Dunn & Stone Builders, LLC**
- All warranties in writing
- Easy 1-call warranty service
- Complete inspections throughout construction including 5 engineering & quality inspections by independent inspector
- **Dunn & Stone homes meet or exceed Energy Star requirements**
- Your home built the way you want it vs. what the builder prefers

## *Energy Conservation*

- **RUUD 14+Seer Super High Efficiency Air Conditioner & High Efficiency forced air gas furnace**
- **VANGUARD MANABLOC Fresh Water Distribution System with 10yr total system warranty**
- **Natural Gas 50 gallon Quick Recovery hot water heater or two 40 gallon water heaters per plan**
- All exterior wall and attic mounted water pipes insulated
- **Low E metallic coated, UV resistant, double pane windows with TRU SEAL Swiggle-Seal system provides 80% more condensate resistance. Enameled aluminum frames with choice of 3 colors**
- **Tech Shield radiant barrier foil backed roof decking**
- **R-30 Fiberglass Blown Insulation in ceilings**

- **R-19 Fiberglass Batt Insulation in sloped ceilings**
- **R-13 Fiberglass Batt Insulation in exterior walls + R-3 Foil foam sheathing behind masonry areas**
- **Poly-Foam sealant applied at windows and exterior wall openings**
- **Sill seal used under door thresholds**
- **3-way high efficiency attic ventilation includes ridge vents, air hawks, & continuous soffit vents**

## *Exterior/Construction*

- Full light atrium style rear doors
- Decorator lights at front & rear entries
- Architecturally appealing combination of Stone, Brick, & Siding on front elevations (Per Plan)
- Individually engineered **Post-Tension Steel Reinforced** foundations
- Custom fitted construction – No pre-fabricated sections
- All wall framing on 16" centers
- 2<sup>nd</sup> Story floors on 2 X 12 joists set 16" centers
- Sub-floor on 2-stories is 1 1/8" tongue & groove, glued and screw shank nailed
- **Treated sill plates**
- **James Hardi 50yr exterior trim including lap siding, soffit, & fascia**
- **CertainTeed Landmark 30 year dimensional shingles**
- Large covered rear porch-most plans
- Garage wired for door opener(s)
- 3-exterior hose bibs
- **Decorative Steel Garage Doors**
- All Copper interior wiring