

Building Sketch (Page - 1)

Borrower					
Property Address	12411 Colt Ct				
City	Magnolia	County	Montgomery	State	TX
				Zip Code	77354
Lender/Client					

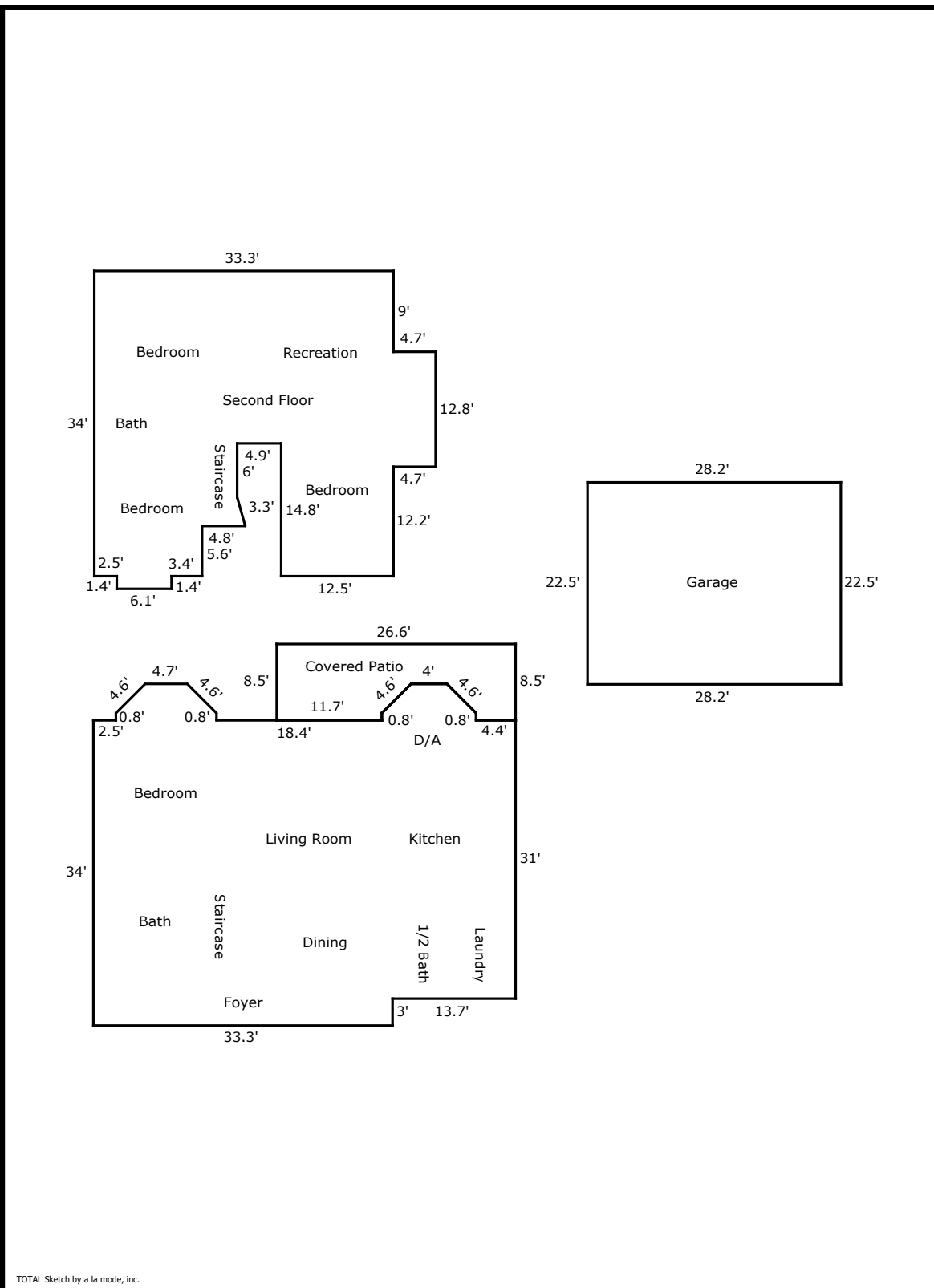

Building Sketch (Page - 2)

Borrower					
Property Address	12411 Colt Ct				
City	Magnolia	County	Montgomery	State	TX
				Zip Code	77354
Lender/Client					

TOTAL Sketch by a la mode, inc.

Area Calculations Summary

Living Area	Calculation Details																													
<table style="width: 100%; border-collapse: collapse;"> <tr> <td style="width: 40%;">First Floor</td> <td style="width: 20%; text-align: center;">1623.7 Sq ft</td> <td style="width: 40%;"></td> </tr> <tr> <td style="vertical-align: top;">Second Floor</td> <td style="text-align: center;">1108 Sq ft</td> <td></td> </tr> <tr> <td colspan="2">Total Living Area (Rounded):</td> <td style="text-align: center;">2732 Sq ft</td> </tr> </table>	First Floor	1623.7 Sq ft		Second Floor	1108 Sq ft		Total Living Area (Rounded):		2732 Sq ft	<table style="width: 100%; border-collapse: collapse;"> <tr> <td style="width: 60%;"></td> <td style="width: 40%; text-align: right;"> $33.3 \times 3 = 99.9$ $47 \times 31 = 1457$ $10.5 \times 0.8 = 8.4$ $0.5 \times 3.3 \times 3.3 = 5.3$ $0.5 \times 3.3 \times 3.2 = 5.3$ $4 \times 3.3 = 13$ $11.2 \times 0.8 = 9$ $0.5 \times 3.3 \times 3.3 = 5.3$ $0.5 \times 3.3 \times 3.3 = 5.3$ $4.7 \times 3.3 = 15.3$ </td> </tr> <tr> <td style="vertical-align: top;"> <table style="width: 100%; border-collapse: collapse;"> <tr> <td style="width: 60%;"></td> <td style="width: 40%; text-align: right;"> $6.1 \times 1.4 = 8.5$ $12.8 \times 4.7 = 60.2$ $33.3 \times 19.2 = 639.4$ $14.8 \times 12.5 = 185$ $14.8 \times 12 = 177.6$ $9.2 \times 3.9 = 35.9$ $0.5 \times 3.2 \times 0.9 = 1.4$ </td> </tr> </table> </td> <td style="vertical-align: top;"> <table style="width: 100%; border-collapse: collapse;"> <tr> <td style="width: 60%;"></td> <td style="width: 40%; text-align: right;"> $28.2 \times 22.5 = 634.5$ </td> </tr> <tr> <td style="vertical-align: top;">Non-living Area</td> <td></td> </tr> <tr> <td style="vertical-align: top;"> <table style="width: 100%; border-collapse: collapse;"> <tr> <td style="width: 40%;">3 Car Garage</td> <td style="width: 20%; text-align: center;">634.5 Sq ft</td> <td style="width: 40%;"></td> </tr> <tr> <td style="vertical-align: top;">Covered Patio</td> <td style="text-align: center;">194.1 Sq ft</td> <td></td> </tr> </table> </td> <td style="vertical-align: top;"> <table style="width: 100%; border-collapse: collapse;"> <tr> <td style="width: 60%;"></td> <td style="width: 40%; text-align: right;"> $26.6 \times 4.4 = 118.3$ $4.1 \times 11.7 = 47.4$ $0.5 \times 3.3 \times 3.3 = 5.3$ $4.1 \times 4.4 = 17.8$ $0.5 \times 3.3 \times 3.2 = 5.3$ </td> </tr> </table> </td> </tr> </table></td></tr></table>		$33.3 \times 3 = 99.9$ $47 \times 31 = 1457$ $10.5 \times 0.8 = 8.4$ $0.5 \times 3.3 \times 3.3 = 5.3$ $0.5 \times 3.3 \times 3.2 = 5.3$ $4 \times 3.3 = 13$ $11.2 \times 0.8 = 9$ $0.5 \times 3.3 \times 3.3 = 5.3$ $0.5 \times 3.3 \times 3.3 = 5.3$ $4.7 \times 3.3 = 15.3$	<table style="width: 100%; border-collapse: collapse;"> <tr> <td style="width: 60%;"></td> <td style="width: 40%; text-align: right;"> $6.1 \times 1.4 = 8.5$ $12.8 \times 4.7 = 60.2$ $33.3 \times 19.2 = 639.4$ $14.8 \times 12.5 = 185$ $14.8 \times 12 = 177.6$ $9.2 \times 3.9 = 35.9$ $0.5 \times 3.2 \times 0.9 = 1.4$ </td> </tr> </table>		$6.1 \times 1.4 = 8.5$ $12.8 \times 4.7 = 60.2$ $33.3 \times 19.2 = 639.4$ $14.8 \times 12.5 = 185$ $14.8 \times 12 = 177.6$ $9.2 \times 3.9 = 35.9$ $0.5 \times 3.2 \times 0.9 = 1.4$	<table style="width: 100%; border-collapse: collapse;"> <tr> <td style="width: 60%;"></td> <td style="width: 40%; text-align: right;"> $28.2 \times 22.5 = 634.5$ </td> </tr> <tr> <td style="vertical-align: top;">Non-living Area</td> <td></td> </tr> <tr> <td style="vertical-align: top;"> <table style="width: 100%; border-collapse: collapse;"> <tr> <td style="width: 40%;">3 Car Garage</td> <td style="width: 20%; text-align: center;">634.5 Sq ft</td> <td style="width: 40%;"></td> </tr> <tr> <td style="vertical-align: top;">Covered Patio</td> <td style="text-align: center;">194.1 Sq ft</td> <td></td> </tr> </table> </td> <td style="vertical-align: top;"> <table style="width: 100%; border-collapse: collapse;"> <tr> <td style="width: 60%;"></td> <td style="width: 40%; text-align: right;"> $26.6 \times 4.4 = 118.3$ $4.1 \times 11.7 = 47.4$ $0.5 \times 3.3 \times 3.3 = 5.3$ $4.1 \times 4.4 = 17.8$ $0.5 \times 3.3 \times 3.2 = 5.3$ </td> </tr> </table> </td> </tr> </table>		$28.2 \times 22.5 = 634.5$	Non-living Area		<table style="width: 100%; border-collapse: collapse;"> <tr> <td style="width: 40%;">3 Car Garage</td> <td style="width: 20%; text-align: center;">634.5 Sq ft</td> <td style="width: 40%;"></td> </tr> <tr> <td style="vertical-align: top;">Covered Patio</td> <td style="text-align: center;">194.1 Sq ft</td> <td></td> </tr> </table>	3 Car Garage	634.5 Sq ft		Covered Patio	194.1 Sq ft		<table style="width: 100%; border-collapse: collapse;"> <tr> <td style="width: 60%;"></td> <td style="width: 40%; text-align: right;"> $26.6 \times 4.4 = 118.3$ $4.1 \times 11.7 = 47.4$ $0.5 \times 3.3 \times 3.3 = 5.3$ $4.1 \times 4.4 = 17.8$ $0.5 \times 3.3 \times 3.2 = 5.3$ </td> </tr> </table>		$26.6 \times 4.4 = 118.3$ $4.1 \times 11.7 = 47.4$ $0.5 \times 3.3 \times 3.3 = 5.3$ $4.1 \times 4.4 = 17.8$ $0.5 \times 3.3 \times 3.2 = 5.3$
First Floor	1623.7 Sq ft																													
Second Floor	1108 Sq ft																													
Total Living Area (Rounded):		2732 Sq ft																												
	$33.3 \times 3 = 99.9$ $47 \times 31 = 1457$ $10.5 \times 0.8 = 8.4$ $0.5 \times 3.3 \times 3.3 = 5.3$ $0.5 \times 3.3 \times 3.2 = 5.3$ $4 \times 3.3 = 13$ $11.2 \times 0.8 = 9$ $0.5 \times 3.3 \times 3.3 = 5.3$ $0.5 \times 3.3 \times 3.3 = 5.3$ $4.7 \times 3.3 = 15.3$																													
<table style="width: 100%; border-collapse: collapse;"> <tr> <td style="width: 60%;"></td> <td style="width: 40%; text-align: right;"> $6.1 \times 1.4 = 8.5$ $12.8 \times 4.7 = 60.2$ $33.3 \times 19.2 = 639.4$ $14.8 \times 12.5 = 185$ $14.8 \times 12 = 177.6$ $9.2 \times 3.9 = 35.9$ $0.5 \times 3.2 \times 0.9 = 1.4$ </td> </tr> </table>		$6.1 \times 1.4 = 8.5$ $12.8 \times 4.7 = 60.2$ $33.3 \times 19.2 = 639.4$ $14.8 \times 12.5 = 185$ $14.8 \times 12 = 177.6$ $9.2 \times 3.9 = 35.9$ $0.5 \times 3.2 \times 0.9 = 1.4$	<table style="width: 100%; border-collapse: collapse;"> <tr> <td style="width: 60%;"></td> <td style="width: 40%; text-align: right;"> $28.2 \times 22.5 = 634.5$ </td> </tr> <tr> <td style="vertical-align: top;">Non-living Area</td> <td></td> </tr> <tr> <td style="vertical-align: top;"> <table style="width: 100%; border-collapse: collapse;"> <tr> <td style="width: 40%;">3 Car Garage</td> <td style="width: 20%; text-align: center;">634.5 Sq ft</td> <td style="width: 40%;"></td> </tr> <tr> <td style="vertical-align: top;">Covered Patio</td> <td style="text-align: center;">194.1 Sq ft</td> <td></td> </tr> </table> </td> <td style="vertical-align: top;"> <table style="width: 100%; border-collapse: collapse;"> <tr> <td style="width: 60%;"></td> <td style="width: 40%; text-align: right;"> $26.6 \times 4.4 = 118.3$ $4.1 \times 11.7 = 47.4$ $0.5 \times 3.3 \times 3.3 = 5.3$ $4.1 \times 4.4 = 17.8$ $0.5 \times 3.3 \times 3.2 = 5.3$ </td> </tr> </table> </td> </tr> </table>		$28.2 \times 22.5 = 634.5$	Non-living Area		<table style="width: 100%; border-collapse: collapse;"> <tr> <td style="width: 40%;">3 Car Garage</td> <td style="width: 20%; text-align: center;">634.5 Sq ft</td> <td style="width: 40%;"></td> </tr> <tr> <td style="vertical-align: top;">Covered Patio</td> <td style="text-align: center;">194.1 Sq ft</td> <td></td> </tr> </table>	3 Car Garage	634.5 Sq ft		Covered Patio	194.1 Sq ft		<table style="width: 100%; border-collapse: collapse;"> <tr> <td style="width: 60%;"></td> <td style="width: 40%; text-align: right;"> $26.6 \times 4.4 = 118.3$ $4.1 \times 11.7 = 47.4$ $0.5 \times 3.3 \times 3.3 = 5.3$ $4.1 \times 4.4 = 17.8$ $0.5 \times 3.3 \times 3.2 = 5.3$ </td> </tr> </table>		$26.6 \times 4.4 = 118.3$ $4.1 \times 11.7 = 47.4$ $0.5 \times 3.3 \times 3.3 = 5.3$ $4.1 \times 4.4 = 17.8$ $0.5 \times 3.3 \times 3.2 = 5.3$													
	$6.1 \times 1.4 = 8.5$ $12.8 \times 4.7 = 60.2$ $33.3 \times 19.2 = 639.4$ $14.8 \times 12.5 = 185$ $14.8 \times 12 = 177.6$ $9.2 \times 3.9 = 35.9$ $0.5 \times 3.2 \times 0.9 = 1.4$																													
	$28.2 \times 22.5 = 634.5$																													
Non-living Area																														
<table style="width: 100%; border-collapse: collapse;"> <tr> <td style="width: 40%;">3 Car Garage</td> <td style="width: 20%; text-align: center;">634.5 Sq ft</td> <td style="width: 40%;"></td> </tr> <tr> <td style="vertical-align: top;">Covered Patio</td> <td style="text-align: center;">194.1 Sq ft</td> <td></td> </tr> </table>	3 Car Garage	634.5 Sq ft		Covered Patio	194.1 Sq ft		<table style="width: 100%; border-collapse: collapse;"> <tr> <td style="width: 60%;"></td> <td style="width: 40%; text-align: right;"> $26.6 \times 4.4 = 118.3$ $4.1 \times 11.7 = 47.4$ $0.5 \times 3.3 \times 3.3 = 5.3$ $4.1 \times 4.4 = 17.8$ $0.5 \times 3.3 \times 3.2 = 5.3$ </td> </tr> </table>		$26.6 \times 4.4 = 118.3$ $4.1 \times 11.7 = 47.4$ $0.5 \times 3.3 \times 3.3 = 5.3$ $4.1 \times 4.4 = 17.8$ $0.5 \times 3.3 \times 3.2 = 5.3$																					
3 Car Garage	634.5 Sq ft																													
Covered Patio	194.1 Sq ft																													
	$26.6 \times 4.4 = 118.3$ $4.1 \times 11.7 = 47.4$ $0.5 \times 3.3 \times 3.3 = 5.3$ $4.1 \times 4.4 = 17.8$ $0.5 \times 3.3 \times 3.2 = 5.3$																													