

LEGEND:

- | | |
|-------------------------------------|------------------------------|
| A.E.=AERIAL EASEMENT | U.E.=UTILITY EASEMENT |
| B.L.=BUILDING LINE | U.T.S.=UNABLE TO SET |
| BRS=BEARS | R.O.W.=RIGHT-OF-WAY |
| C.F. NO.=COUNTY CLERK'S FILE NUMBER | S.C.I.R.=SET CAPPED IRON ROD |
| C.I.R.=CAPPED IRON ROD | SP=SERVICE POLL |
| C.M.=CONTROL MONUMENT | |
| D.R.=COUNTY DEED RECORDS | |
| ESMT=EASEMENT | |
| FC=FENCE CORNER | WOOD FENCE |
| F.C.I.R.=FOUND CAPPED IRON ROD | CHAINLINK FENCE |
| F.I.P.=FOUND IRON PIPE | WROUGHT IRON FENCE |
| F.I.R.=FOUND IRON ROD | BARB WIRE FENCE |
| FNC=FENCE | SUBJECT TRACT |
| GM=GAS METER | ADJOINING PROPERTY |
| I.R.=IRON ROD | |
| IST=INSIDE SUBJECT TRACT | |
| M.R.=HARRIS COUNTY MAP RECORDS | |
| O.S.T.=OUTSIDE SUBJECT TRACT | |
| PP=POWER POLE | |
| P.R.=PLAT RECORDS | |
| P.T.P.=PINCHED TOP PIPE | |

NOTES:

- Survey bases on the best field evidence found.
- Property subject to other subdivision covenants, conditions & restrictions be easements, building lines and other matters of record.

ABSTRACTING NOTE:

Survey was performed without the benefit of a current Title Report at the client's request. There may be other easements and encumbrances that affect Subject property that are not shown

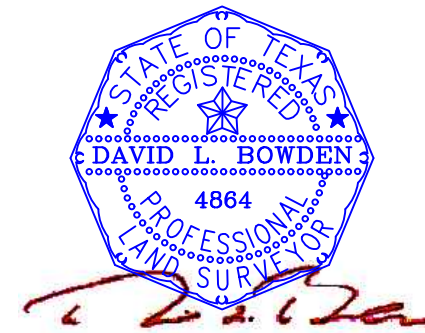

BOUNDARY SURVEY
 BEING 0.5739 ACRES OF LAND (25,000.00 SQ.FT.)
 SITUATED IN THE STATE OF TEXAS, OF POLK COUNTY, A PART OF BIG THICKET LAKE ESTATES, SECTION 8, LOTS 153 - 156, RECORDED IN VOLUME 3, PAGE 10, P.C.M.R.

Date: 07/19/2022
 Field Work: RG
 Drawn By: MAL
 Project No.: R2022-010

Project Location:
 0 Josephine Rd,
 Livingston, TX 77351

FLOOD DATA
 THIS PROPERTY IS NOT IN THE 100 YEAR FLOOD ZONE, IS IN ZONE X PER FIRM MAP, COMMUNITY PANEL No. 48373C0700C WHICH HAS AN EFFECTIVE DATE OF 09/03/2010, AND IS NOT IN THE SPECIAL FLOOD HAZARD AREA.

Bowden Survey
 Professional Surveying Services
 12000 WESTHEIMER RD. STE. 106
 Houston, Texas 77077
 Phone: (281) 531-1900 Fax: (281) 531-4900

TBPLS Firm Registration No. 10127400

© COPYRIGHT 2022 BOWDEN SURVEY CO.
 SURVEY is good for this transaction only.
 Copying or unauthorized use of this SURVEY not only violates federal and state copyright laws, punishable by CIVIL and CRIMINAL sanctions, but is OUTRIGHT THEFT and harms Bowden Survey Co.'s livelihood. Please don't do it.