

Handwritten notes:
 all + correct
 changes

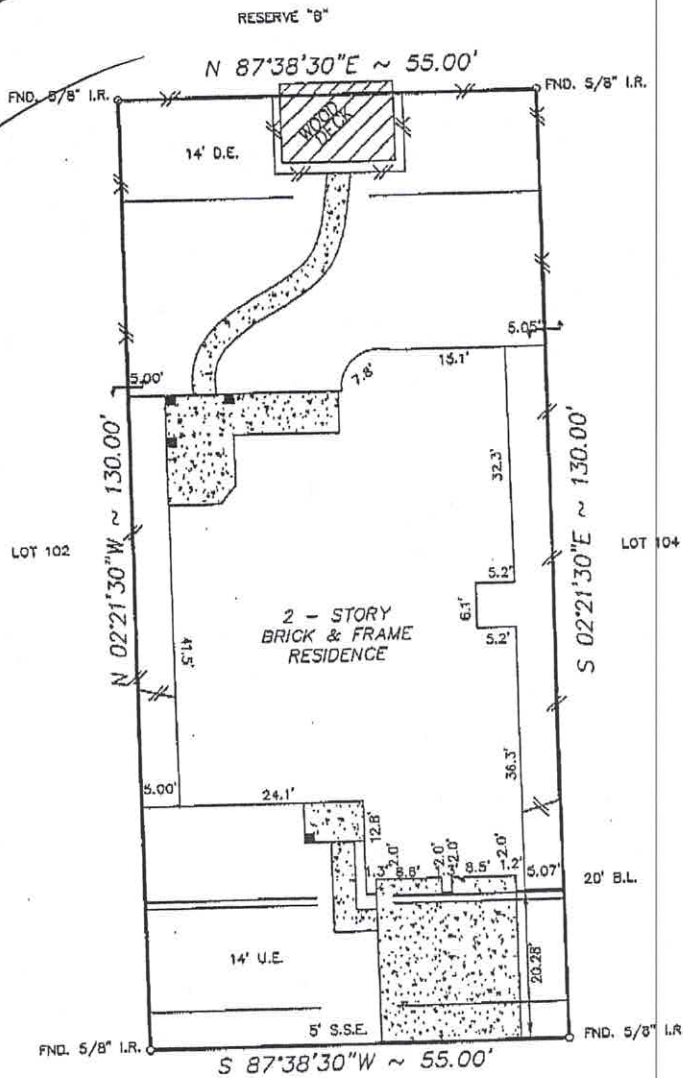

18130 BILLABONG CRESCENT COURT
 (50' R.O.W.)

- NOTE:
1. Distances shown in parentheses were measured on the ground.
 2. The following flood information was from a F.E.M.A. Map. We are not responsible for its accuracy.

COMMUNITY # 480287 PANEL # 0405 J

NOTES:

1. OIL, GAS, & OTHER MINERAL RIGHTS AS PER TITLE COMMITMENT.
2. BLANKET EASEMENTS FOR GAS AND ELECTRIC UTILITIES RECORDED C.F. NO. X-417642, R.P.R.O.H.C.

DATE OF REVISION 11/06/96
 (OUTSIDE THE 100 YEAR FLOOD PLAIN)

SCALE : 1"=20'

RT./FINALS/SH1030401

Surveyed for LEGEND HOMES on 11/23/04
 Showing Lot 103 Block 4 of SYDNEY HARBOUR
 Section 1 in HARRIS County Texas according to the Map or Plat
 recorded in F.C. NO. 545074 of the MAP records of HARRIS County.

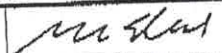
REVISIONS	
03/04/05	FINAL
03/31/05	UPDATE
W.O. No. 24184, 25125	
G.F. No. 0570065	
	



Buyer: ADAM A. AL-ALMRA
EMAN S. IBRAHIM
 Mortgage Co.: NETWORK FUNDING
 Title Company: STEWART TITLE

Hoffman Land Surveying, Ltd., LLP
 5245 LANGFIELD ROAD - HOUSTON, TEXAS 77040 - (713)939-9100

